



BROOKLANDS LANE,

Weybridge KT13



# PRESENTING THIS PRACTICAL HOME

Characterful Victorian cottage in a secluded lane, steps from Weybridge's shops, station and sought-after schools

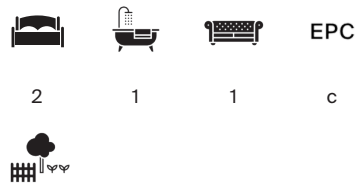

Local Authority: Elmbridge Borough Council

Council Tax band: D

Furniture: Unfurnished

Minimum length of tenancy: 12 months

Deposit amount: £2,076.92

Available date: Now

**Guide price: £1,800 per month**



## BEAUTIFULLY PRESENTED

Nestled at the end of a charming private lane, Brooklands Lane is a delightful two-bedroom Victorian cottage dating back to the 1850s, beautifully presented and benefiting from double glazing throughout.

Ideally located, the home is just a short walk from Weybridge High Street and Weybridge Train Station, offering superb convenience for commuters and local amenities alike.







## CHARACTERFUL PROPERTY

This characterful property enjoys a peaceful position in a tucked-away corner of Weybridge, yet remains close to the vibrant village center with its excellent array of shops, cafés, restaurants, and everyday conveniences, including Waitrose.

The scenic River Thames and the village cricket green are also within easy reach, along with the popular Queens Road area known for its boutique shopping and dining options.

Families will appreciate the strong selection of local schooling. Heathside Secondary School is approximately 200 yards from the property, with other well-regarded schools nearby such as St James' Primary and Cleves Primary.



## LOCATION

Weybridge offers a wealth of leisure facilities, including two major health clubs—Weybridge Health and David Lloyd—along with St George’s Hill Tennis and Golf Clubs and Burhill Golf Club. Local attractions such as Mercedes-Benz World and Brooklands Museum further enhance the area’s appeal.

The property provides excellent transport links. The A3, M25 and M3 are all easily accessible, and local bus routes offer direct connections to Walton-on-Thames, Hersham, Kingston and Guildford. Weybridge train station, located on the edge of town, provides regular services to London Waterloo, while Heathrow and Gatwick airports can be reached via the M25.







# Brooklands Lane, KT13

Approximate Gross Internal Area = 56.8 sq m / 612 sq ft

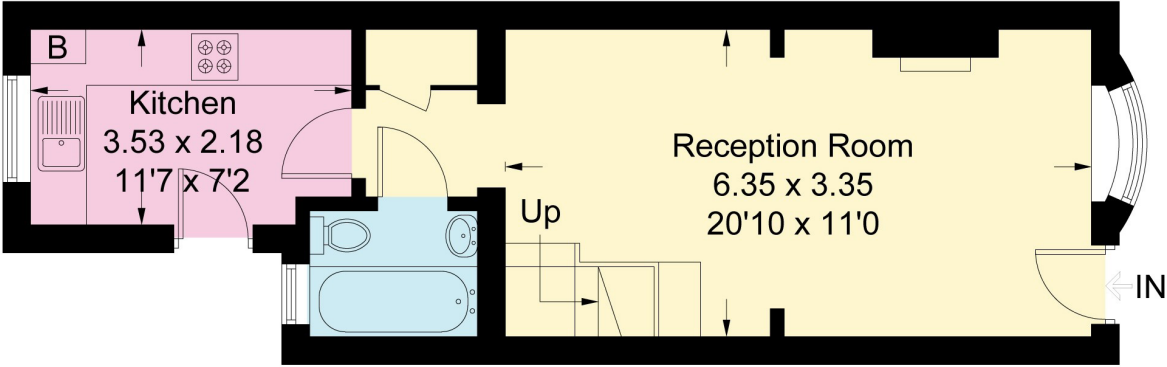

**Ground Floor**

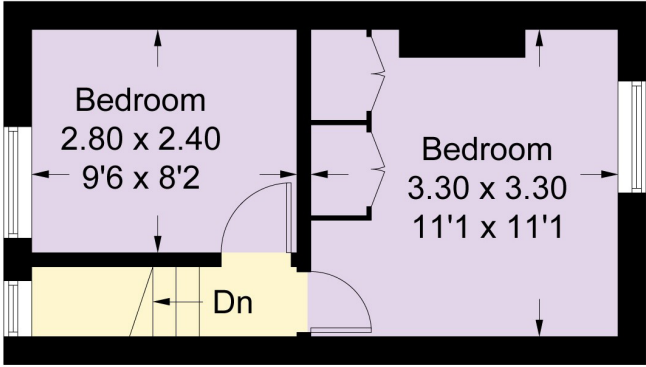

**First Floor**

(Including Basement / Loft Room)  
Approximate Gross Internal Area = 612 sq ft

This plan is for layout guidance only. Not drawn to scale unless stated. Windows and door openings are approximate. Whilst every care is taken in the preparation of this plan, please check all dimensions, shapes and compass bearings before making any decisions reliant upon them. (ID767266)

We would be delighted  
to tell you more.

**Angharad Lonnon**

013 7223 0468

[angharad.lonnon@knightfrank.com](mailto:angharad.lonnon@knightfrank.com)

**Knight Frank Esher**

47 High St,

Esher KT10 9RL

Your partners in property

[knightfrank.co.uk](https://knightfrank.co.uk)

1. Particulars: These particulars are not an offer or contract, nor part of one. You should not rely on statements given by Knight Frank in the particulars, by word of mouth or in writing ("information") as being factually accurate about the property, its condition or its value. Neither Knight Frank nor any joint agent has any authority to make any representations about the property, and accordingly any information given is entirely without responsibility on the part of Knight Frank. 2. Material Information: Please note that the material information above is provided to Knight Frank by third parties and is provided here as a guide only. Some of the information provided (such as the rent, deposit or length of tenancy) is subject to change, depending on offers received by the landlord. While Knight Frank has taken steps to verify this information, we advise you to confirm the details of any such material information prior to any offer for the tenancy being submitted. If we are informed of changes to this information by the landlord, we will use reasonable endeavours to update this as soon as practical. 3. Photos, Videos etc: The photographs, property videos and virtual viewings etc. show only certain parts of the property as they appeared at the time they were taken. Areas, measurements and distances given are approximate only. 4. Fixtures and fittings: Carpets, curtains, light fittings and other items fixed to the property (and not fixed to the property) belonging to the landlord are included in any tenancy as evidenced in the inventory, unless specifically noted otherwise. All those items regarded as tenant's fixtures and fittings, are specifically excluded from any tenancy and will not be evidenced in the inventory. 5. Deposit: All potential tenants should be advised that, as well as rent a holding deposit will be payable which is equal to one week's rent (if an AST) and two weeks' rent (if not an AST), a tenancy deposit will also be payable which is equal to 6 weeks rent (if not an AST and/or the annual rent is over £50,000), or 5 weeks' rent (if an AST and/or the annual rent is below £50,000). If the landlord agrees to you having a pet you may be required to pay a higher deposit (if not an AST) or higher weekly rent (if an AST). An administration fee of £288 and referencing fees of £60 per person will also apply when renting a property (if not an AST). (All fees shown are inclusive of VAT.) For other fees that might apply, please ask us or visit [www.knightfrank.co.uk/tenantfees](http://www.knightfrank.co.uk/tenantfees). 6. To find out how we process Personal Data, please refer to our Group Privacy Statement and other notices at <https://www.knightfrank.com/legals/privacy-statement>.

Particulars dated May 2024. Photographs and videos dated March 2024. All information is correct at the time of going to print. Knight Frank is the trading name of Knight Frank LLP. Knight Frank LLP is a limited liability partnership registered in England and Wales with registered number OC305934. Our registered office is at 55 Baker Street, London W1U 8AN. We use the term 'partner' to refer to a member of Knight Frank LLP, or an employee or consultant. A list of members names of Knight Frank LLP may be inspected at our registered office. If you do not want us to contact you further about our services then please contact us by either calling 020 3544 0692, email to [marketing.help@knightfrank.com](mailto:marketing.help@knightfrank.com) or post to our UK Residential Marketing Manager at our registered office (above) providing your name and address.