

HUNTERS[®]

HERE TO GET *you* THERE



Bellingham Close

, Thirsk, YO7 1FX

£725 Per Month



Council Tax: B

Floor Plan

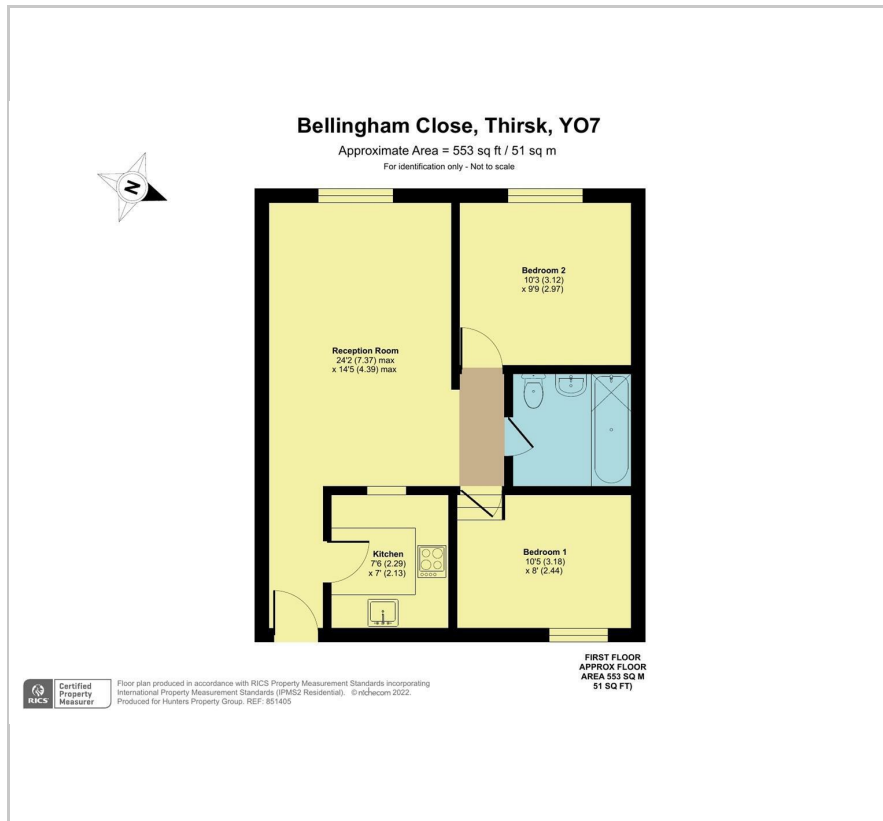

Area Map



Energy Efficiency Graph

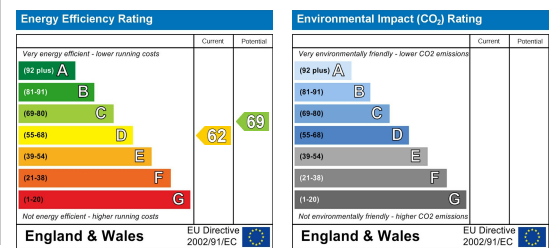

Viewing

Please contact our Hunters Thirsk Lettings Office on 01845 440044 if you wish to arrange a viewing appointment for this property or require further information.

- **T W O B E D R O O M** ▪ **FIRST FLOOR APARTMENT**
- **WALKING DISTANCE TO TOWN** ▪ **ALLOCATED PARKING SPACE**
- **SORRY NO PETS** ▪ **AVAILABLE MID-OCTOBER 2023**

A well-proportioned two bedroom first floor apartment within walking distance to Thirsk market place. The accommodation briefly comprises; entrance hall, lounge, kitchen, two good sized bedrooms and bathroom. The apartment has a light and airy feel, with high ceilings and generous proportions. The property benefits from attractive communal gardens a dedicated parking space and visitor parking.



MATERIAL INFORMATION

Tenure:
Lease Years Remaining:
Annual Ground Rent:
Review Period:
Review Increase:
Service Charge:
Shared Ownership:
Ownership Share:

These particulars are intended to give a fair and reliable description of the property but no responsibility for any inaccuracy or error can be accepted and do not constitute an offer or contract. We have not tested any services or appliances (including central heating if fitted) referred to in these particulars and the purchasers are advised to satisfy themselves as to the working order and condition. If a property is unoccupied at any time there may be reconnection charges for any switched off/disconnected or drained services or appliances - All measurements are approximate. **THINKING OF SELLING?** If you are thinking of selling your home or just curious to discover the value of your property, Hunters would be pleased to provide free, no obligation sales and marketing advice. Even if your home is outside the area covered by our local offices we can arrange a Market Appraisal through our national network of Hunters estate agents.