



**Taylors**



# Hyde Farm Barns The Hyde, Kinver, Nr. Stourbridge DY7 6LS

Guide Price £650,000

🛏 3 🍳 2 🚿 1





Nestled at the end of The Hyde (not Hyde Lane), within an exclusive semi-rural estate, this beautifully converted barn offers a unique blend of character and modern comfort.

Tenure: Freehold. Construction: Conversion. Services: LPG, water and electricity. Broadband/Mobile coverage: Visit: [checker.ofcom.org.uk/en-gb/broadband-coverage](http://checker.ofcom.org.uk/en-gb/broadband-coverage). Council Tax Band D. EPC C.

In detail;

**Reception Hall** - 3.76m x 2.69m (12'4" x 8'10") Average at widest points

**Guests Cloakroom (plus Utility Cupboard - not measured)** - 1.96m x 0.94m (6'5" x 3'1")

**Lounge** - 4.9m x 4.01m (16'1" x 13'2")

**Central Hall** - 2.34m x 1.73m (7'8" x 5'8") At widest points

**Dining Kitchen** - 5.64m x 3.68m (18'6" x 12'1")

**Guests Bedroom / Bedroom Three** - 4.17m x 4.06m (13'8" x 13'4") Minimum from fitted wardrobes

**First Landing** - 3.56m x 2.74m (11'8" x 9'0") At widest points

**Bedroom One** - 4.11m x 3.86m (13'6" x 12'8") At widest points

**Ensuite** - 2.16m x 1.7m (7'1" x 5'7")

**Second Landing (rising from staircase two)** - 2.67m x 2.31m (8'9" x 7'7") At widest points including stair opening

**Bedroom Two (plus Mezzanine - not measured)** - 4.14m x 3.73m (13'7" x 12'3") Minimum from fitted wardrobes

**Shower Room** - 2.31m x 2.01m (7'7" x 6'7")







- Charming three-bedroom barn conversion in a private estate setting
- Multiple garden zones, including an elevated decking area with a bar
- Stylish double-length modern kitchen with quality appliances, skylights and vaulted ceilings
- Stunning countryside views from a huge elevated rear garden
- Spacious lounge with exposed beams and a brick fireplace
- Three well-proportioned double bedrooms, including a master suite with ensuite
- Blend of rustic charm and contemporary features, offering a unique living experience

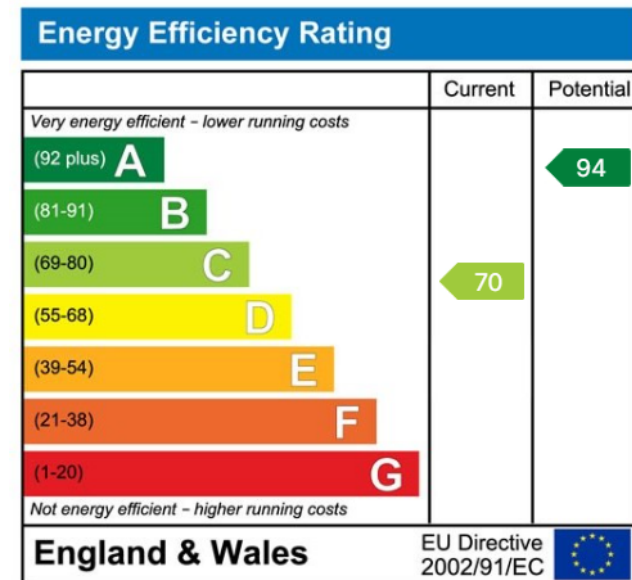
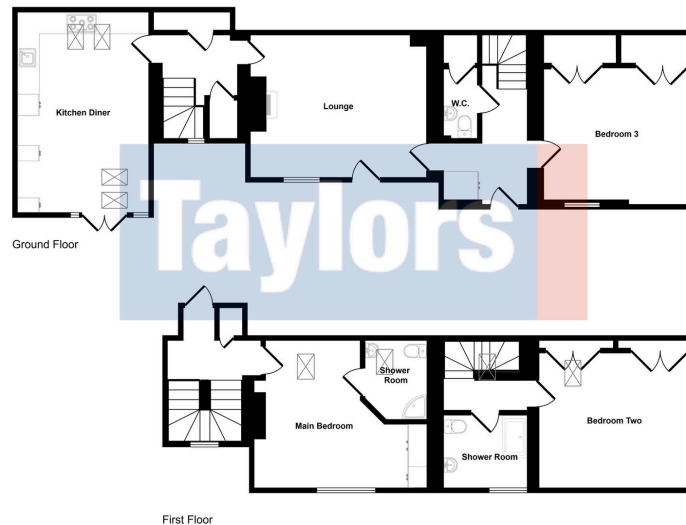

**MISREPRESENTATION ACT 1967:** These particulars do not constitute any part of an offer or a contract. Whilst every care is taken to ensure accuracy, no responsibility for errors or misdescription is accepted. Any intending purchaser must satisfy themselves by inspection or otherwise as to the correctness of each of the statements in these particulars. The vendor does not make nor give, and neither Taylors nor any person in their employment has any authority to make or give any representation or warranty whatsoever about this property. As the seller's estate agents, we are not surveyors or conveyancing experts, and we cannot comment on the property's condition or issues relating to the title or other legal issues that may affect this property unless we have been made aware of such matters. Interested parties should employ professionals to make such enquiries before making transactional decisions. **EPC:** can be supplied free of charge. **CONSUMER PROTECTION REGULATIONS (2008):** These particulars have been prepared with care and approved by the vendors (where possible) but are intended as a guide only, with measurements being approximate and usually the maximum size, which may include alcoves, recesses or otherwise as described, and you must NOT rely on them for any other purpose. The appearance of an item in any photograph does not mean that it forms part of the property or sale price. **FIXTURES AND FITTINGS:** Only those items specifically mentioned in these sales particulars are included in the sale price. Taylors have NOT tested any apparatus, equipment, fixture or fitting and cannot verify they are in working order or fit for their purpose. **PLANNING PERMISSION / BUILDING REGULATIONS:** Any reference to the property being extended, altered or converted in any way does not infer that planning permission or building regulations have been granted or applied for, nor do Taylors accept any responsibility for such not having been obtained. **FLOOR PLAN:** This plan is for illustrative purposes only. The services, systems and appliances shown have not been tested and no guarantee as to their operability or efficiency can be given.