

## Coleridge Crescent, Hemel Hempstead, HP2 7PG

### **£2,000 PCM**

Clements Estate Agents are delighted to market this FULLY REFURBISHED, FOUR bedroom house. Benefiting from new carpets throughout, open-plan living space and driveway parking. The property comprises of a fitted kitchen, downstairs WC, family bathroom and four good size bedrooms. Situated in this sought after Woodhall Farm location, close to local shops and amenities on a quiet residential street. This family home is ready to move into now. Don't miss the chance to make this property your next home. Call to view!

**Living room 19'9" x 18'6" (6.02 x 5.65)**



**WC**



**Kitchen 11'8" x 6'9" (3.56 x 2.06 )**



**Bathroom 7'7" x 5'4" (2.32 x 1.63)**



**Bedroom 4 12'4" x 7'1" (3.76m x 2.16m)**



**Bedroom 2 10'7" x 10'6" (3.23m x 3.20m)**





**Bedroom 1 13'2" x 10'4" (4.01m x 3.15m)**



**Bedroom 3 7'9" x 7'3" (2.36m x 2.21m)**



**Garden**



Floor Plan

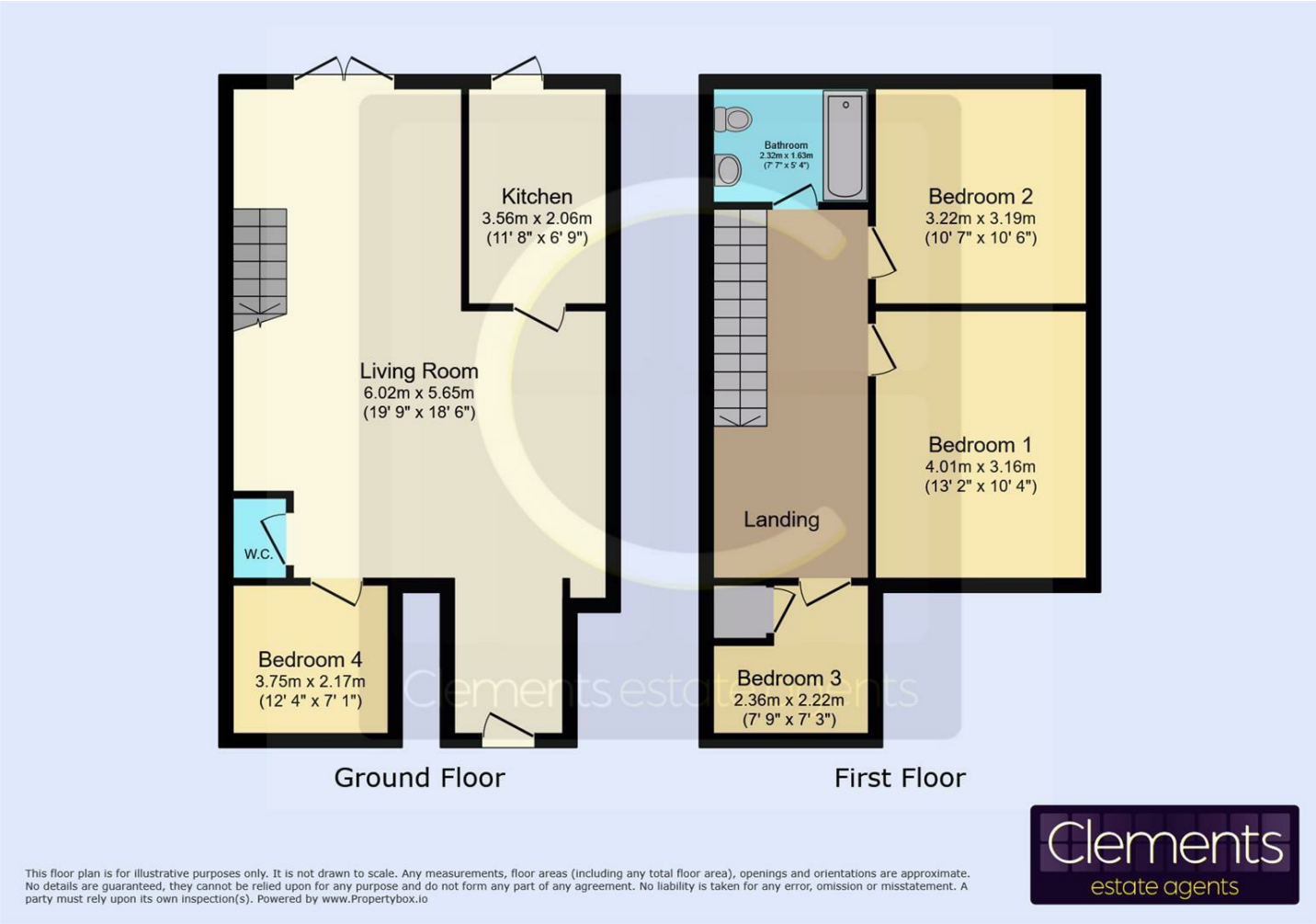

Area Map



Energy Efficiency Graph

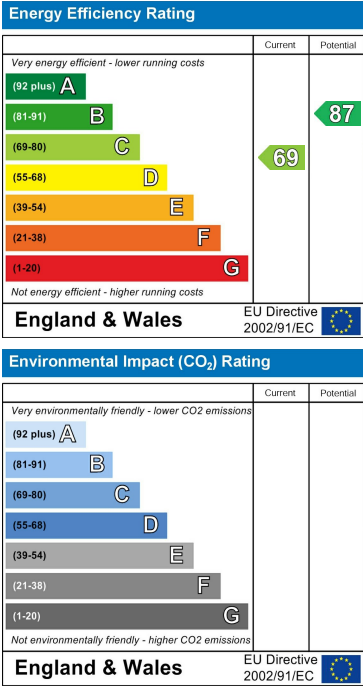

These particulars, whilst believed to be accurate are set out as a general outline only for guidance and do not constitute any part of an offer or contract. Intending purchasers should not rely on them as statements of representation of fact, but must satisfy themselves by inspection or otherwise as to their accuracy. No person in this firm's employment has the authority to make or give any representation or warranty in respect of the property.