

41 Redwing Avenue, Chorlton, Manchester, M21 7JS



JP&Brimelow
ESTATE AGENTS

Offers In The Region Of £415,000

 3  2  1  B

VIDEO TOUR AVAILABLE A delightful and immaculately presented, THREE BEDROOM, modern, semi-detached property. Positioned on this popular residential development off Darley Avenue. Chorlton Water Park and the Chorlton-Cum-Hardy Golf Club are on your doorstep, centrally located for transport links into the City Centre or Manchester Airport by the Metrolink station on Barlow Moor Road. The location is fantastic for both West Didsbury & Chorlton amenities and local primary schools, parks and the motorway network. In brief this well-panned property consists of; an entrance hall, a fully fitted kitchen, a downstairs W.C, a useful under stairs storage cupboard, and a good-sized open plan living/ dining room with views and access out into the rear SOUTH facing garden. Stairs leading to the first-floor landing reveal two useful storage cupboards, two double bedrooms once benefitting from an en-suite shower room, a further bedroom, and a white three-piece bathroom suite completing this fantastic home. Other benefits include; gas fired central heating, an alarm system, solar panels, a driveway providing off road parking for multiple vehicles, and a sizeable south facing rear garden.





EPC Chart

Energy Efficiency Rating		
	Current	Potential
<i>Very energy efficient - lower running costs</i>		
(92 plus) A		
(81-91) B	89	91
(69-80) C		
(55-68) D		
(39-54) E		
(21-38) F		
(1-20) G		
<i>Not energy efficient - higher running costs</i>		
England & Wales	EU Directive 2002/91/EC 	



Tenure: **Leasehold** Council Tax Band: **C**

Ground Floor

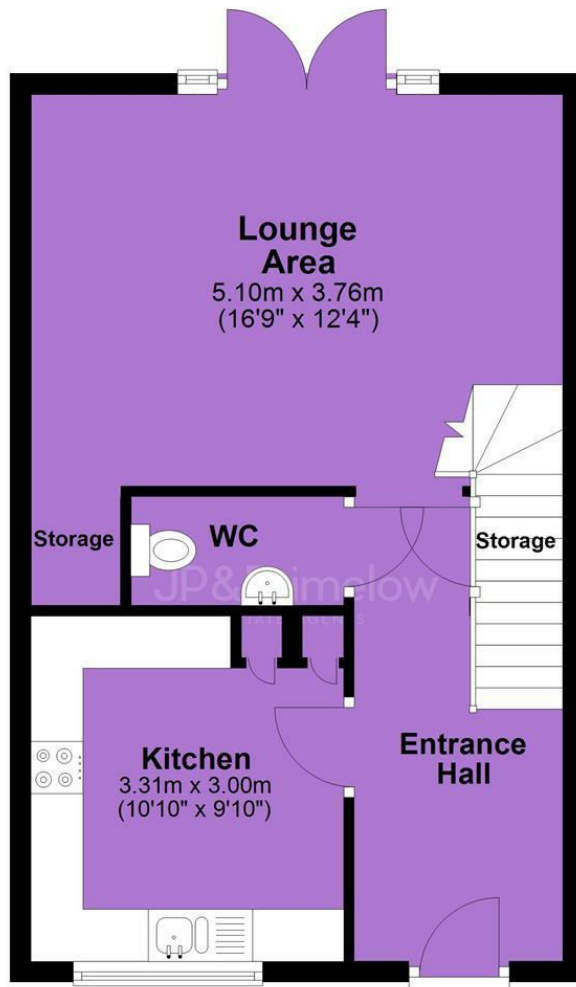

First Floor

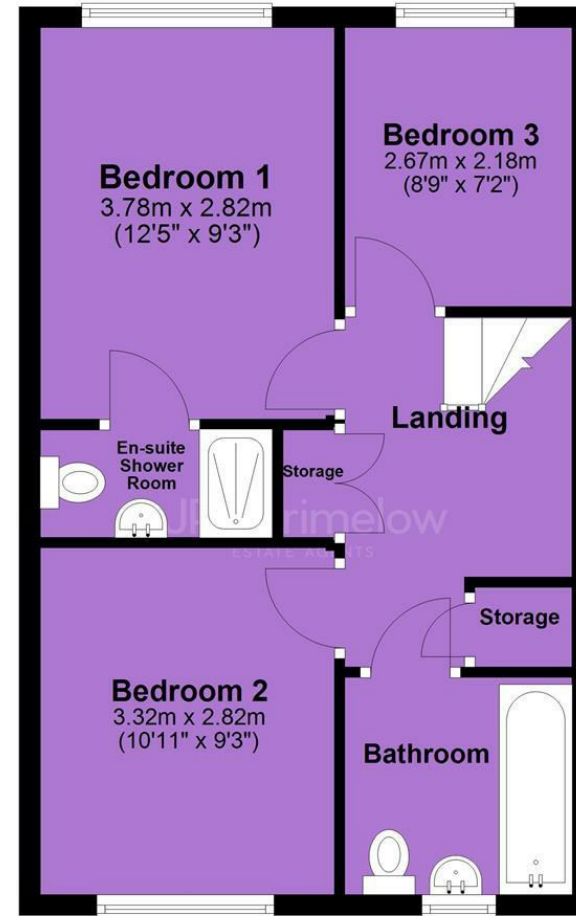

JP & Brimelow Estate Agents Ltd
430 Barlow Moor Road, Manchester, M21 8AD
Tel: 0161 8822233
E: sales@jpbrimelow.co.uk www.jpandbrimelow.co.uk



JP & Brimelow
ESTATE AGENTS

NOTICE: JP & Brimelow Estate Agents Ltd for themselves and for the vendors or lessors of this property whose agents they give notice that:

- (i) the particulars are set out as a general outline only for the guidance of intending purchasers or lessees, and do not constitute, nor constitute part of, an offer or contract;
- (ii) all descriptions, dimensions, references to the condition and necessary permissions for use and occupation, and other details are given in good faith and are believed to be correct but any intending purchasers or tenants should not rely on them as statements or representations of fact but must satisfy themselves by inspection or otherwise as to the correctness of each of them;
- (iii) no person in the employment of JP & Brimelow Estate Agents Ltd has any authority to make or give any representation or warranty whatever in relation to this property.

jpandbrimelowstateagents

@jpandbrimelow