

ALLDAY
& MILLER



Botwell Common Road, Hayes, UB3 1JA
£475,000

2 1 1 D



Botwell Common Road, Hayes, UB3 1JA

£475,000

- Semi Detached Bungalow
- Garage
- Conservatory
- Chain Free
- Private Rear Garden
- Two Bedrooms
- Off Street Parking
- Walking Distance To Town Centre
- Potential To Extend STPP
- Close Proximity To Elizabeth Line Station

Description

A charming two-bedroom bungalow offering comfortable living and fantastic potential, ideally positioned within walking distance of the town centre.

This well-maintained home features two generously sized bedrooms, a fitted kitchen, a bright and spacious reception room, and a conservatory that provides an inviting space to relax and enjoy views of the garden. The property also benefits from a three-piece family bathroom and an attached garage, perfect for storage or secure parking.

Externally, there is off-street parking for multiple vehicles, and the plot offers excellent potential to extend (STPP), making it ideal for buyers looking to add value or tailor the home to their needs.

Located in a convenient and sought-after area, this bungalow provides easy access to local shops, transport links, and all the amenities of the town centre—perfect for downsizers, first-time buyers, or investors alike.

Situation

Bowtell Common Road is a prime location in the heart of Hayes. Hayes & Harlington station just a short minute drive away with the Elizabeth line making the journey into Central London a breeze, along with the bus station with several routes to local amenities. Hayes town centre with its variety of local shops, cafes, takeaways and coffee shops. The area is also served by a number of highly regarded schools including Lake Farm Park Academy and Rosedale Collage secondary school.



Floor Plans

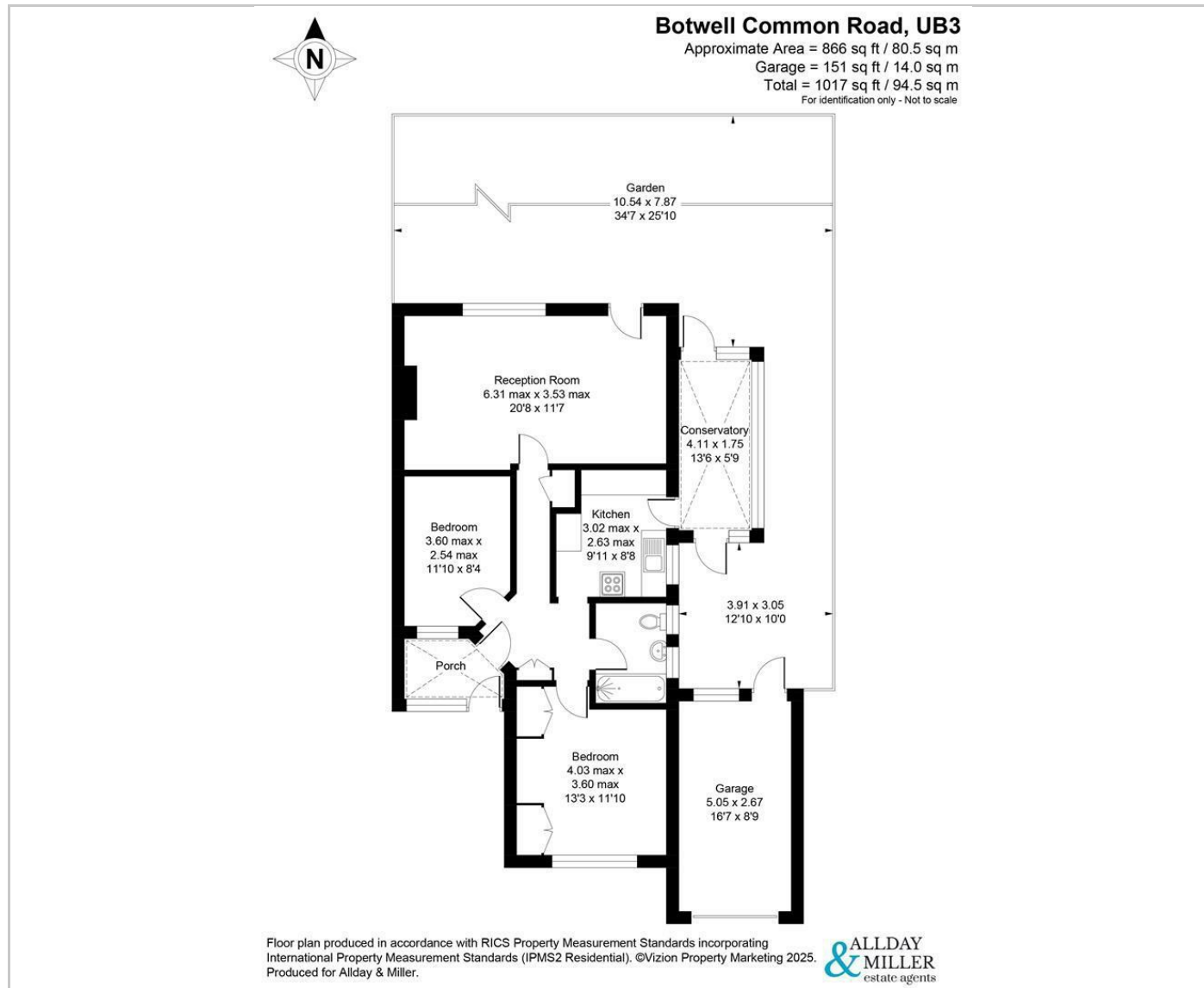

Area Map

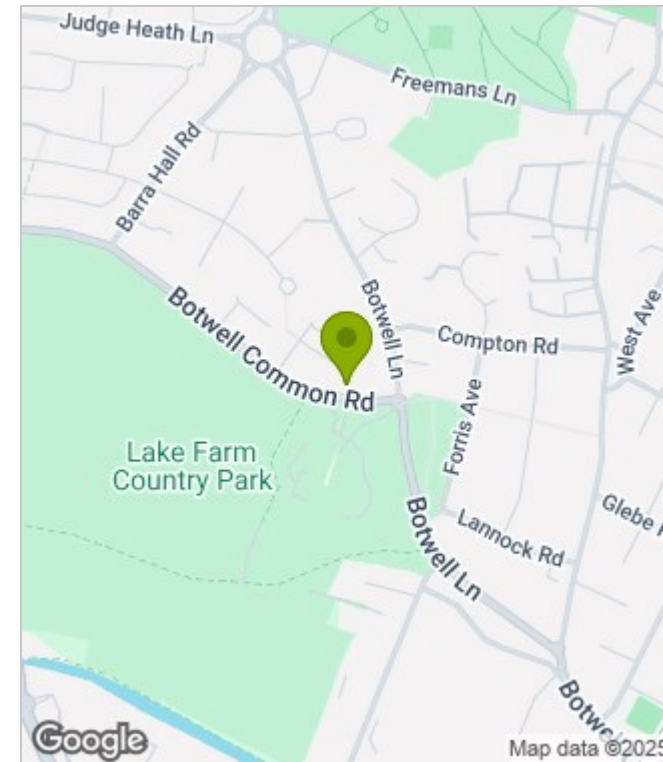

Energy Performance Graph

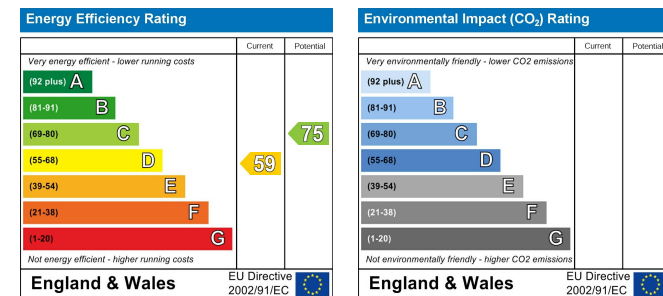

These particulars, whilst believed to be accurate are set out as a general outline only for guidance and do not constitute any part of an offer or contract. Intending purchasers should not rely on them as statements of representation of fact, but must satisfy themselves by inspection or otherwise as to their accuracy. No person in this firm's employment has the authority to make or give any representation or warranty in respect of the property.