



Wren Cottage

3 Sanctuary Court | Wiggonholt | Pulborough | RH20 2EQ

An attractive cottage style bungalow occupying this courtyard setting of converted barns backing onto open countryside to the rear and adjoining the RSPB Nature Reserve. Internally, the property is well presented accommodation comprising two bedrooms, sitting room/dining room, fitted kitchen, bathroom, oil fired central heating, delightful feature landscaped gardens, there is one allocated space to the front of property and one allocated car barn to the property. No forward chain.

Entrance uPVC stable front door to:

Entrance Hall Tiled flooring, exposed oak beam, shelved linen cupboard housing factory insulated copper cylinder with fitted immersion, radiator, part glazed doors leading to:

Sitting Room/Dining Room 16' 0" x 14' 4 narrowing to 8' in the dining area" (4.88m x 4.37m) A 'L' shaped room. Feature exposed oak high ceiling beam, two radiators, TV point, uPVC double glazed French doors leading to rear garden, with delightful outlook over garden and onto open fields.

Kitchen 7' 9" x 5' 10" (2.36m x 1.78m) Range of wall and base units with space for fridge/freezer, plumbing for washing machine, space for cooker, extractor over, eye-level cupboards, part tiled walls, inset stainless steel single drainer sink unit with swan neck mixer tap, part tiled walls, wall-mounted boiler, uPVC double glazed window.

Bedroom One 10' 4" x 8' 1" (3.15m x 2.46m) Exposed oak ceiling beam, radiator, uPVC double glazed window.

Bedroom Two 10' 10" x 8' 4" (3.3m x 2.54m) Exposed oak ceiling beam, radiator, uPVC double glazed window.

Bathroom Panelled bath with fitted shower attachment and folding screen, part tiled walls, fitted independent shower unit, pedestal wash hand basin, low level flush w.c., radiator, exposed oak beam, extractor fan.

Outside

Front There is one allocated space to the front of property and one allocated car barn to the property.

Rear Garden A particular feature of this property is the landscaped garden with York stone paved terrace with covered pergola, shaped lawned areas, attractive flower and shrub borders, timber garden shed, further circular paved feature with summerhouse, timber shed, trellising through to gravelled area with delightful outlook over paddocks and open fields beyond.

Agents Note There is a drainage system charge of approximately £tbc monthly for each resident.

EPC Rating: Band E.



Fowlers Greenfield House, The Square, Storrington, West Sussex, RH20 4DJ

www.fowleronline.co.uk storrington@fowleronline.co.uk 01903 745844

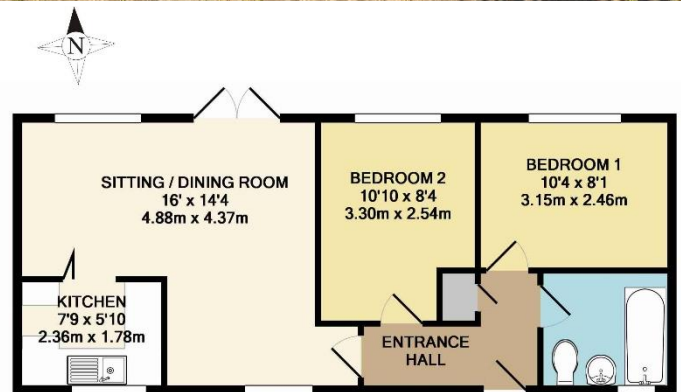

WREN COTTAGE, 3 SANCTUARY COURT, WIGGONHOLT

APPROX. GROSS INTERNAL FLOOR AREA 512 SQ FT 47.6 SQM

While every attempt has been made to ensure the accuracy of the floor plans contained herein, measurements of doors, windows and rooms are approximate and no responsibility is taken for any error, omission or misstatement. These plans are for identification purposes only and are not drawn to scale. This plan has been prepared for JTM Division on behalf of Fowlers Estate Agents.

Important Notice

1. Fowlers wish to inform all prospective purchasers that these sales particulars do not form part of any contract and have been prepared in good faith to give a fair overall viewing of the property.
2. We have not undertaken a structural survey, nor tested that the services, appliances, equipment or facilities are in good working order.
3. Fowlers cannot verify that any necessary consents have been obtained for conversions, extensions and other alterations such as underpinning,

garaging and conservatories etc. Any reference to such alterations is not intended as a statement that any necessary planning or building consents have been obtained and if such details are fundamental to a purchase, then prospective buyers should contact this office for further information or make further enquiries on their own behalf.

4. Any area, boundary, distances or measurements referred to are given as a guide only and should not be relied upon. If such details are fundamental to a purchase, please contact this office for further information.

5. The photographs shown in these details show only certain aspects of the property at the time they were taken. Certain aspects therefore may have changed and it should not be assumed that the property remains precisely as displayed in the photographs.
6. Fowlers cannot verify whether the property and its grounds are subject to any restrictive covenants, rights of way, easements etc, and purchasers are advised to make further enquiries to satisfy themselves on these points.