



35 Appleton Road, Hale

£625,000 Freehold

Modern refurbished end terrace near Hale Village. 1100 sqft, light-filled kitchen extension, south-facing garden, 2 double bedrooms, family bathroom, and loft conversion potential.

Council Tax band: D

Tenure: Freehold

EPC Energy Efficiency Rating: E

EPC Environmental Impact Rating: E



**HIBBERT
HOMES**

SALES & LETTINGS

A MODERN, REFURBISHED, PERIOD END TERRACE Property, within WALKING DISTANCE to Hale Village. Finished to the highest standard, the property boasts 1100 SQFT of space, that is filled with light thanks to the clever kitchen extension. Comprising; Entrance, Lounge, Open plan kitchen dining with roof lights and bi-folding rear doors, leading to a south facing garden. Downstairs WC. On the first floor; 2 double bedrooms, the main with built in storage, and a family bathroom. The second floor there is a bedroom with ensuite.

Viewing is highly recommended!



- South-Facing Garden
- Great Local Schools With Close Proximity
- Refurbished To A High Standard Throughout
- Walking Distance to Hale Village
- Extended Kitchen/Dining Room
- Viewing Highly Recommended
- Downstairs W/C
- Popular Location





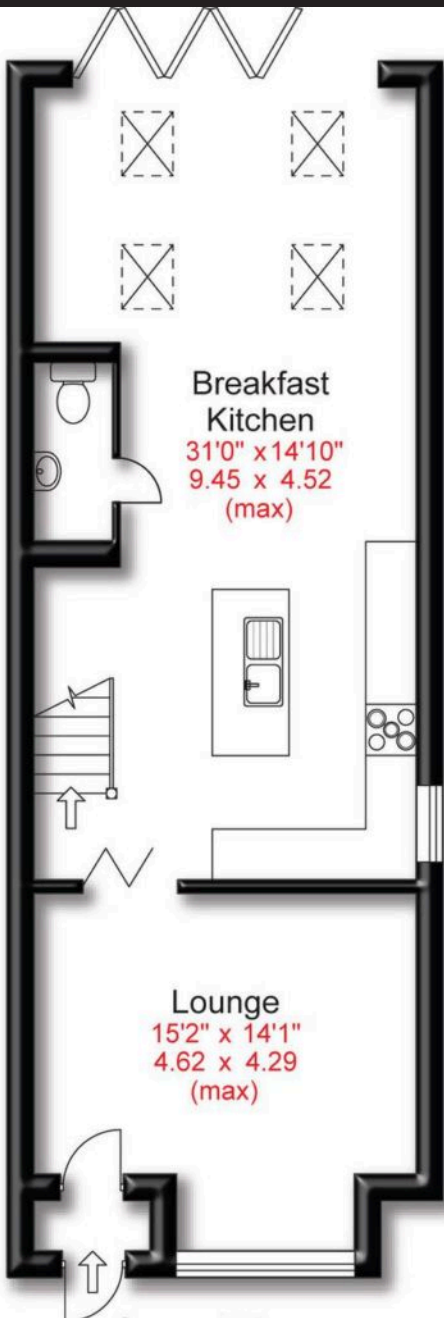

Approx Gross Floor Area = 1301 Sq. Feet

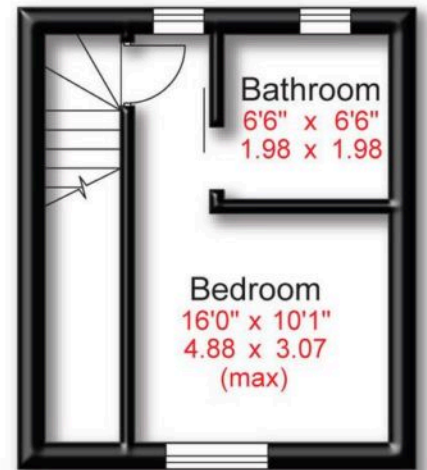
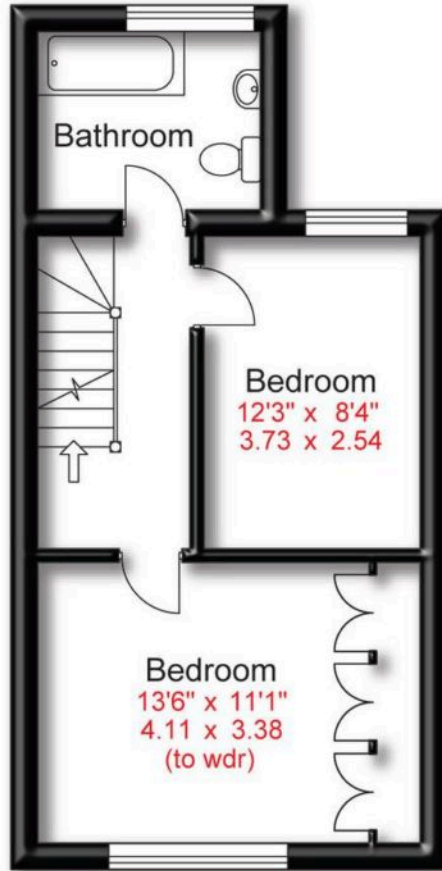

Ground Floor

First Floor

Second Floor

You can include any text here. The text can be modified upon generating your brochure.

