



LEANDER ROAD, SW2

£500,000

Two Double Bedrooms
Period Property
Open Plan Kitchen-Living
Private Garden
Cellar
Energy Rating: D

@marshandparsons
marshandparsons.co.uk

MARSH &
PARSONS



ABOUT THE PROPERTY

A charming two bedroom ground floor garden flat set within a handsome period conversion.

The property offers two well-proportioned bedrooms, the first bedroom hosts a large bay window whilst the second bedroom benefits from French doors offering access to the generous private garden. A spacious open plan kitchen-reception room is located to the rear of the property boasting a stylish kitchen complete with ample wall and base units, integrated appliances and solid worktops with further access to the garden. There is also a cellar complete with utilities and additional storage space.



STEP INSIDE LEANDER ROAD

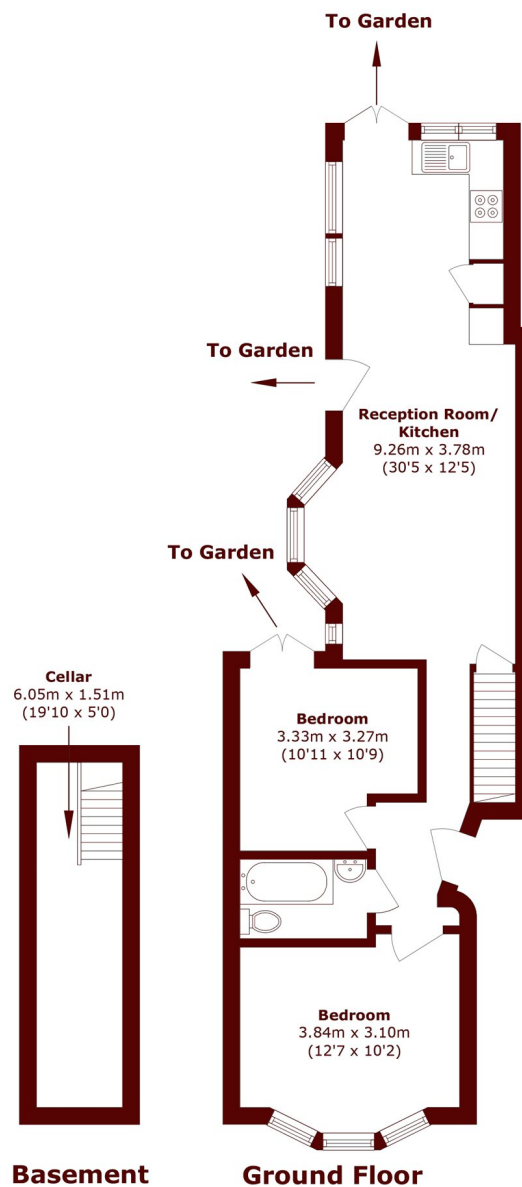

Total area (approx.): 70.1 sq. m (754.5 sq. ft)
(Including Basement)

Brixton
020 7733 4595

Energy Rating: D We aim to make our particulars both accurate and reliable. However, they are not guaranteed; nor do they form part of an offer or contract. If you require clarification on any points then please contact us, especially if you're traveling some distance to view. Please note that appliances and heating systems have not been tested and therefore no warranties can be given as to their good working order

**MARSH &
PARSONS**