



**Walkers**  
People & Property

Ingrave Road, Brentwood. CM13 2AG  
£750,000



## Ingrave Road

Brentwood. CM13 2AG

Situated on the ever-popular Ingrave Road, this immaculately presented semi-detached family home offers beautifully maintained accommodation, generous outdoor space and exceptional versatility, making it an ideal choice for growing families and those seeking a home ready to move straight into.

The ground floor has been thoughtfully arranged to provide comfortable and practical living space. A welcoming entrance hall leads to a spacious living room, complemented by a separate sitting room that offers the perfect setting for relaxing, entertaining or creating a dedicated family space. The modern fitted kitchen enjoys an abundance of storage and worktop space, while a useful utility room and ground floor WC add to the home's everyday convenience.

Upstairs, the property offers three well-proportioned bedrooms, all presented to an excellent standard, alongside a contemporary family bathroom. A separate study provides an ideal work-from-home office or potential nursery, catering perfectly to modern lifestyles.

Externally, the property continues to impress. To the front, there is ample off-street parking for multiple vehicles, ensuring practicality for busy households and visiting guests alike. The substantial rear garden is undoubtedly one of the home's standout features. The first section has been beautifully landscaped, creating an attractive space for outdoor dining, entertaining and family enjoyment. Beyond this, the garden extends to a further generous area backing directly onto King George's Playing Fields, providing a wonderful sense of openness, privacy and picturesque green surroundings rarely found in such a convenient location.

Further enhancing the property's appeal are two substantial outbuildings, offering excellent potential for storage, workshops, hobbies, a home gym or future conversion, subject to the necessary consents.

Ideally positioned within easy reach of Brentwood's vibrant High Street, excellent local schools, parks and mainline railway station with links into London, this outstanding home successfully combines stylish presentation with generous living accommodation and an exceptional garden setting.

# Ingrave Road

Brentwood. CM13 2AG

Situated on the ever-popular Ingrave Road, this immaculately presented semi-detached family home offers beautifully maintained accommodation, generous outdoor space and exceptional versatility, making it an ideal choice for growing families and those seeking a home ready to move straight into.

Council Tax band: F

Tenure: Freehold

EPC Energy Efficiency Rating: C

EPC Environmental Impact Rating: C

- Immaculately Presented Throughout
- Ample Off-Street Parking
- Large Garden Backing King Georges Playing Fields
- Four Bedrooms
- En-Suite & Family Bathroom
- Three Reception Areas









**First Floor**  
Approx. 55.0 sq. metres (592.1 sq. feet)

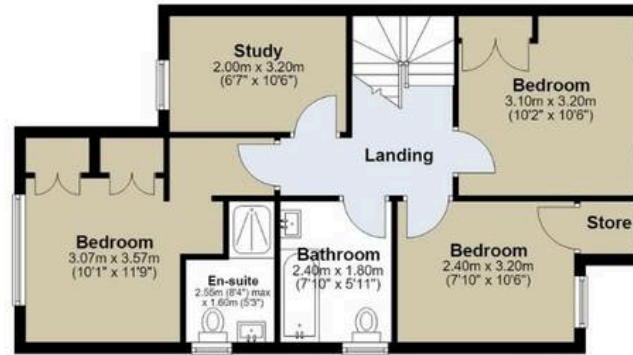

**Outbuilding**  
Approx. 44.0 sq. metres (473.8 sq. feet)



**Outbuilding**  
Approx. 32.7 sq. metres (351.9 sq. feet)



**Ground Floor**  
Approx. 64.4 sq. metres (693.5 sq. feet)



Measurements are approximate and for illustration purposes only. While we do not doubt the accuracy and completeness, we advise you conduct a careful independent assessment of the property to determine monetary value

## Psst... Have you heard of

## Walkers discreet marketing?

Many people lose out on their dream home to someone in a better position.

Often, it is because they have delayed putting their house on the market, preferring to find somewhere first and then sell,

That is why we have innovated a totally unique and highly confidential moving home solution to put you in a competitive position.

Let us find you a buyer **without any advertising or pressure** and without the neighbours knowing.

Your secret is safe with us....

## Get in touch for a complimentary valuation.

Looking To Sell Or Let Your Home?

Book your free valuation to see how much your home is worth.

Contact Us  
01277 355005



Our Website

[www.walkersstates.co.uk](http://www.walkersstates.co.uk)



Our Address

90 High Street  
Ingatstone  
CM4 9DW



[www.walkersstates.co.uk](http://www.walkersstates.co.uk)

## About Us

Walkers | People & Property is built on a lifelong family passion for homes. Martin, Gillian and Adam Walker lead a respected, professional team who live and breathe all aspects of property. With over 30 years of experience, we understand the moving process on a personal level and are committed to delivering exceptional results. Most of all, helping people move is our hobby, and handing over the keys to excited buyers remains our favourite moment.

## Get In Touch



## Browse Properties

