

Uckfield 01825 703000  
Crowborough 01892 489000  
Heathfield 01435 511800

Peter Oliver



## Standen Mews, Hadlow Down, TN22 4HG

- ▼ Modern Mid-Terraced House
- ▼ 2 Bedrooms, Shower Room, W/C
- ▼ Kitchen, Lounge, Conservatory
- ▼ Driveway, Visitors Parking
- ▼ Low-Maintenace Rear Garden
- ▼ Gorgeous Rural Views To Rear



### EPC RATING

Current:

75 | C

Potential:

89 | B

**£340,000**



## Standen Mews, Hadlow Down, TN22 4HG

Tucked away in a peaceful close in the heart of Hadlow Down village, this modern two-bedroom mid-terraced home offers a perfect blend of comfort and practicality. To the front, the property benefits from a driveway, complemented by additional visitor and resident parking. A spacious and welcoming entrance hall sets the tone, providing access to a convenient ground floor W/C and useful understairs storage. The front-facing kitchen is well-appointed with a good range of wall and base units, while to the rear, a bright and inviting lounge provides an ideal space for relaxing or entertaining guests. The lounge flows seamlessly into a charming conservatory, perfectly suited for dining, which enjoys delightful views over the rear garden and beyond. The garden itself is designed for low maintenance, making it an ideal setting for summer barbecues and outdoor relaxation. Upstairs, the property continues to impress with a generous principal bedroom featuring a large built-in wardrobe and attractive rear-facing views. A second bedroom is also located on this floor, along with a stylish family shower room that includes additional built-in storage. This well-presented home is perfectly suited to first-time buyers, those looking to downsize, or investors seeking a buy-to-let opportunity.

Uckfield 01825 703000  
Crowborough 01892 489000  
Heathfield 01435 511800

Peter Oliver

The Property  
Ombudsman

The Property  
Ombudsman  
LETTINGS



GROUND FLOOR  
54.7 sq.m. (589 sq.ft.) approx.

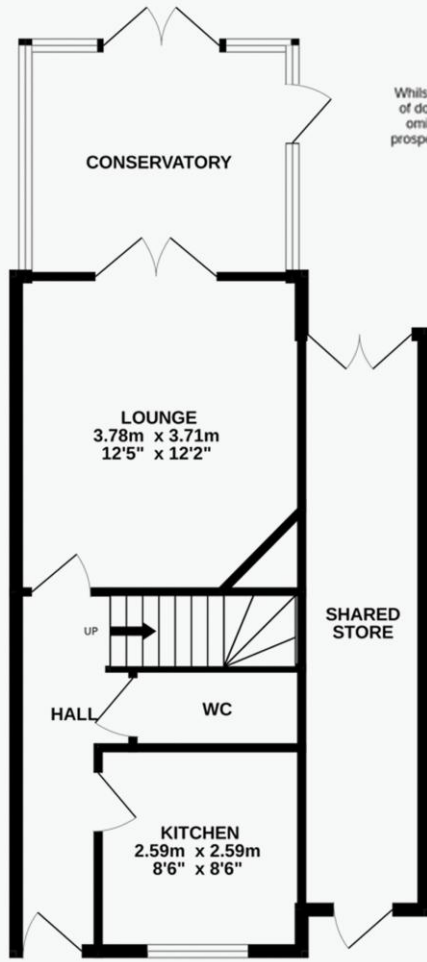

# Peter Oliver

TOTAL FLOOR AREA : 90.2 sq.m. (971 sq.ft.) approx.

Whilst every attempt has been made to ensure the accuracy of the floorplan contained here, measurements of doors, windows, rooms and any other items are approximate and no responsibility is taken for any error, omission or mis-statement. This plan is for illustrative purposes only and should be used as such by any prospective purchaser. The services, systems and appliances shown have not been tested and no guarantee as to their operability or efficiency can be given.  
Made with Metropix ©2026

1ST FLOOR  
35.5 sq.m. (382 sq.ft.) approx.

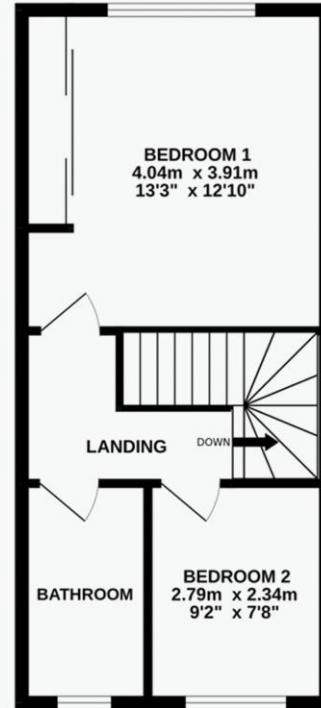

TENURE: FREEHOLD

COUNCIL TAX BAND: C

MAINTENANCE/SERVICE CHARGE: N/A

Uckfield 01825 703000  
Crowborough 01892 489000  
Heathfield 01435 511800  
info@peteroliverhomes.co.uk

# Peter Oliver

The information provided about this property does not constitute or form part of an offer or contract, nor may it be regarded as representations. All interested parties must verify accuracy and your solicitor must verify tenure/lease information, fixtures & fittings and, where the property has been extended/converted, planning/building regulation consents. All dimensions are approximate and quoted for guidance only as are floor plans which are not to scale and their accuracy cannot be confirmed. Reference to appliances and/or services does not imply that they are necessarily in working order or fit for the purpose.