

**Need a Mortgage in principle to make offers?** Call us now for quick assistance!  
**0121 775 0101**



**Do you need to sell? Start your journey now!** Call us we can help.  
**01564 777 314**



**SCAN FOR MORE INFO**  
**SIZE** - 533 Sq Ft  
**TENURE** - Leasehold with 983 years remaining  
**SERVICE CHARGE** - £2,090.20 Half Yearly  
**GROUND RENT** - £287.50 Half Yearly  
**COUNCIL TAX** - Solihull Metropolitan Borough Council - D  
**BROADBAND** - Upload Max 1000Mbps Download Max 1800Mbps  
**MOBILE** - EE - 83%, Vodafone - 79%, 3 - 79%, 02 - 76%  
**EPC** - B - 82  
**PARKING** - Free Onsite Parking  
**FLOODRISK** - Very Low  
**SERVICES** - Mains  
**COVENANTS** - N/A

**Are you an investor interested in expanding your portfolio?**

**Call 01564 777 314 to provide your investment criteria for alerts.**

## Apartment 16 Eleanor Lodge

**24 Station Road, Knowle, B93 0JN**  
**Offers in the region of £250,000**

Welcome to this delightful retirement apartment exclusively designed for those over 60. This property is offered with no upward chain, making it an ideal choice for those looking to settle in a welcoming environment. This apartment is not just a home; it is a lifestyle choice that prioritises comfort, security and community.

### FEATURES

- First Floor Apartment with Lift Access
- Exclusively for the Over 60's
- Lounge/Dining Room
- Modern Fitted Kitchen
- Spacious Double Bedroom with Walk In Wardrobe
- Luxury Shower Room
- Un-Restricted views Over the Landscaped Communal Gardens
- Ample Free Parking Available
- 24 Hour Careline Support System
- Owners Lounge
- Walking Distance to Knowle Village Centre

### Sneak Peeks

Every week, we unveil "Sneak Peeks," a feature showcasing exclusive properties before they hit Rightmove and other platforms.

### The Landlord Club

Join our Landlord Club for weekly updates on legislation, market trends, and our Letting Director's 'Investment Pick of the Week' for optimal ROI.

### HTSPMD

Tune into 'How's The Solihull Property Market Dom' weekly for a quick, insightful snapshot of the market.

### The Mortgage Update

Get weekly insights and the best deals with our Mortgage Update, your shortcut to navigating the complex mortgage landscape confidently.



**SCAN TO VIEW OUR WEEKLY FILMS & SUBSCRIBE**

# Floor Plan

Approx. 49.5 sq. metres (533.2 sq. feet)

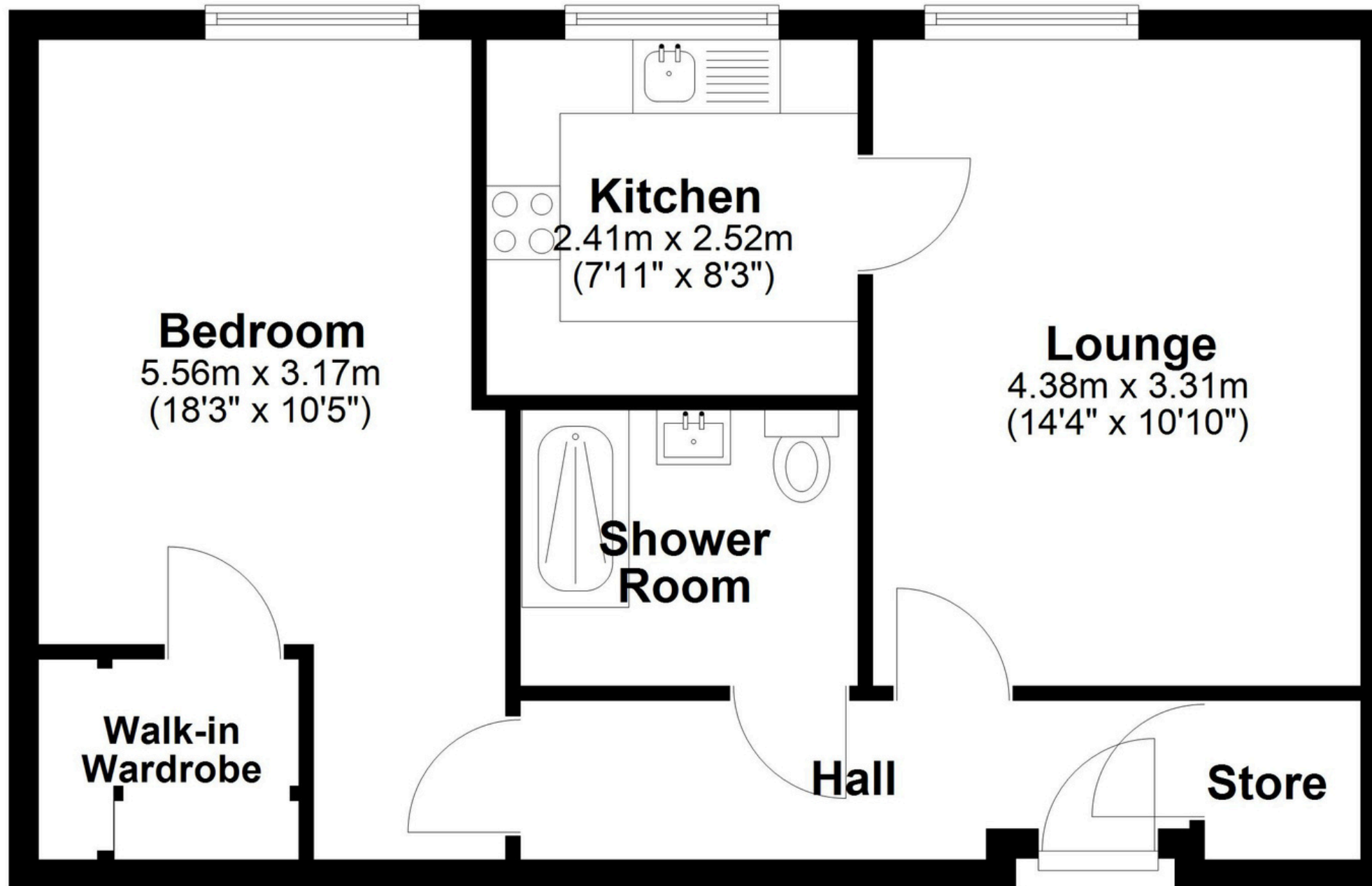

**Total area: approx. 49.5 sq. metres (533.2 sq. feet)**

This floor plan is for illustration purposes only, this is not intended to be a measured/scaled survey or comply with RICS guidelines. All measurements (including total floor area) openings, orientation and floor area are approximate. No details are guaranteed, they cannot be relied upon for any purpose and do not form part of any agreement. A party must rely upon its own inspection(s). No responsibility is taken for any error, omission, or mis-statement.

Plan produced using PlanUp.