



Anstice Close, W4

£426 Per week

A well presented one bedroom apartment in a purpose-built block with wooden floors throughout. The property offers a modern kitchen and bathroom, access to communal gardens and allocated parking.

Within walking distance of Chiswick House and Gardens, a short bus journey from Chiswick High Road and its amenities, and approximately 0.9 miles from Chiswick railway station.

Features

- One Bedroom
- Riverside Location
- Open Plan
- Allocated Parking
- First Floor
- Double Glazing

Anstice Close, London, W4

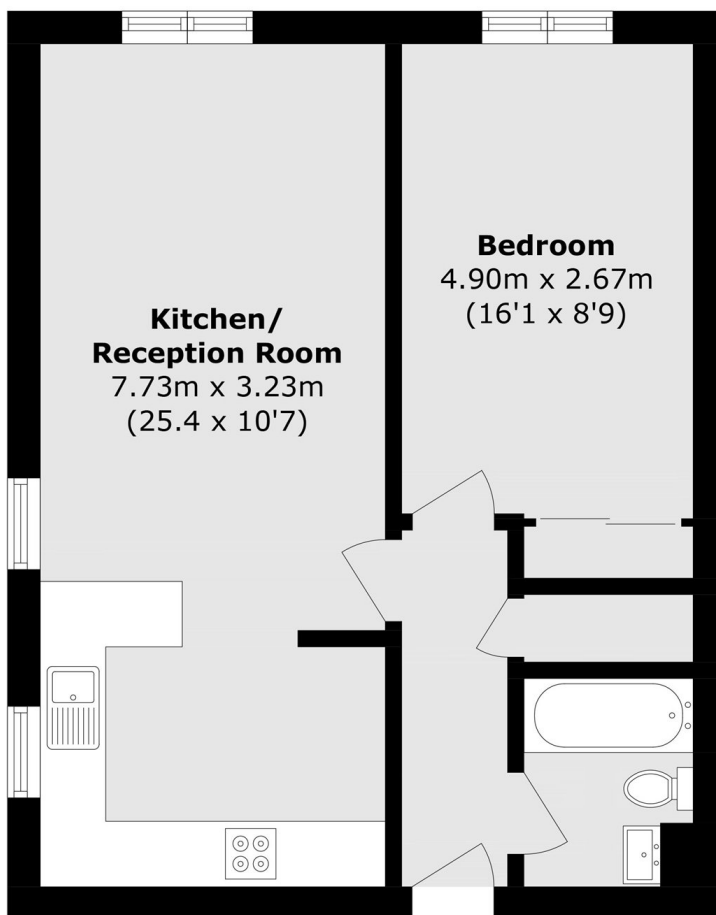

Total area (approx): 46.2 sq. m (497.2 sq. ft)