



COMP END

Platt, TN15



DETACHED COTTAGE SITTING IN OVER 1 ACRE OF GARDENS

A historic property built in the early 1900's and originally the cricket pavilion for Great Comp house. More recently the property has become a wonderfully special home set in surrounding woodland and gardens and alongside the country house of Great Comp.



Local Authority: Tonbridge & Malling

Council Tax band: F

Tenure: Freehold



THE PROPERTY

The property faces east towards the original siting of the cricket "oval" of Great Comp. Now surrounded by trees the house benefits from a wonderful central sitting/dining room which opens out onto the sun room and then the garden. The spacious kitchen/breakfast room and utility room (with guest WC) opens to the central living area with a snug, two bedrooms and a bathroom completing the ensemble. A large loft room, running the footprint of the property sits above the living space and, subject to planning, would give great flexibility for anyone looking to develop the house. The property also benefits from further excellent space above the double garage and store room where an independent store room is found, perfect for an office or children's playroom. The house sits in approximately 1.1 acres of gardens and grounds and sits privately on the west side of Great Comp Gardens. Ample parking is provided on the north side of the house.





Comp End

House - Gross Internal Area : 144.6 sq.m (1556 sq.ft.)
 Outbuilding - Gross Internal Area : 81.5 sq.m (877 sq.ft.)

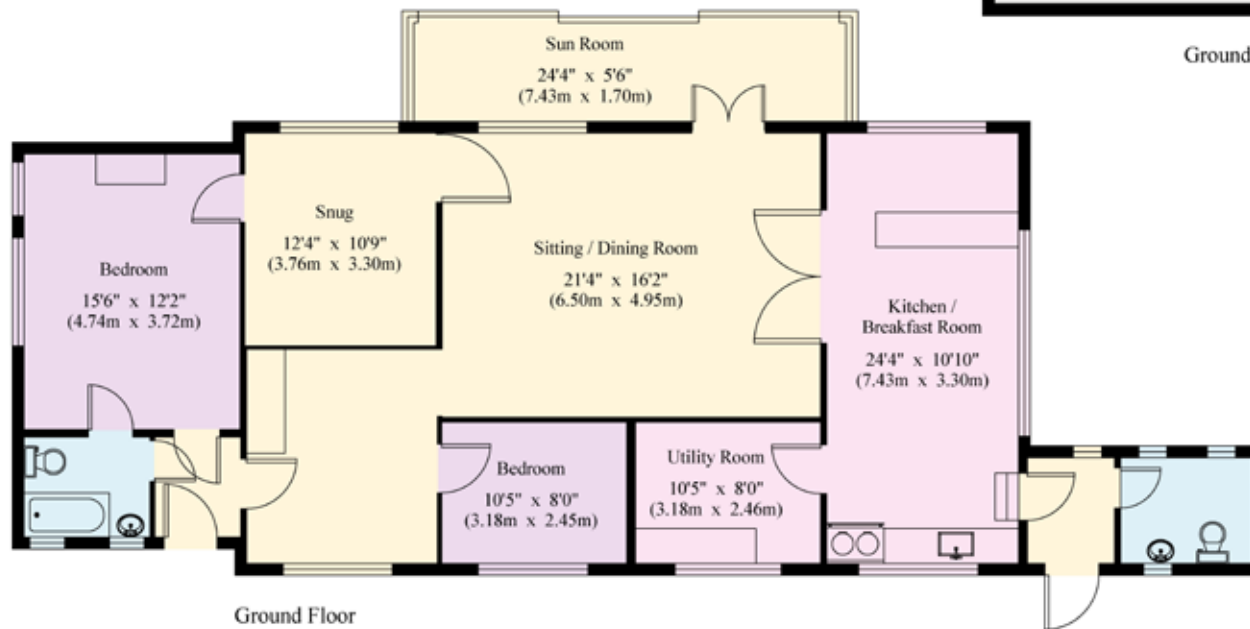
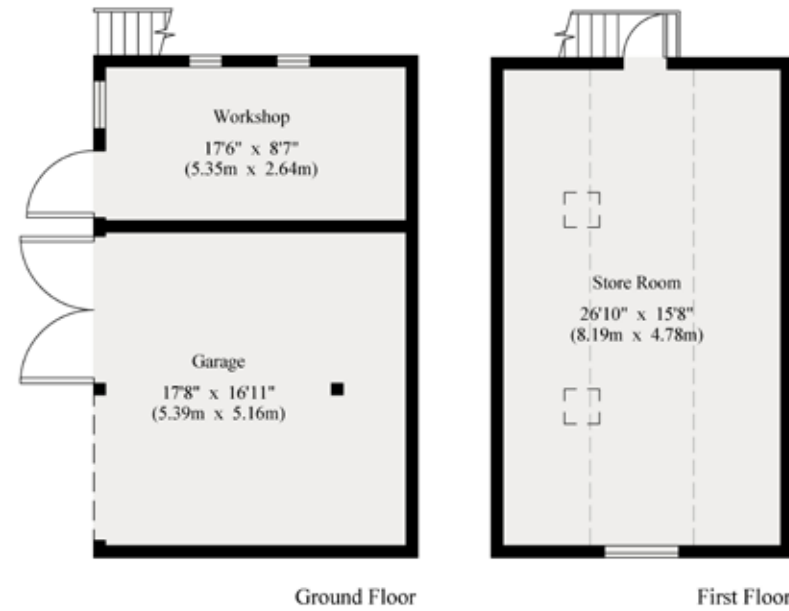

----- Restricted Height



© 26/05/22 Trueplan (UK) Ltd. 01892 614 881

This plan is for guidance only and must not be relied upon as a statement of fact. Attention is drawn to the Important Notice on the last page of the text of the Particulars.

Approximate Gross Internal Area = 144.6 sq m / 1556 sq ft

This plan is for layout guidance only. Not drawn to scale unless stated. Windows and door openings are approximate. Whilst every care is taken in the preparation of this plan, please check all dimensions, shapes and compass bearings before making any decisions reliant upon them. (ID767266)



Matthew Hodder-Williams

M: 07929 793159 T: 01732 744460

E: matthew.hodder-williams@knightfrank.com

Knight Frank Sevenoaks

113-117 High Street, Sevenoaks, Kent

TN13 1UP

[knightfrank.co.uk](https://www.knightfrank.co.uk)

Your partners in property

1. Particulars: These particulars are not an offer or contract, nor part of one. You should not rely on statements given by Knight Frank in the particulars, by word of mouth or in writing ("information") as being factually accurate about the property, its condition or its value. Neither Knight Frank nor any joint agent has any authority to make any representations about the property, and accordingly any information given is entirely without responsibility on the part of Knight Frank. 2. Material Information: Please note that the material information is provided to Knight Frank by third parties and is provided here as a guide only. While Knight Frank has taken steps to verify this information, we advise you to confirm the details of any such material information prior to any offer being submitted. If we are informed of changes to this information by the seller or another third party, we will use reasonable endeavours to update this as soon as practical. 3. Photos, Videos etc: The photographs, property videos and virtual viewings etc. show only certain parts of the property as they appeared at the time they were taken. Areas, measurements and distances given are approximate only. 4. Regulations etc: Any reference to alterations to, or use of, any part of the property does not mean that any necessary planning, building regulations or other consent has been obtained. A buyer must find out by inspection or in other ways that these matters have been properly dealt with and that all information is correct. 5. Fixtures and fittings: A list of the fitted carpets, curtains, light fittings and other items fixed to the property which are included in the sale (or may be available by separate negotiation) will be provided by the Seller's Solicitors. 6. VAT: The VAT position relating to the property may change without notice. 7. To find out how we process Personal Data, please refer to our Group Privacy Statement and other notices at <https://www.knightfrank.com/legals/privacy-statement>.

Particulars dated March 2026. Photographs and videos dated May 2022. All information is correct at the time of going to print. Knight Frank is the trading name of Knight Frank LLP. Knight Frank LLP is a limited liability partnership registered in England and Wales with registered number OC305934. Our registered office is at 55 Baker Street, London W1U 8AN. We use the term 'partner' to refer to a member of Knight Frank LLP, or an employee or consultant. A list of members names of Knight Frank LLP may be inspected at our registered office. If you do not want us to contact you further about our services then please contact us by either calling 020 3544 0692, email to marketing.help@knightfrank.com or post to our UK Residential Marketing Manager at our registered office (above) providing your name and address.



Knight
Frank

