



Flat 3

Cherry Hinton Road | | Cambridge | CB1 8DB

£1,300 PCM

COOKE
CURTIS
& CO

Key features

- 44.6 sqm / 480 sqft
- Available April 2026
- First floor apartment
- 1 bed, 1 recep, 1 bath
- One allocated parking space
- Unfurnished
- EPC - C
- Council tax - B

Description

A modern one-bedroom, first floor apartment on Cherry Hinton Road with an allocated parking space. Two miles from Cambridge City Centre.



Directions

Cherry Hinton Road takes you from the city all the way to the village of Cherry Hinton. The road itself has an excellent range of facilities including nearby doctors and dentists surgeries, restaurants and take-aways. Mill Road, one of the country's top 50 suburbs and its' cosmopolitan shops, delis and restaurants, Addenbrookes Hospital and biomedical campus and the main train station are all just over a mile away and easily accessible on foot or by bicycle.





Flat THREE

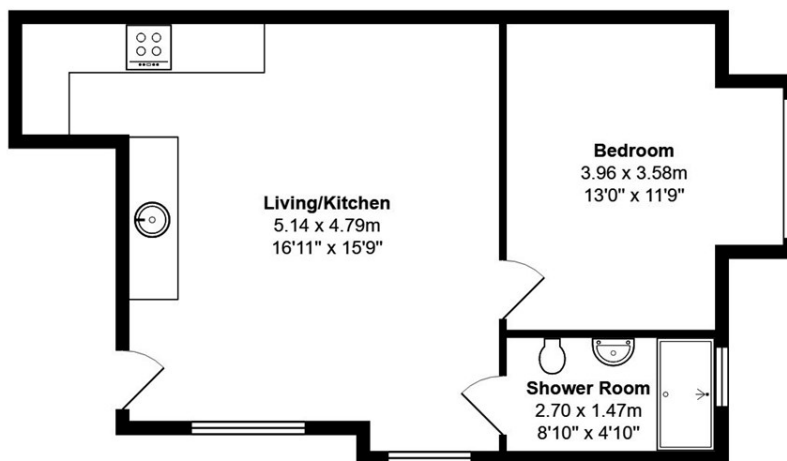

Total Area: 44.6 m² ... 480 ft²

All measurements are approximate and for display purposes only

Plan prepared by charlesjharrison.co.uk

Energy Efficiency Rating		
	Current	Potential
<i>Very energy efficient - lower running costs</i>		
(92 plus) A		
(81-91) B		
(69-80) C	79	79
(55-68) D		
(39-54) E		
(21-38) F		
(1-20) G		
<i>Not energy efficient - higher running costs</i>		
England & Wales	EU Directive 2002/91/EC 	

Council Tax Band **B** EPC Rating **C**

**COOKE
CURTIS
& CO**

40 High Street
Trumpington
Cambridge
Cambridgeshire
CB2 9LS
01223 508050

hello@cookecurtis.co.uk
cookecurtis.co.uk