



4 LAKESIDE COTTAGES

SELBY, YO8 6PS

£1,500 PER MONTH

Nestled within the serene setting of Lakeside Cottages in Foggathorpe, Selby, this charming three-bedroom detached property offers a delightful retreat for those seeking tranquility and comfort. The property is situated in a private development, surrounded by the picturesque beauty of a lake, making it an ideal haven for nature lovers.

Upon entering, you are welcomed into two spacious reception rooms that provide ample space for relaxation and entertaining.

The three generously sized double bedrooms offer plenty of room for rest and privacy, making it suitable for families or those who enjoy having guests. Each room is benefits from a lovely view of the gardens.



Cartref Lettings

L I C E N S E D A G E N T

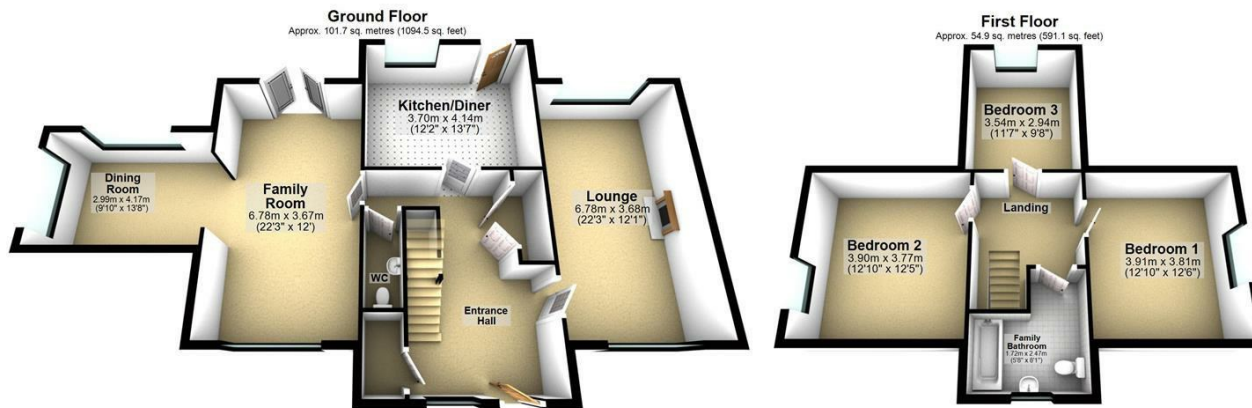

Total area: approx. 156.6 sq. metres (1685.6 sq. feet)



Energy Efficiency Rating		Current	Potential
Very energy efficient - lower running costs			
(92 plus) A			
(81-91) B			83
(69-80) C		69	
(55-68) D			
(39-54) E			
(21-38) F			
(1-20) G			
Not energy efficient - higher running costs			
England & Wales		EU Directive 2002/91/EC	

Agents Note: Whilst every care has been taken to prepare these particulars, they are for guidance purposes only. All measurements are approximate and are for general guidance purposes only and whilst every care has been taken to ensure their accuracy, they should not be relied upon and potential buyers/tenants are advised to recheck the measurements

Cartref
West End Farmhouse Barmby Road
Asselby
DN14 7HE

07394061091
info@cartref-lettings.co.uk
www.cartref-lettings.co.uk

Cartref Lettings
LICENSED AGENT