

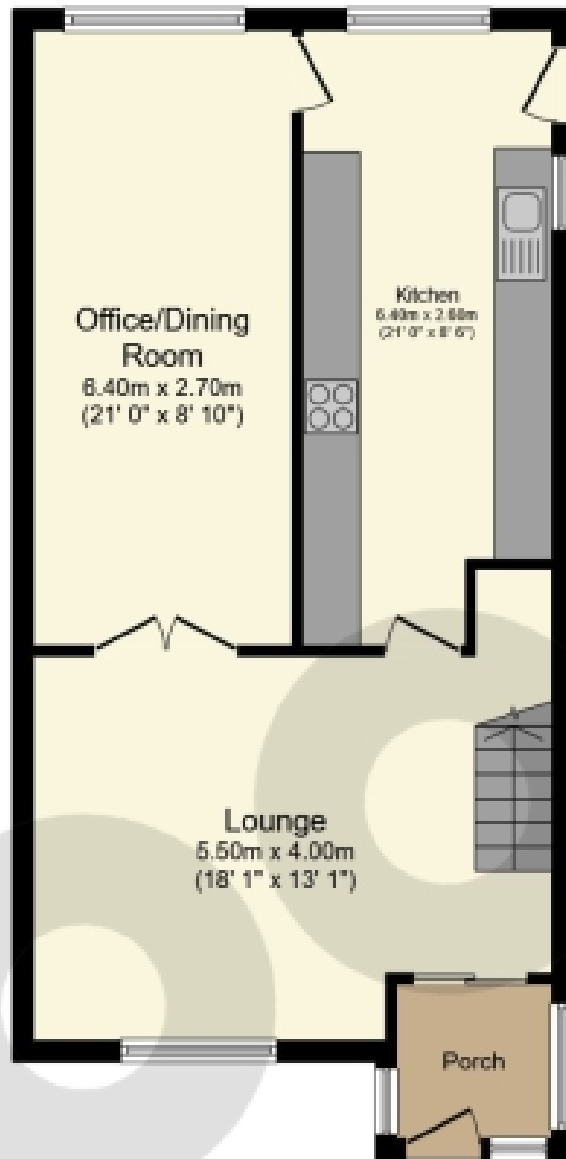

Antonine Road, Bearsden

Offers Over £299,995





Ground Floor

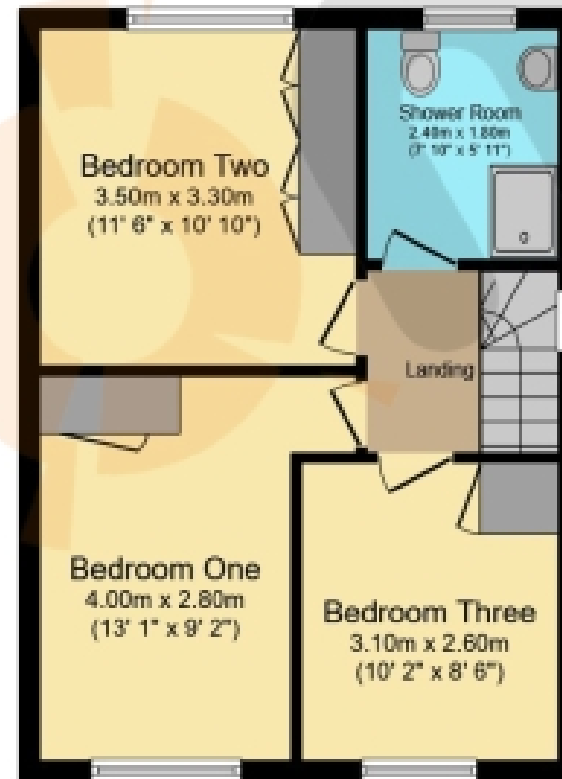

First Floor

Total floor area: 99.4 sq.m. (1,070 sq.ft.)

This floor plan is for illustrative purposes only. It is not drawn to scale. Any measurements, floor areas (including any total floor area), openings and orientations are approximate. No details are guaranteed, they cannot be relied upon for any purpose and do not form any part of any agreement. No liability is taken for any error, omission or misstatement. A party must rely upon its own inspection(s). Powered by www.Propertybox.io

THE PROPERTY

Nestled within one of Glasgow's most desirable areas. Antonine Road in Bearsden is a highly sought-after neighbourhood offering this extended semi-detached villa with masses of potential.

Offering an exciting opportunity for a discerning buyer, this wonderful family home provides the perfect canvas to create a bespoke living space. While requiring a degree of modernisation, the generous and versatile layout presents endless possibilities to reconfigure and enhance the accommodation to suit modern family life.

The front of the property is low maintenance monobloc, complemented with mature shrubbery, ample off-street parking, and steps leading to the entrance vestibule.

The family lounge boasts impressive proportions and features a focal-point fireplace, with French doors opening into the dining room. Thoughtfully extended, this versatile space offers flexibility to accommodate a variety of lifestyles, whether as a family room, additional sitting area, formal dining space, or a combination of all three.

The extended kitchen is fitted with an array of white wall and base units paired with marble-effect worktops, providing ample storage and preparation space alongside plenty of space for freestanding appliances where desired.

Into the upper level are three well-proportioned double bedrooms along with a fully tiled shower room comprising a walk-in shower, wash hand basin, and W.C.

Externally, the rear garden is fully enclosed and features a spacious patio area, ideal for outdoor seating.

Gas-central heating and double glazing provide a delightful warmth throughout the home. Due to its prime location and excellent condition, we expect a lot of interest in this property. If you like what you see, please get in contact today!

There is a great selection of local amenities including shops, supermarkets, schools and transport services. Bus and rail links give regular access throughout the area to the West End, Glasgow City Centre and further afield. The M8 motorway network is within a few miles and provides additional links to Glasgow Airport, Braehead Shopping Centre and the Queen Elizabeth Hospital.

AI has been used to enhance this listing.

Please contact The Property Boom to arrange a viewing or for any further information and a copy of the Home Report. Any areas, measurements or distances quoted are approximate and floor Plans are only for illustration purposes and are not to scale. Thank you.

THESE PARTICULARS ARE ISSUED IN GOOD FAITH BUT DO NOT CONSTITUTE REPRESENTATIONS OF FACT OR FORM PART OF ANY OFFER OR CONTRACT.

www.thepropertyboom.com
Head Office : 31 Braehead, Beith, KA15 1EG
Tel: 0333 900 9089 / Email: smile@thepropertyboom.com