



# Hillsborough Court

Mortimer Crescent, NW6

£325 per week  
(£1,408.33 pcm)

\*\*\*VIDEO VIEWING AVAILABLE\*\*\* A modern apartment with wood floor, set in a portered mansion building with communal gardens close to Maida Vale Underground Station.



# Hillsborough Court

## Mortimer Crescent, NW6

- A Modern Apartment in Mansion Block
- 2 Bedrooms, 1 Bathroom
- Heating & Hot Water Included In Rent
- Close to Maida Vale & Swiss Cottage Underground Stations



This apartment, set on the top floor (with lift) of a portered mansion block, has lots of natural light and has just been fully refurbished throughout. The property comprises; large and bright reception/dining room, separate modern kitchen, two double bedrooms with wardrobes, modern bathroom. The Heating & Hot Water is also included in the rent. The property is a short walk from Maida Vale Underground Station.

**Tenure:** To be advised  
**Furnished, Part Furnished**

Additional tenant charges apply (fees apply to non-AST tenancies only)  
 Tenancy Agreement Fee: £300  
 References per Tenant/Guarantor: £60  
 Inventory check (approx. £100 – £250 inc. VAT)  
[chestertons.com/property-to-rent/applicable-fees](http://chestertons.com/property-to-rent/applicable-fees)

Energy Efficiency Rating		Current	Potential
Very energy efficient - lower running costs			
(92+) <b>A</b>			
(81-91) <b>B</b>			
(69-80) <b>C</b>			
(55-68) <b>D</b>			
(39-54) <b>E</b>	52	52	
(21-38) <b>F</b>			
(1-20) <b>G</b>			
Not energy efficient - higher running costs			
England, Scotland & Wales		EU Directive 2002/91/EC	

### Chestertons St John's Wood Lettings

122 St John's Wood High Street  
 St John's Wood  
 London  
 NW8 7SG  
[lettings.stjohnswood@chestertons.com](mailto:lettings.stjohnswood@chestertons.com)  
 02030408622  
[chestertons.com](http://chestertons.com)

## Hillsborough Court

Approximate Gross Internal Area  
438 sq ft / 40.71 sq m

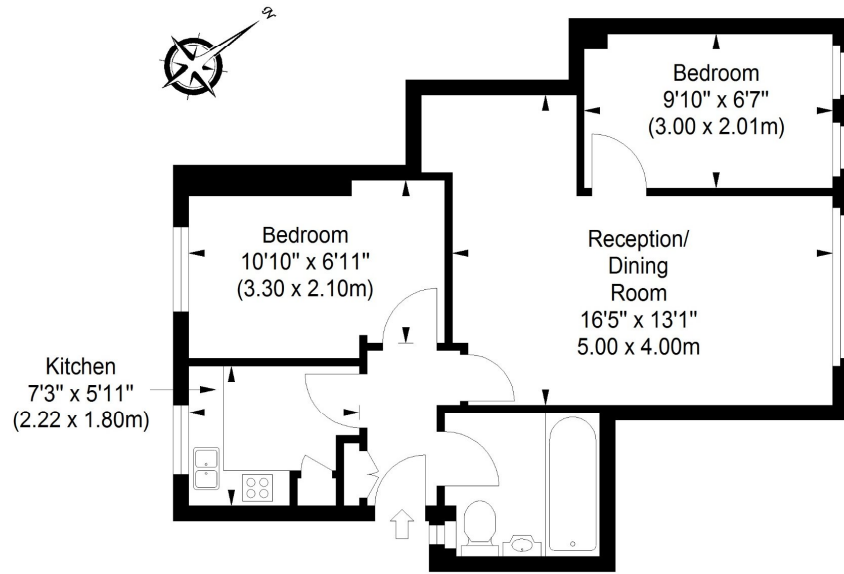

Third Floor

ILLUSTRATION FOR IDENTIFICATION PURPOSES ONLY

ALL MEASUREMENTS ARE MAXIMUM, AND INCLUDE WINDOW BAYS AND WARDROBES WHERE APPLICABLE  
THIS PLAN MUST NOT BE REPRODUCED BY ANY OTHER PERSON WITHOUT PERMISSION