



## 20 Newlands Drive

Cusworth, Doncaster, DN5 8HU

**£150,000**

For sale with NO ONWARD CHAIN is this immaculate and recently renovated two-bedroom semi-detached home. The property offers modern, move-in-ready accommodation, ideal for first-time buyers, small families, or investors. The property features a bright and spacious living area, a contemporary fitted kitchen, two well-proportioned bedrooms, and a modern family bathroom finished to a high standard. Externally, the home benefits from a driveway providing off-street parking and an enclosed rear garden.

Situated in the popular area of Cusworth, the property enjoys excellent access to the A1/M18 motorway network along with a wide range of local amenities, schools, and transport links nearby.

- Recently renovated throughout
- Two good-sized bedrooms
- Modern kitchen and family bathroom
- Enclosed rear garden
- Sought-after location
- Great access to A1/M18 and local amenities
- NO ONWARD CHAIN

### Viewing

Please contact our Office on 01302 751616 if you wish to arrange a viewing appointment for this property or require further information.



## Floor Plan

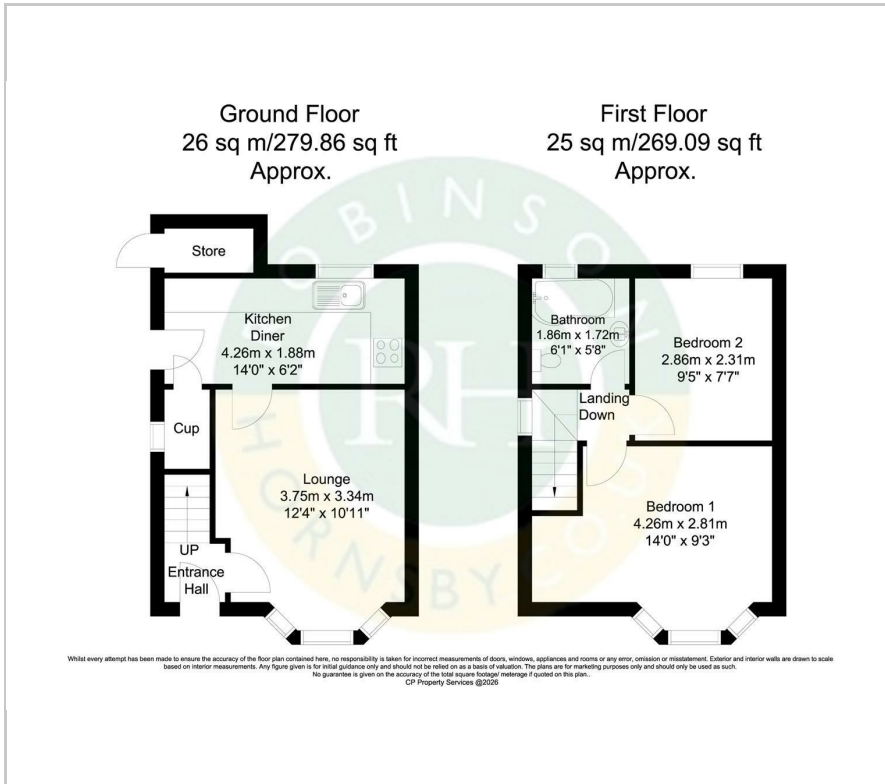

## Area Map



## Energy Efficiency Graph

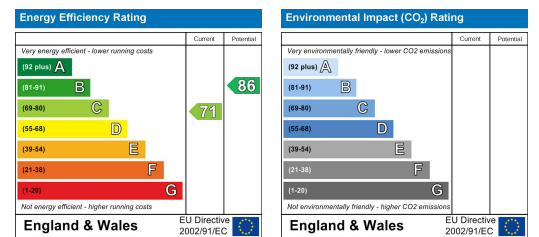

These particulars, whilst believed to be accurate are set out as a general outline only for guidance and do not constitute any part of an offer or contract. Intending purchasers should not rely on them as statements of representation of fact, but must satisfy themselves by inspection or otherwise as to their accuracy. No person in this firm's employment has the authority to make or give any representation or warranty in respect of the property.