



Connells

Holloway Close
Amesbury Salisbury



Property Description

This imposing town house boasts four bedrooms and has an adjacent garage and driveway and corner plot rear garden, There is also a separate study. The property is well-located on this popular development which is within access of the A303 and Salisbury.

Entrance Hall

Doors to study, cloakroom and dining room, stairs to first floor.

Cloakroom

Comprising a wash hand basin and WC.

Study

Front aspect.

Kitchen

Comprising a single drainer sink unit, range of wall and base units with work surfaces over, built in double oven with gas hob unit and hood over, space for washing machine, space for dishwasher, fridge/freezer space, French doors to rear garden.

Dining Area

Built in cupboard, open through to..

First Floor Landing

Stairs to second floor, built in storage cupboard.

Lounge

Front aspect.

Master Bedroom

Size incorporates built in double wardrobe, rear aspect.

Ensuite

Comprising a double shower cubicle with pedestal wash hand basin and WC.

Second Floor Landing

Built in airing cupboard.

Bedroom Two

Size incorporates fitted wardrobe incorporating cupboards and sliding doors, rear aspect.

Bedroom Three

Front aspect.

Bedroom Four

Front aspect.

Bathroom

Comprising a panel enclosed bath with pedestal wash hand basin and WC.

Outside

Corner Plot

A larger garden being mainly laid to lawn with patio area and gated side access leading to the front.

Adjacent Garage

With power and light and eaves storage space. The garage is approached by a widening and secure private driveway.



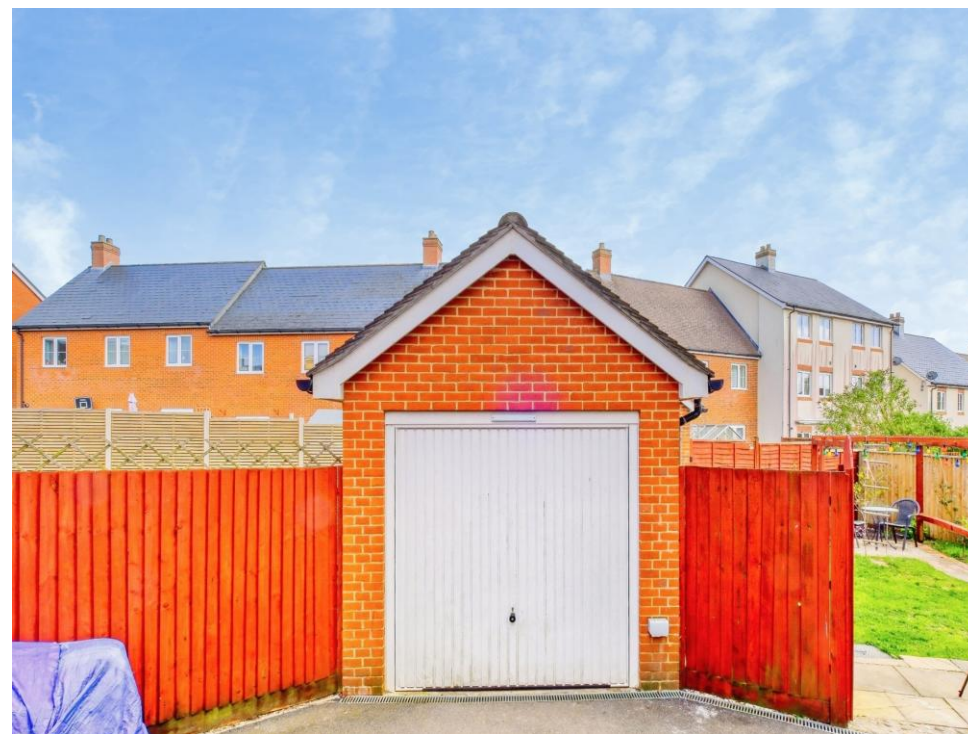



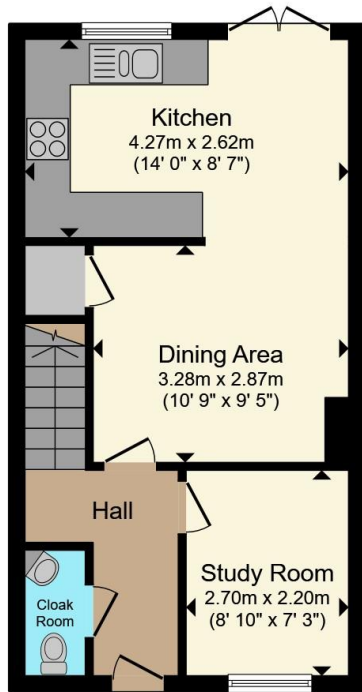

Ground Floor

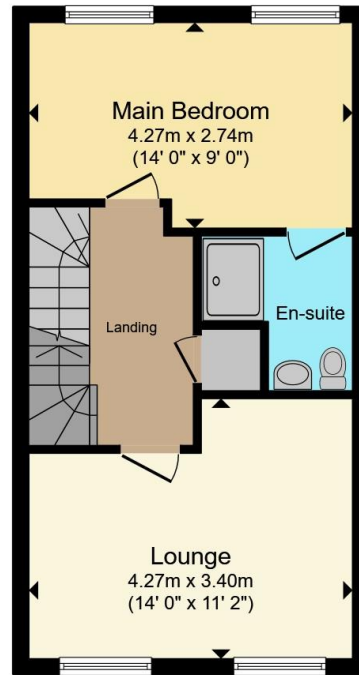

First Floor

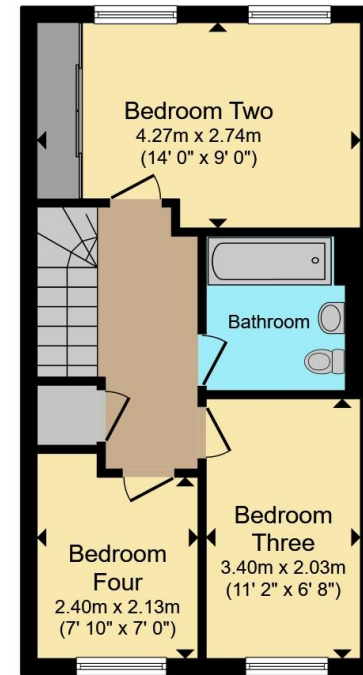

Second Floor

Total floor area 107.2 m² (1,154 sq.ft.) approx

This floor plan is for illustrative purposes only. It is not drawn to scale. Any measurements, floor areas (including any total floor area), openings and orientation are approximate. No details are guaranteed, they cannot be relied upon for any purpose and they do not form part of any agreement. No liability is taken for any error, omission or misstatement. A party must rely upon its own inspection(s). Powered by www.propertybox.io



To view this property please contact Connells on

T 01980 622 662

E amesbury@connells.co.uk

Unit 3 23 Salisbury Street AMESBURY
SALISBURY SP4 7AW

EPC Rating: Council Tax
Awaited Band: E

Tenure: Freehold

view this property online connells.co.uk/Property/ABY308688



1. MONEY LAUNDERING REGULATIONS Intending purchasers will be asked to produce identification documentation at a later stage and we would ask for your co-operation in order that there will be no delay in agreeing the sale. 2. These particulars do not constitute part or all of an offer or contract. 3. The measurements indicated are supplied for guidance only and as such must be considered incorrect. Potential buyers are advised to recheck measurements before committing to any expense. 4. We have not tested any apparatus, equipment, fixtures, fittings or services and it is in the buyers interest to check the working condition of any appliances.

Connells Residential is registered in England and Wales under company number 1489613, Registered Office is Cumbria House, 16-20 Hockliffe Street, Leighton Buzzard, Bedfordshire, LU7 1GN. VAT Registration Number is 500 2481 05.

See all our properties at www.connells.co.uk | www.rightmove.co.uk | www.zoopla.co.uk

Property Ref: ABY308688 - 0005