



LEASEHOLD

Apartment

1 FINELLA HOUSE, 11 FORE STREET, HERTFORD, SG14 1DE

Guide Price

£210,000

FEATURES

- Chain Free
- Prime Town Centre Position On Fore St.
- Large Sash Windows With Shutters Throughout
- Charming One Bedroom First Floor Apartment
- 495 SQ FT
- Generous Double Bedroom With Built-In Wardrobes



Finella House Hertford SG14 1DE

Positioned along Fore Street, this attractive home is perfectly placed to enjoy everything Hertford has to offer, with an excellent selection of bars, restaurants and cafés just moments away. Both Hertford East and Hertford North stations are within easy reach, along with the open green spaces of Hartham Common.

Extending to approximately 495 sq ft, the property combines period charm with modern convenience. The accommodation comprises a welcoming entrance hall leading through to a bright and spacious living/dining room, featuring large sash windows with shutters and an impressive exposed beam that adds real character to the space.

The separate kitchen is well-appointed with integrated appliances, while the bedroom is particularly generous in size, complete with built-in wardrobes, further sash windows with shutters, an exposed beam and a striking chimney breast. A modern shower room is accessed from the entrance hall.

The property also benefits from updated electric heating throughout.

Offered chain free, this apartment would make an ideal first-time purchase or investment opportunity.

Contact Mount & Co. to arrange your viewing.



MOUNT & CO | 2 MARKET PLACE, HERTFORD, HERTFORDSHIRE, SG14 1DF



MOUNT & CO | 2 MARKET PLACE, HERTFORD, HERTFORDSHIRE, SG14 1DF



MOUNT & CO | 2 MARKET PLACE, HERTFORD, HERTFORDSHIRE, SG14 1DF

Call us on

01992 937 011

hello@mountandco.co.uk

<https://www.mountandco.co.uk/>

Council Tax Band

B

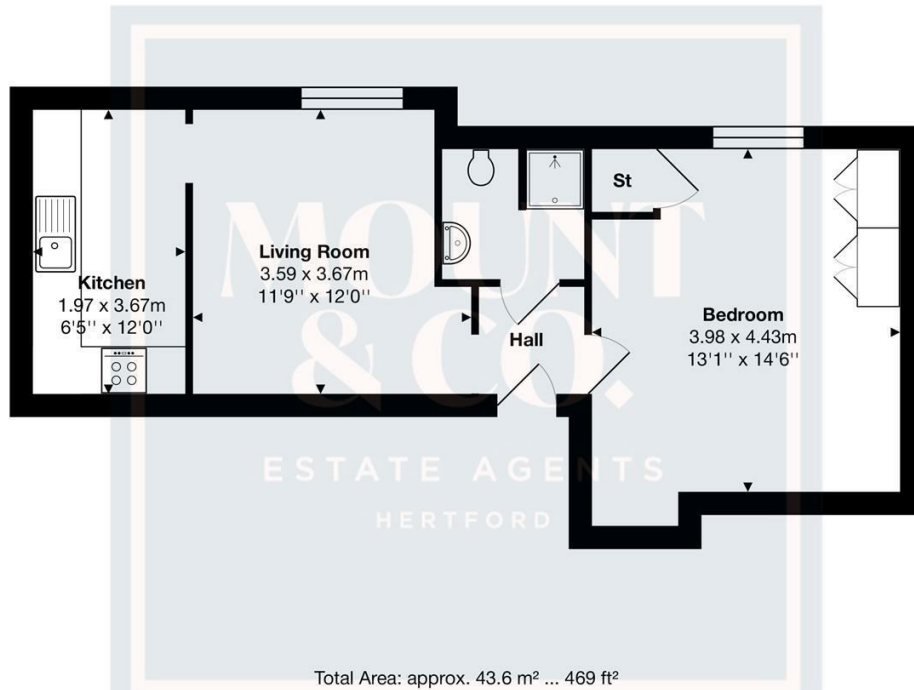

THE FLOORPLAN IS FOR ILLUSTRATIVE PURPOSES ONLY AND IS NOT TO SCALE.

Measurements and features are approximate and may differ from the actual property. Verify all details independently; no liability is accepted for errors or omissions.

Property marketing provided by www.fotomarketing.co.uk

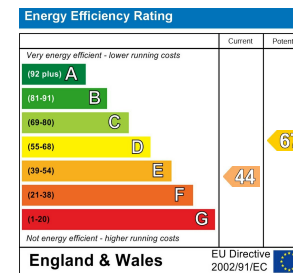

Agents Note: Whilst every care has been taken to prepare these particulars, they are for guidance purposes only. All measurements are approximate and are for general guidance purposes only and whilst every care has been taken to ensure their accuracy, they should not be relied upon and potential buyers are advised to recheck the measurements.