



St. Marys Road, Kettering, NN15 7BL

Kettering

£1,100 pcm

Deposit: £1,100

'New Life'

Situated in the popular town of Kettering and conveniently close to the town centre, this well-presented three-bedroom semi-detached home has been newly decorated throughout, offering fresh, modern living.

The ground floor features a spacious lounge providing a comfortable setting for relaxation, alongside a generous kitchen/diner perfect for everyday family life and entertaining. Upstairs, the property benefits from a modern family bathroom and three well-proportioned bedrooms.

Externally, the home offers a private enclosed rear garden, ideal for outdoor enjoyment, along with a driveway and garage providing ample off-road parking and storage. Access to the garage is conveniently positioned to the right-hand side of the property.

Available now!.

EPC rating: E

Council Tax Band A





Ground Floor

Approx. 32.3 sq. metres (347.5 sq. feet)

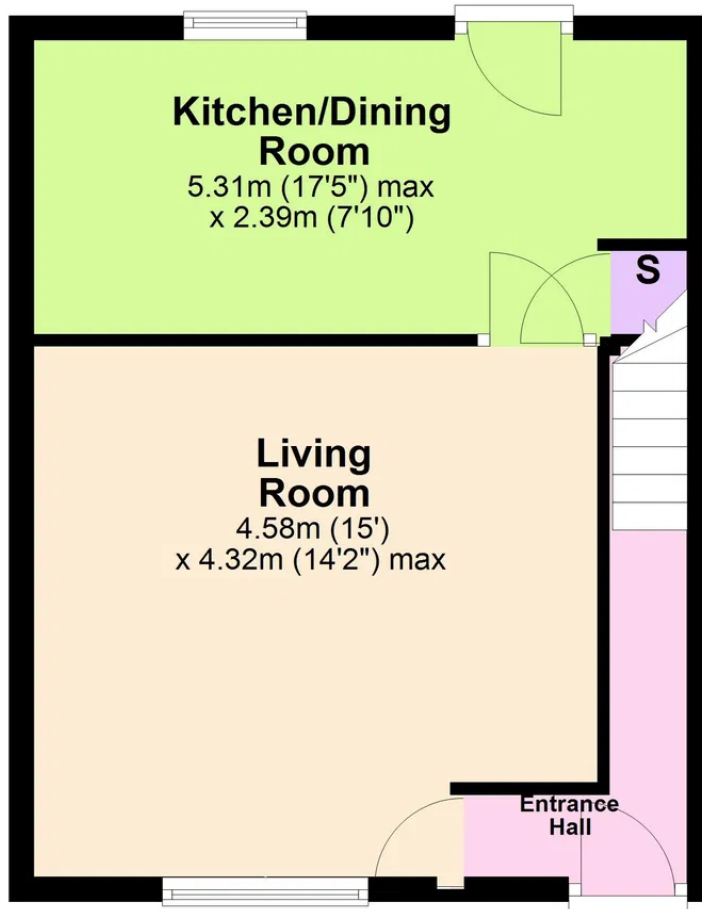

First Floor

Approx. 40.1 sq. metres (431.3 sq. feet)

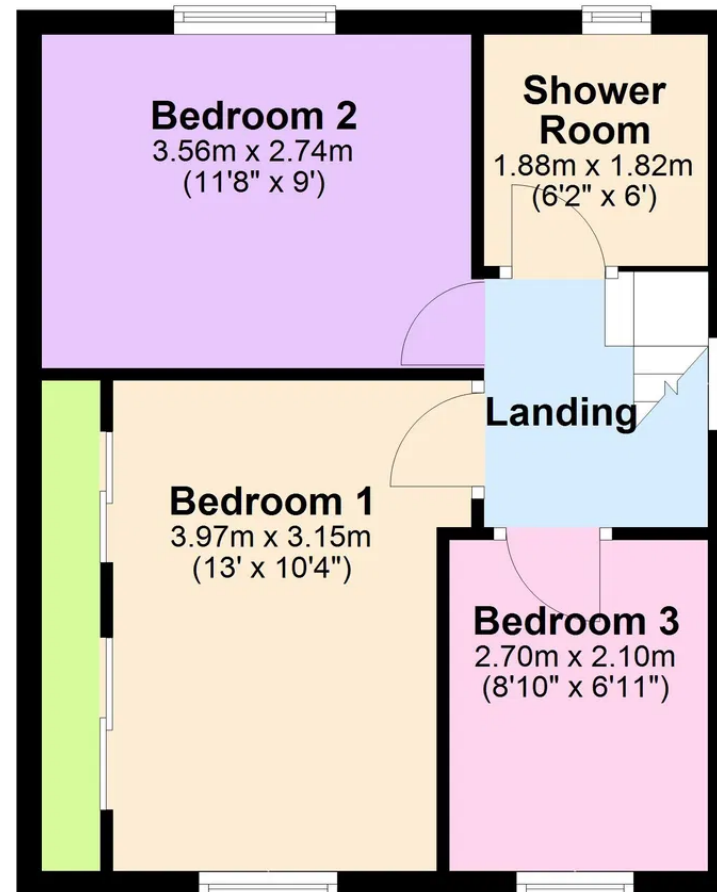

Total area: approx. 72.4 sq. metres (778.8 sq. feet)