



**73 CLAYTON ROAD
CHESSINGTON
KT9 1NQ
£410,000**

EXTENDED TERRACED VICTORIAN COTTAGE

TWO DOUBLE BEDROOMS

13'1 X 9'11 LIVING ROOM

13'1 X 9'10 MODERN KITCHEN

9'10 X 6'8 DINING AREA

GROUND FLOOR BATHROOM

DOUBLE GLAZED WINDOWS

GAS CENTRAL HEATING

32' SOUTHERLY FACING GARDEN

WELL PRESENTED

AN IDEAL FIRST TIME BUY

Ground Floor
40.8 sq.m. (439 sq.ft.) approx.

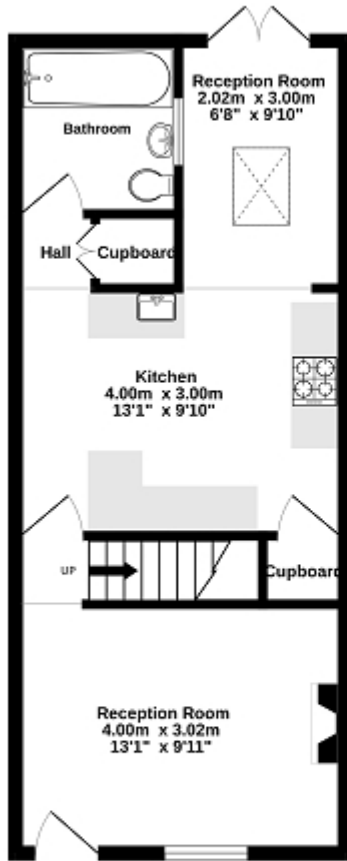

1st Floor
28.8 sq.m. (310 sq.ft.) approx.

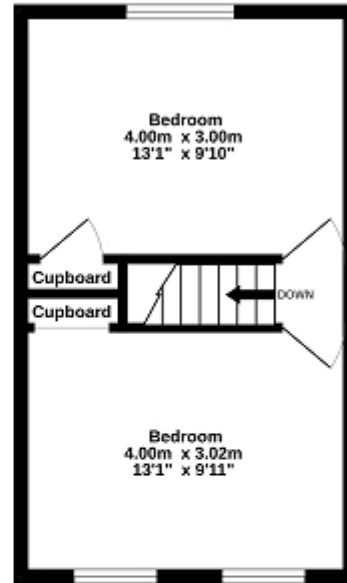

TOTAL FLOOR AREA: 69.6 sq.m. (749 sq ft.) approx.

Whilst every attempt has been made to ensure the accuracy of the floorplan contained herein, measurements of floors, windows, rooms and any other items are approximate and no responsibility is taken for any error, omission or mis-statement. This plan is for illustrative purposes only and should be used as such by any prospective purchaser. The symbols, systems and appliances shown have not been tested and no guarantee as to their availability or efficiency can be given.
Made with the help of CAD.

