



Cambridge Court | 121 London Road | Camberley | GU15 3JY

£1,200 PCM

*Waterfords* W  
Residential Sales & Lettings



GROUND FLOOR  
498 sq.ft. (46.3 sq.m.) approx.

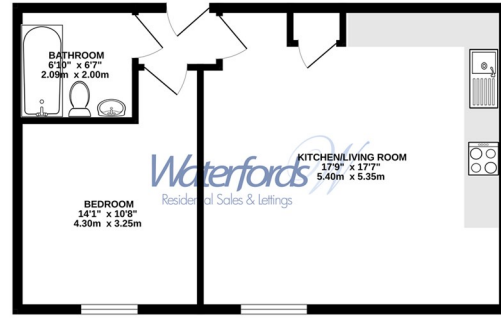

TOTAL FLOOR AREA - 498 sq.ft. (46.3 sq.m.) approx.  
Waterford's Residential Sales & Lettings

Energy Efficiency Rating		Current	Potential
Very energy efficient - lower running costs			
(92 plus)	A		
(81-91)	B		
(69-80)	C	72	72
(55-68)	D		
(39-54)	E		
(21-38)	F		
(1-20)	G		
Not energy efficient - higher running costs			
England & Wales		EU Directive 2002/91/EC	



## Description

A well-presented one-bedroom apartment in Cambridge Court, available to let from August 2026. Offering a bright living area, modern kitchen, double bedroom, and contemporary bathroom, this home is ideal for single occupants or couples seeking comfortable, convenient living. Situated close to local amenities and transport links, the property is offered unfurnished and ready to make your own.

## Key features

- Modern Apartments
- Town centre location
- High specification kitchen including white goods
- Unfurnished
- EPC C
- Conversion from iconic Cambridge Hotel
- Minimum Term 12 Month Let
- Available August
- Council tax band C
- Long term Let



35 Plough Road  
Hampshire  
GU46 7UW  
01276 903006

surreylettings@waterfords.co.uk  
<https://www.waterfords.co.uk/>