



Murray Road, W5

£1,700 Per calendar month

A modern and bright one double bedroom apartment with stylish fittings and lighting. With a large open-plan reception room, kitchen with under floor heating and wood floors throughout, this apartment is very well suited for a single professional or couple.

Murray Road is just under half a mile from South Ealing Underground Station, with easy access to A4, M4 and A406 for drivers.

Features

- One Bedroom
- Large Reception Room
- Open-Plan Kitchen
- Modern Bathroom
- Wood Floors
- Off-Street Parking

Murray Road, London, W5

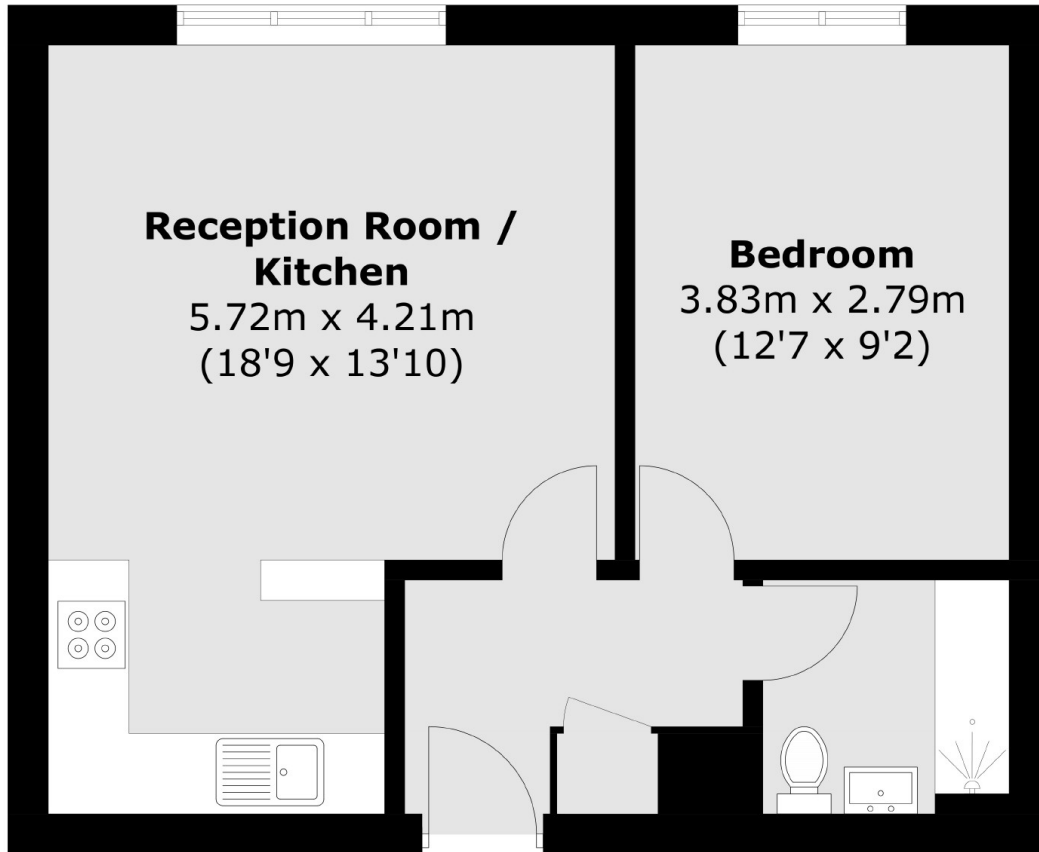

Total area (approx.): 41.0 sq. m (441.3 sq. ft)