



76 Holland Road, Old Whittington, Chesterfield, S41 9HF

Guide Price £200,000

- **** GUIDE PRICE £200,000 - £210,000 ****
- Off street parking
- GCH and Double glazing
- Three Bed Semi Detached
- Popular location with good links to Sheffield and Chesterfield
- Generous lounge
- Viewing is recommended
- Summer house and enclosed rear garden
- Kitchen diner with doors leading into the garden
- Ideal family home o 1st time buyer property

76 Holland Road, Chesterfield S41 9HF

 3  1  1  C

Council Tax Band: B







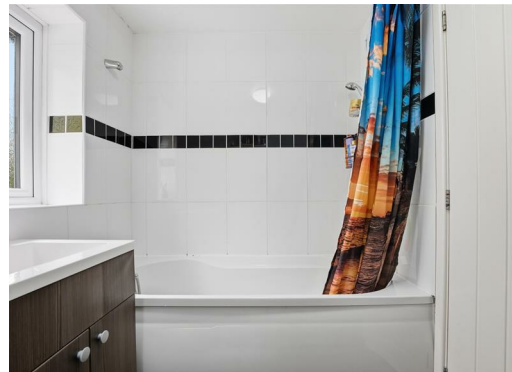



Holland Road, S41

DETAILS
Total area: 852.57 sq ft



Square Box Media
info@squareboxmedia.com
www.squareboxmedia.com

This floorplan is provided without any warranty. The actual size of dimensions may vary and this floorplan is intended for illustrative purposes only.



▼ Ground Floor

TOTAL AREA: 447.87 sq ft

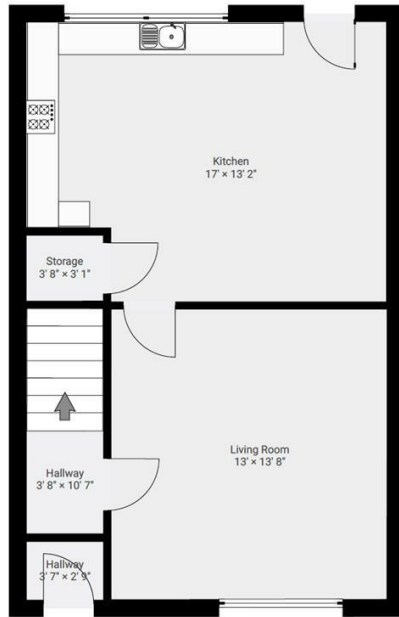

▼ 1st Floor

TOTAL AREA: 404.69 sq ft

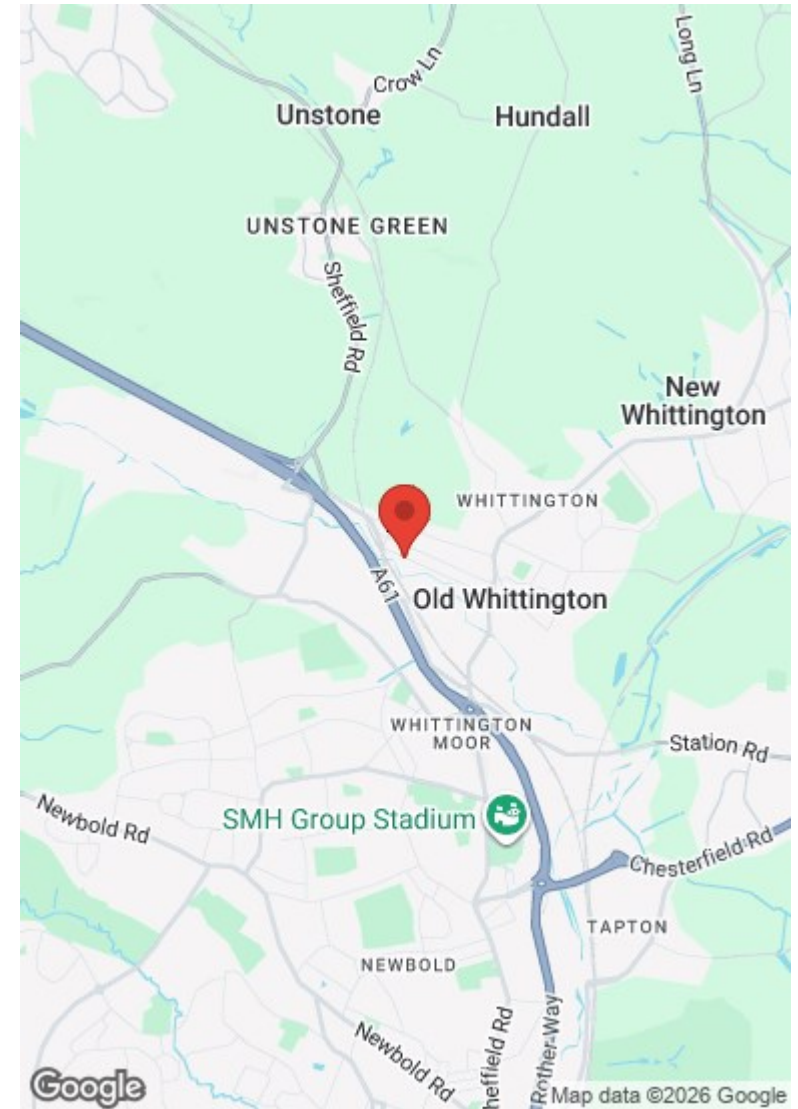
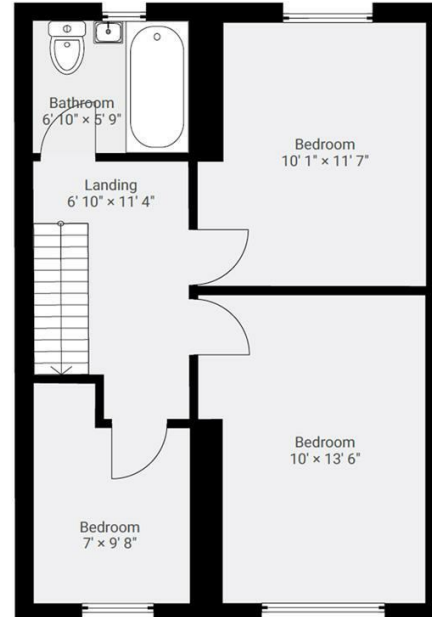

C