



Myra Bank Farm

Wistow Lordship, YO8 3RS

Offers Over £500,000

**** UNEXPECTEDLY BACK TO THE OPEN MARKET ** ****

Detached Farm house property with barns and c4 acres of fenced grazing with 12 stables.

- Equestrian Farm Property
- c4 Acres of Grazing - fenced
- 3 Bedroom DETACHED FARMHOUSE
- Stables
- Barn
- Dog Kennels
- Surrounded by Rural Countryside
- Mature Private Gardens with Fruit Trees
- Gated Driveway Approach
- ****CHAIN FREE ****

Viewing

Please contact us on 01757 709457 if you wish to arrange a viewing appointment for this property or require further information.



Floor Plan

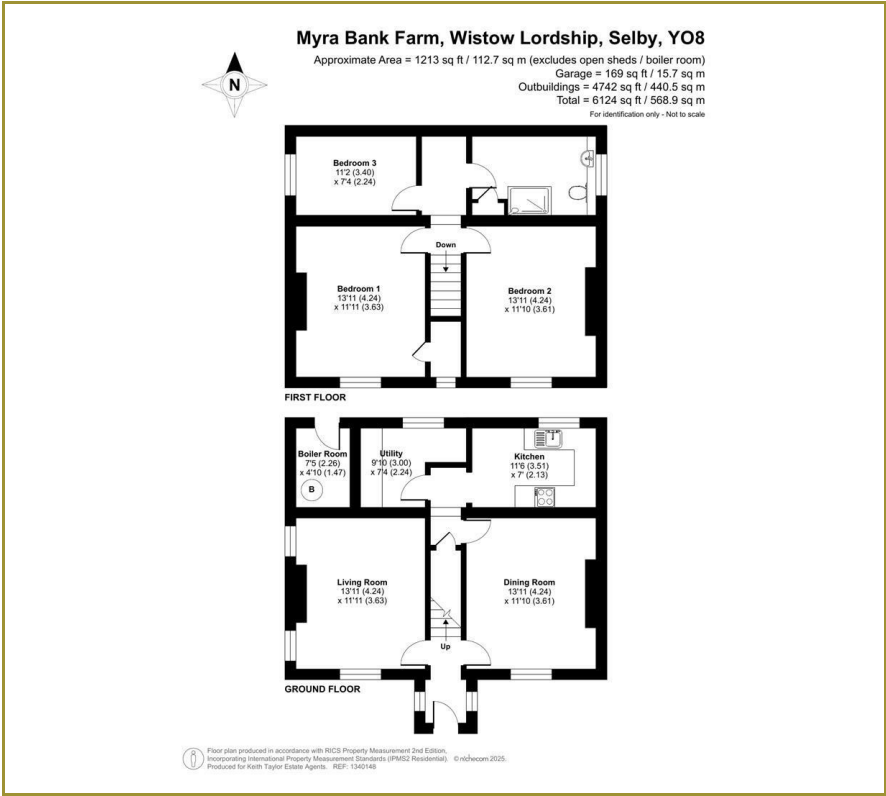

Area Map



Energy Efficiency Graph

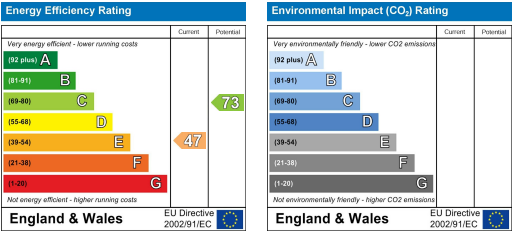

These particulars, whilst believed to be accurate are set out as a general outline only for guidance and do not constitute any part of an offer or contract. Intending purchasers should not rely on them as statements of representation of fact, but must satisfy themselves by inspection or otherwise as to their accuracy. No person in this firm's employment has the authority to make or give any representation or warranty in respect of the property.

Keith Taylor

56 Gowthorpe, Selby, North Yorkshire, YO8 4ET
Tel: 01757 709457 Email: sales@keithtaylorproperty.co.uk
www.keithtaylorproperties.co.uk