



LIVING
RESIDENTIAL



73-75 Carlton Mansions, Chichele Road

Willesden Green, London, NW2 3AP

Asking Price £455,000



Living Residential are pleased to bring to the market this lovely 676sqft two bedroom garden flat. The property is located in this sought after mansion block in NW2, the apartment has a generously sized reception room with wood flooring an open plan kitchen to hallway and the added benefit of direct access to a private garden. Features include high ceilings, two good sized double bedrooms and a family bathroom.

The property is closely located to the social & transport facilities of Willesden Green (Zone 2 - Jubilee Line) There are various independent delis, restaurants and cafés including Costa & Gail's on Walm Lane are within close proximity. The green open spaces of the 86 acre Gladstone Park with its outdoor gym, tennis courts and café are also close by. The property has a share of the freehold with approximately 950 years remaining on the underlying lease, council tax band C - SOLE AGENT.



Floor Plans

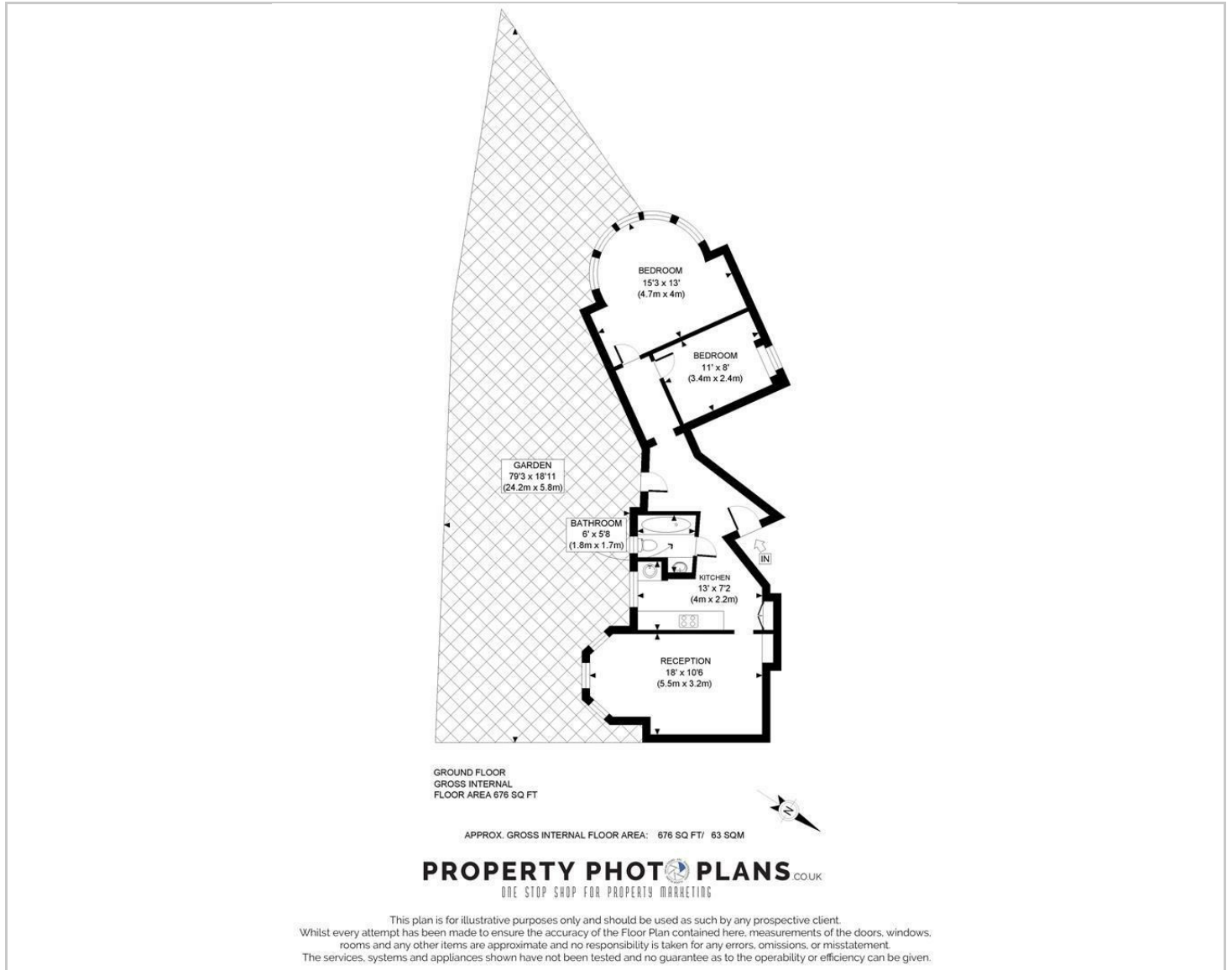

Area Map

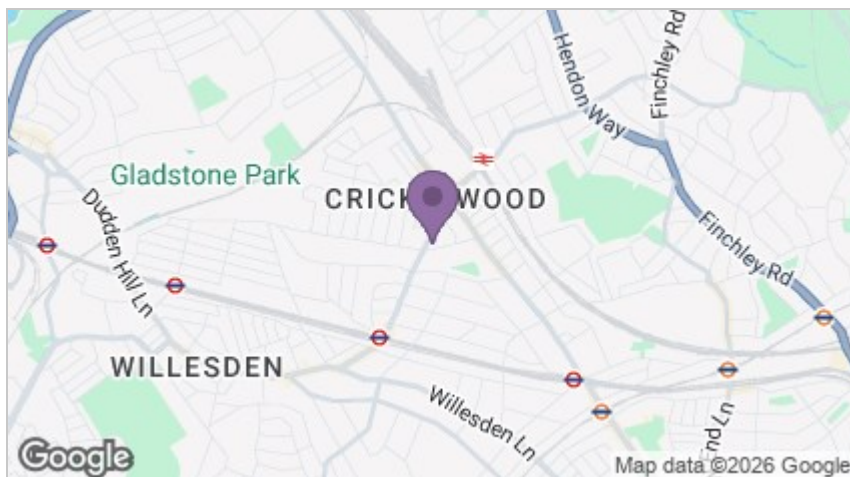

Energy Efficiency Graph

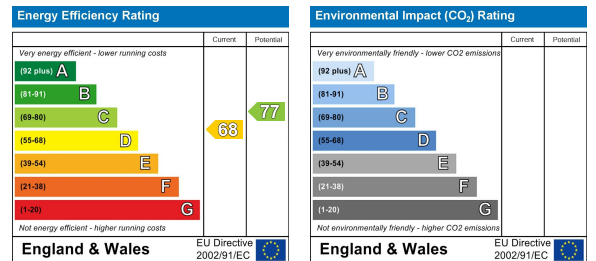

These particulars, whilst believed to be accurate are set out as a general outline only for guidance and do not constitute any part of an offer or contract. Intending purchasers should not rely on them as statements of representation of fact, but must satisfy themselves by inspection or otherwise as to their accuracy. No person in this firm's employment has the authority to make or give any representation or warranty in respect of the property.



Living Residential Estate Agents | 18 Fortune Green Road, London, NW6 1DH

020 7435 6066 | 01923 954884 | enquiries@livingresidential.com | www.livingresidential.com

Living Residential Ltd. Reg No. 4759344. Registered Office Address: 170 Finchley Road, Hampstead, London, NW3 6BP. Registered England and Wales.