

Lugus HOMES



Buckhold Road, London

Asking price £499,999



Located on the second floor, this south-facing apartment offers approximately 620 sq. ft. of well-planned living space with leafy views over King George's Park and modern interiors throughout. Floor-to-ceiling windows provide excellent natural light.

The property features a generous double bedroom with walk-in wardrobe, a stylish contemporary bathroom, and a fully fitted open-plan kitchen with Siemens integrated appliances, opening into a spacious reception and living area. A covered balcony, running the full width of the living space, offers attractive park views.

Bronze is ideally positioned within 0.7 miles of Wandsworth Town Station and 1 mile from Southfields Station, with regular bus services nearby. Southside Shopping Centre, Old York Road cafés, and excellent green spaces are all close at hand.

Further benefits include a seven-day concierge, a residents' roof garden, and secure bicycle storage.



Area Map

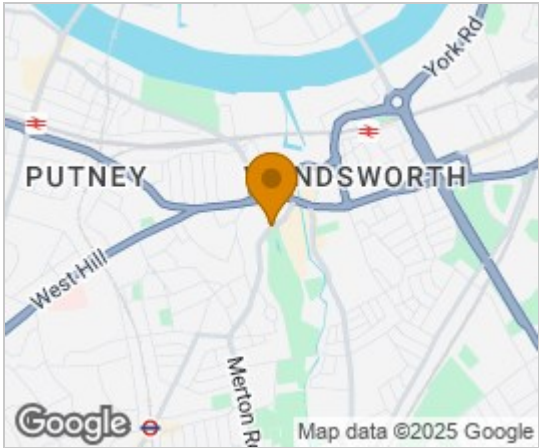

Floor Plans

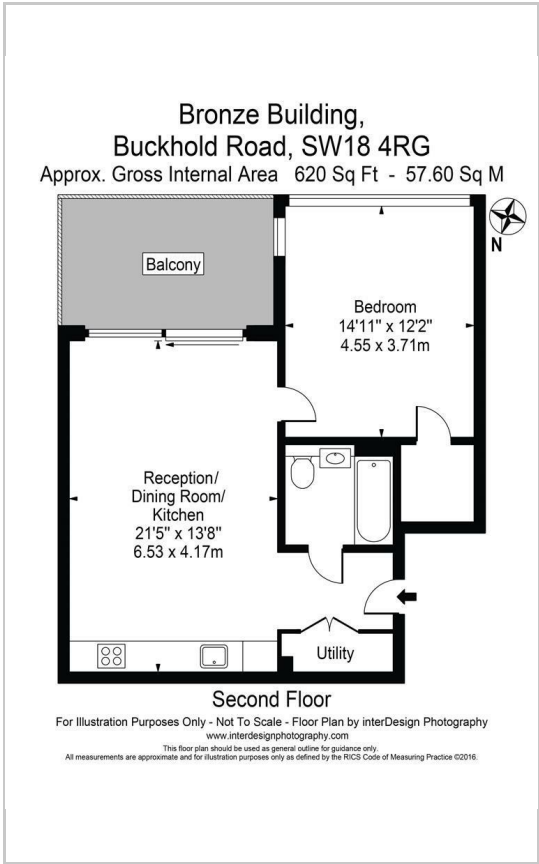

Energy Efficiency Graph

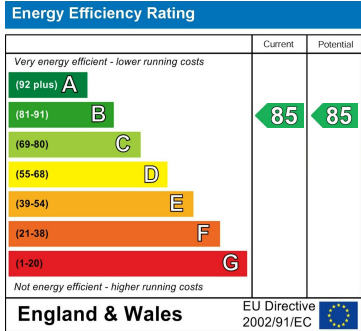

These particulars, whilst believed to be accurate are set out as a general outline only for guidance and do not constitute any part of an offer or contract. Intending purchasers should not rely on them as statements of representation of fact, but must satisfy themselves by inspection or otherwise as to their accuracy. No person in this firms employment has the authority to make or give any representation or warranty in respect of the property.