



Leander Court, Stakeford, Choppington, NE62 5BT

Offers Over £135,000

Harpers POWERED BY **exp** UK
property people

Bedrooms: 2 | Bathrooms: 1 | Receptions: 1

An attractive two-bedroom semi-detached home, ideally situated in a desirable cul-de-sac on the fringes of the Wansbeck Estate in Stakeford, perfect for an ideal first home. The property features a modern kitchen complete with a breakfast bar, creating a functional and inviting space. Adjacent to this, a good-sized living room provides a comfortable area for relaxation and entertaining. Upstairs, you will find two bedrooms and a convenient first-floor bathroom. Externally, the residence benefits from an enclosed, low-maintenance courtyard garden with gated side access, offering a private outdoor retreat. A driveway to the front provides excellent off-street parking. Located close to local amenities and offered with no onward chain, this property presents a fantastic opportunity for a smooth and straightforward move.

- Semi-Detached Home
- Two Bedrooms & First Floor Bathroom
- Modern Kitchen With Breakfast Bar
- Good-Sized Living Room
- Enclosed Low Maintenance Garden With Gated Side Access
- Driveway To Front
- Desirable Cul-De-Sac Location
- Close To Amenities
- No Onward Chain
- Ideal First Home



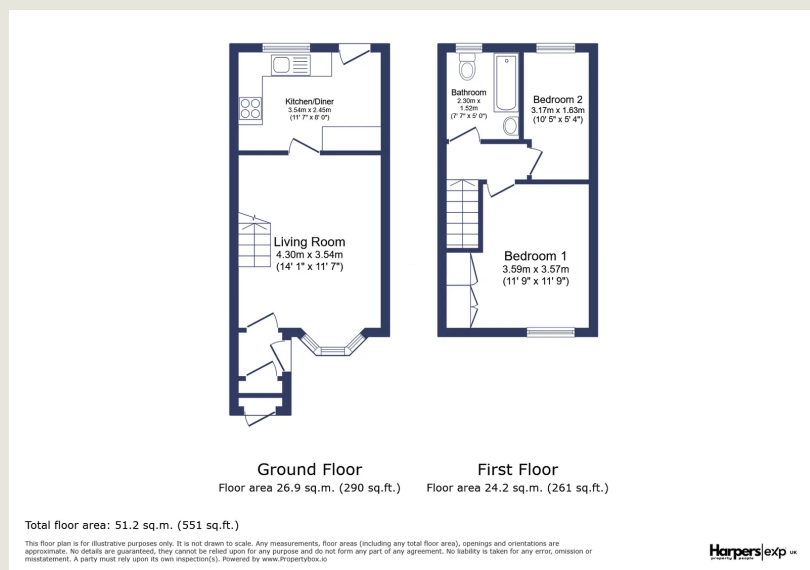

Harpers Property People

80 Windsor Gardens, Bedlington, NE22 5SY

07813 673 606

ali@harpersproperty.com

<https://harpersproperty.com>

Harpers POWERED BY **exp** TM **UK**
property people