

27 Deenethorpe Village
East Northamptonshire
Northamptonshire
NN17 3EP

£625,000

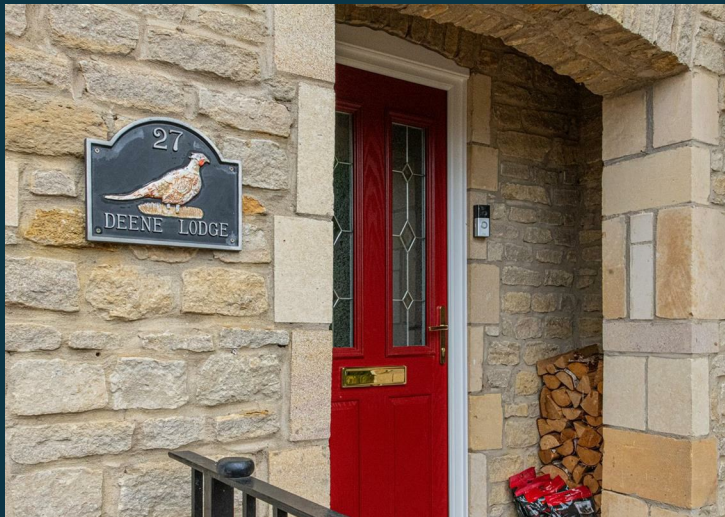

OSCAR JAMES

...expect excellence



WHAT'S GREAT?

"Modern Comfort Meets Country Charm"- Located in the peaceful village setting of Deenethorpe, this lovely detached home enjoys far-reaching countryside views, generous living space, and a beautifully landscaped wrap-around garden. Built in the late 1990s, it combines charm & style with modern comfort, including high speed broadband and Hive-controlled heating and hot water.

The welcoming & spacious entrance hall leads to a cloakroom/WC and three reception rooms. The lounge features a stylish Aegean Limestone fireplace with multi-fuel burner and opens via double doors to the conservatory, which benefits from underfloor heating and electric roof vents. This bright, versatile space offers panoramic garden and field views and is ideal for dining or entertaining. The sitting/dining room features bespoke fitted bookshelves and also connects to the conservatory.

The impressive kitchen/breakfast room is fitted with elegant Farrow & Ball "Dropcloth" cabinetry, granite worktops, and a large central island with breakfast bar. Integrated

appliances include an induction range cooker, dishwasher, microwave, and wine cooler, with space for an American-style fridge/freezer. Glazed double doors lead to the boot room with matching granite-topped units, which in turn connects to the utility room with fitted furniture, sink, and garden access.

A turning staircase rises to a light-filled landing and four double bedrooms. The main bedroom offers a dressing area, bespoke walk-in wardrobe, and a stylish en-suite with electric underfloor heating and walk-in double shower. Bedroom two also benefits from fitted storage and its own en-suite. Two further bedrooms enjoy delightful countryside outlooks, complemented by a modern family bathroom.

Outside, the home sits in an elevated position with a great degree of privacy. A block-paved driveway offers ample off-road parking and access to the sizeable double garage.

Given the space on offer, this home would work incredibly well for families.

...expect excellence

Floor Plan

GROUND FLOOR
1584 sq.ft. (147.2 sq.m.) approx.

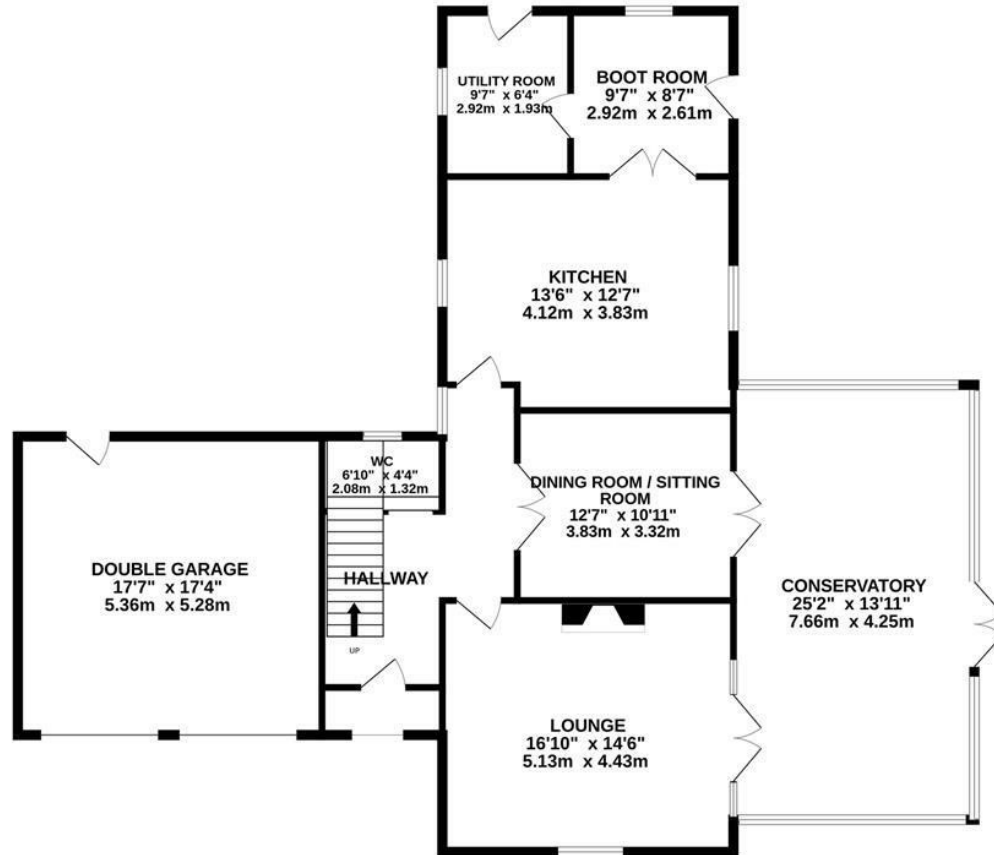

1ST FLOOR
1080 sq.ft. (100.3 sq.m.) approx.

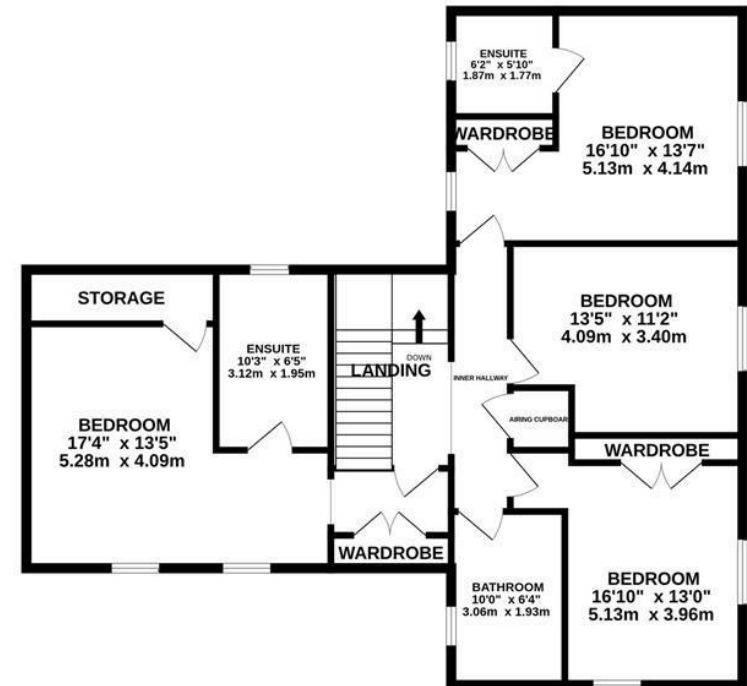

TOTAL FLOOR AREA : 2664 sq.ft. (247.5 sq.m.) approx.

Whilst every attempt has been made to ensure the accuracy of the floorplan contained here, measurements of doors, windows, rooms and any other items are approximate and no responsibility is taken for any error, omission or mis-statement. This plan is for illustrative purposes only and should be used as such by any prospective purchaser. The services, systems and appliances shown have not been tested and no guarantee as to their operability or efficiency can be given.

Made with Metropix ©2025



AT A GLANCE...



Versatile floorplan with multiple reception rooms to the ground floor



Four sizeable double bedrooms



Fantastic garden spaces, which surround the property and enjoy field views too



Kitchen/breakfast room with ample storage options, plus a separate utility & boot room



Multiple options with main family bathroom, two bedroom ensuite and a ground floor WC too



Plentiful off road parking on the large driveway, with also a double garage too





SELLER'S SECRET

The house is incredibly spacious throughout, and so would be great for families. It's a very peaceful setting in Deenethorpe, and the plot of the house offers great privacy and lovely countryside views across the fields!



Why we like it....

This impressive home offers space in abundance with a versatile floorplan offering multiple reception rooms. With all of the bedrooms being double in size, great storage options on offer, and two of the bedrooms benefitting from separate ensuites, on top of the main bathroom and ground floor WC, flexible living is very much of offer here.

To buy or not to buy....

OSCAR JAMES

1a Spencer Court | Corby | NN17 1BH

01536 400900

www.oscar-james.com
