



# VILLAGE ESTATES

• EST.1993 •



93 Main Road, Sidcup, Kent DA14 6ND

Tel: 0208 302 1002

www.village-estates.com

Email: sidcup@village-estates.com



**GROUND FLOOR APARTMENT**

**OPEN PLAN LIVING AREA**

**CLOSE TO ALL AMENITIES**

**STUNNING PRESENTATION**

**PRIVATE GARDEN**

**ALLOCATED PARKING**



**1 Orme Court**  
**The Crescent**  
Sidcup, DA14 6NW

**£295,000**

**STUNNING ONE BEDROOM GROUND FLOOR APARTMENT OFFERED WITH NO ONWARD CHAIN!** Based just a short walk from Sidcup High Street and all local amenities is this spacious and well-presented one bedroom property. This exceptional home offers a large double bedroom, modern bathroom and plenty of storage in the generous hallway. The open plan kitchen / living area offers a fantastic place to relax and unwind, also finished to a great standard. There are double doors from the living area, stepping out onto its own private garden, providing a great outdoor space for the next owners to enjoy. We highly recommend viewing early to avoid disappointment.



**Orme Court, Sidcup, DA14**

Approximate Gross Internal Area = 44.4 sq m / 478 sq ft

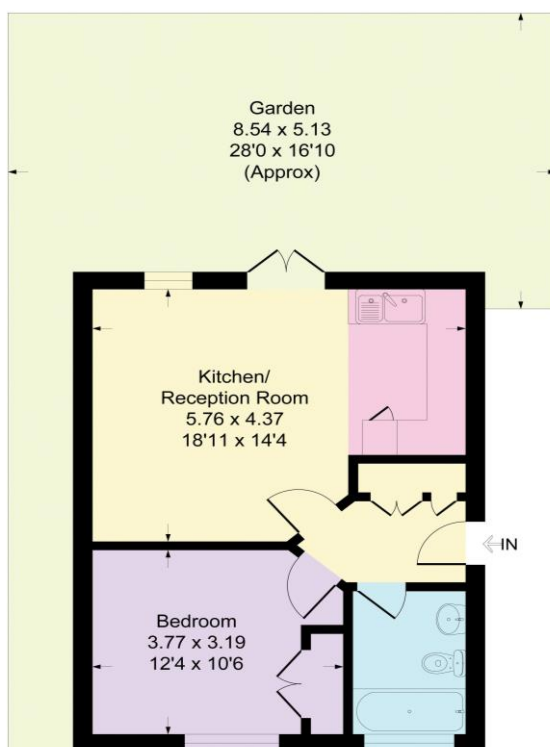

**CONSUMER PROTECTION FROM UNFAIR TRADING REGULATIONS 2008**

Please note that any services, heating system or appliances have not been tested, and no warranty can be given or implied as to their working order. You are advised to obtain verification from your solicitor or surveyor. References to the tenure of a property are based on information supplied by the seller. We have not had sight of the title documents and a buyer is advised to obtain verification from their solicitor. Items shown in photographs are not included unless specifically mentioned within the sales particulars, but may be available by separate negotiation. Whilst every attempt has been made to ensure the accuracy of the floor plan contained here, measurements of doors, windows, rooms and any other items are approximate and no responsibility is taken for any error, omission, or mis-statement. We advise you to book an appointment to view before embarking on any journey to see a property, and check its availability. The accuracy of these details are not guaranteed and they do not form part of the contract.