



4 Bed  
House

located in  
Warning Tongue  
Lane, Doncaster

Asking Price £750,000



**Moss**  
PROPERTIES

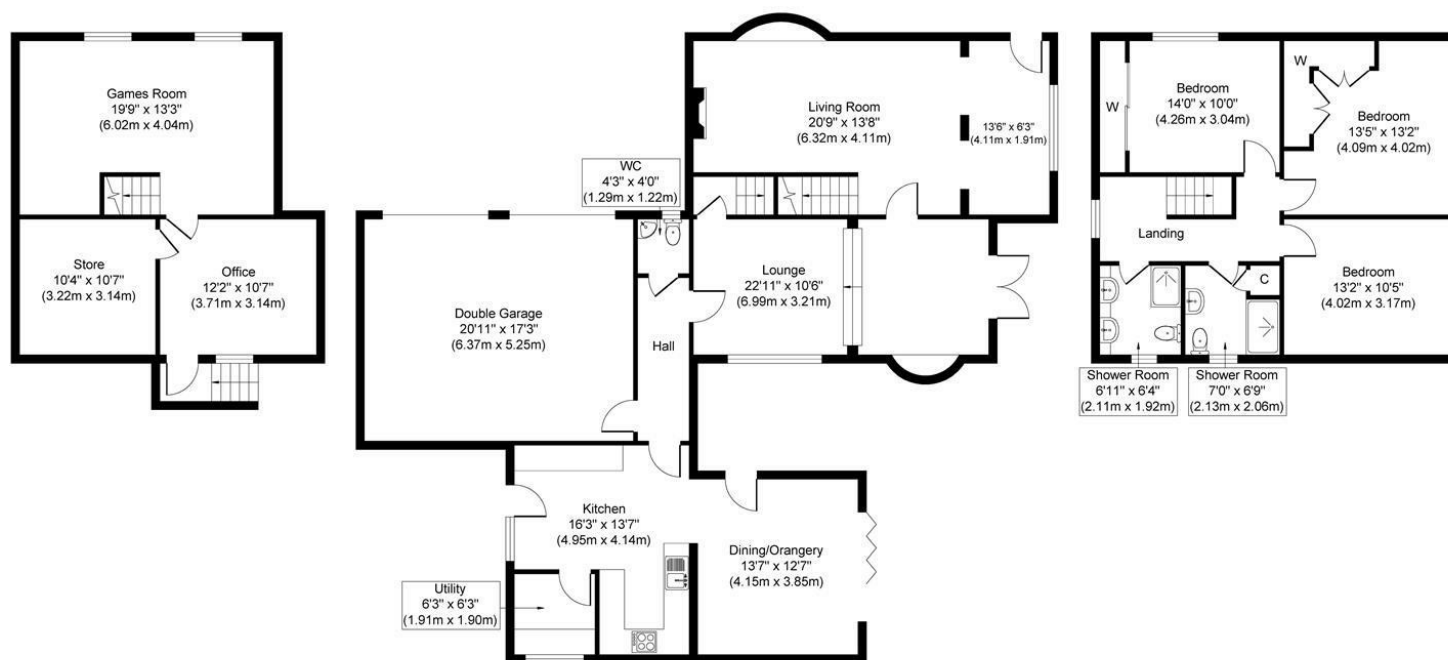

**Basement**  
Approximate Floor Area  
516 sq. ft  
(47.91 sq. m)

**Ground Floor**  
Approximate Floor Area  
1477 sq. ft  
(137.22 sq. m)

**First Floor**  
Approximate Floor Area  
673 sq. ft  
(62.55 sq. m)

CONTACT

White Rose Way  
Doncaster  
South Yorkshire

E: info@mossspm.co.uk  
T: 01302 730077  
www.mossspm.co.uk

Whilst every attempt has been made to ensure the accuracy of the floor plan contained here, measurements of doors, windows, rooms and any other items are approximate and no responsibility is taken for any error, omission, or mis-statement. The measurements should not be relied upon for valuation, transaction and/or funding purposes. This plan is for illustrative purposes only and should be used as such by any prospective purchaser or tenant. The services, systems and appliances shown have not been tested and no guarantee as to their operability or efficiency can be given.

Copyright V360 Ltd 2026 | www.houseviz.com

Energy Efficiency Rating		Current	Potential
Very energy efficient - lower running costs			
(92 plus) <b>A</b>			
(81-91) <b>B</b>			
(69-80) <b>C</b>			
(55-68) <b>D</b>			
(39-54) <b>E</b>		58	73
(21-38) <b>F</b>			
(1-20) <b>G</b>			
Not energy efficient - higher running costs			
<b>England &amp; Wales</b>		EU Directive 2002/91/EC	

