



Jacana Court, Star Place, London, E1W 1AH



Jacana Court, London, E1W

Leasehold (969 years remaining)

A refined waterside residence overlooking the tranquil waters of St Katharine Docks. This beautifully appointed apartment combines contemporary living with maritime serenity, featuring floor-to-ceiling glazing, premium finishes, and a private balcony with harbour views

Key Features

- 2 Double bedrooms, 2 Bathrooms
- 2 Large balconies
- Moments from Tower Bridge
- Council Tax: **G**
- Service Charge: **£2,428.40**
- Ground Rent: **£150**
- Excellent transport links
- EPC: **B**



Situated in the heart of St Katharine Docks, this exceptional two-bedroom apartment at Jacana Court offers a rare opportunity to embrace waterside living in one of London's most distinguished historic marinas. The development stands as a contemporary landmark within this peaceful enclave, where the gentle movement of moored boats and shimmering waters create an atmosphere of calm removed from the city's pace.

Spanning over 1,000 square feet, the residence is defined by its abundant natural light and elegant proportions. Floor-to-ceiling windows and doors frame captivating views across the harbour, flooding the interior with light throughout the day. Hardwood flooring flows seamlessly through the lounge, while the thoughtfully designed kitchen features built-in AEG appliances that combine functionality with refined aesthetics. Two large equal sized private balconies extends the living space and two bedrooms on the far side, providing an idyllic vantage point to observe the ever-changing marina scene and enjoy moments of tranquillity against the backdrop of still waters and passing vessels.









Jacana Court, E1W

Approximate Gross Internal Area = 97.0 sq m / 1044 sq ft

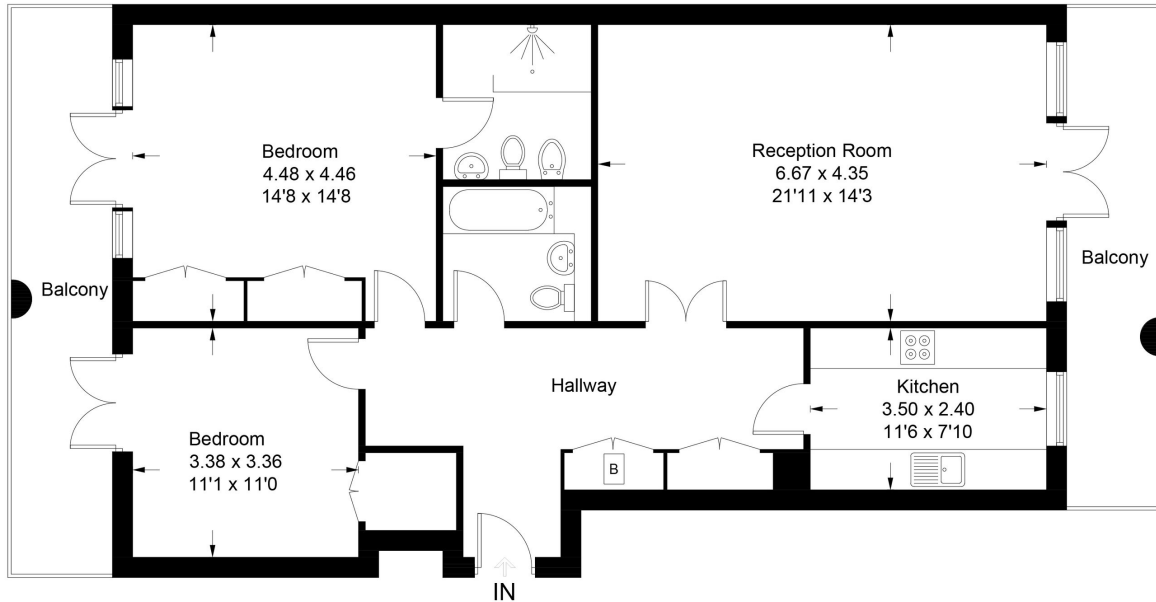

First Floor

Illustration for identification purposes only, measurements are approximate, not to scale. Fourlabs.co © (ID1307835)