

# Regent House

B E D M I N S T E R

APPROXIMATE FLOOR AREA

52.06 SQM / 560.39 SQFT

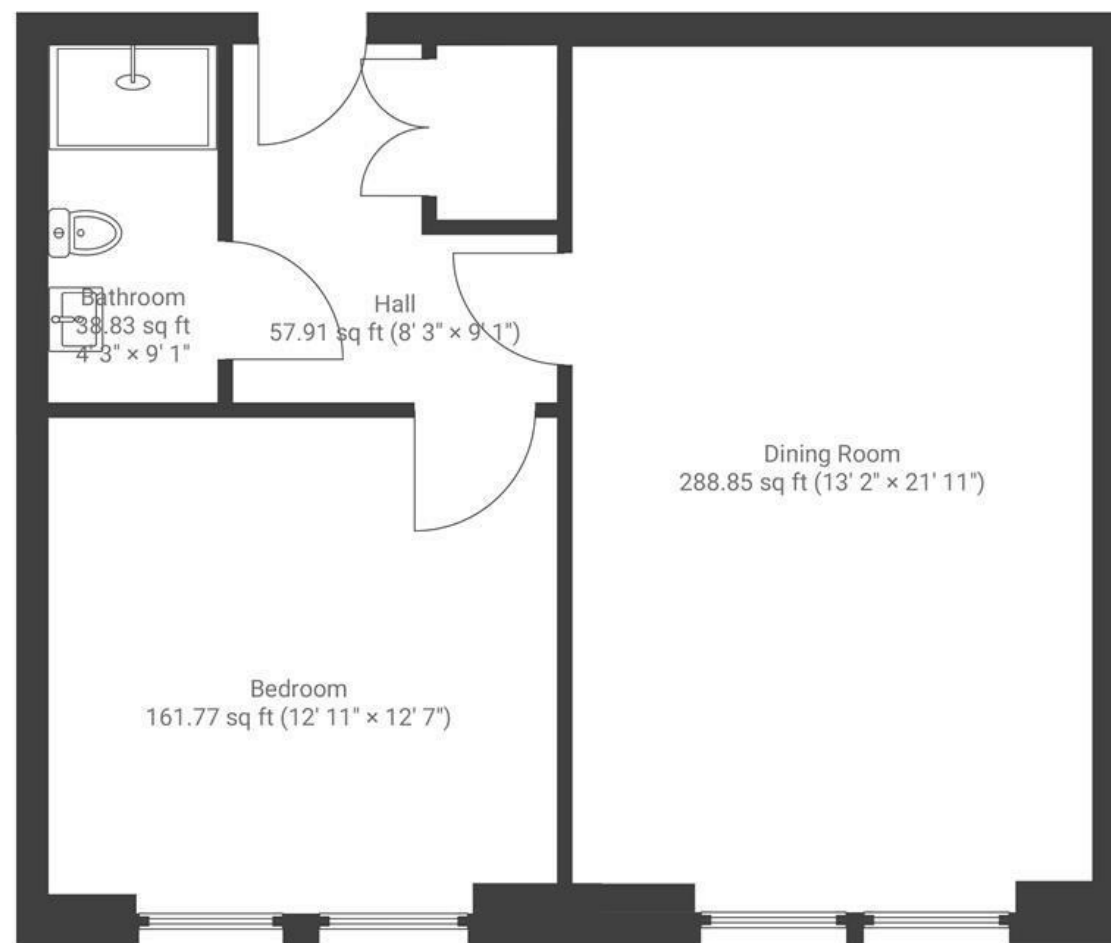

FIRST FLOOR

**Boardwalk**

# Lombard Street

BEDMINSTER, BRISTOL



£260,000



BS3 1FT



1 Bedrooms



1 Bathrooms

*"I've really loved living here – the flat has so much character from the 1800s mixed with modern touches. Being just a short walk to the Harbourside, North Street and Victoria Park has made it such a great place to call home."*

