

for sale

offers in excess of **£190,000**



## Maple Close Shaftesbury SP7 8RF

No onward chain. Three-bedroom end-of-terrace house in the popular town of Shaftesbury. The property offers a kitchen, lounge with conservatory, three bedrooms and a bathroom. Gardens to front and low-maintenance rear, plus a garage en bloc.



# Maple Close Shaftesbury SP7 8RF

## Entrance Hall

Stairs to the first floor and a storage cupboard.

## Kitchen

Double glazed window to the front, fitted kitchen with wall and base units, stainless steel sink and drainer, electric oven and hob, space for an under-counter fridge/freezer and plumbing for a washing machine (current vendors leaving the appliances).

## Lounge

Double glazed window to the rear, double glazed patio doors into the conservatory, electric fireplace and a night storage heater.

## Conservatory

Double glazed doors on to the garden and space for a tumble dryer (which is staying).



## **Landing**

Airing cupboard, night storage heater and access to the loft.

## **Bedroom One**

Double glazed window to the rear and a built-in wardrobe.

## **Bedroom Two**

Double glazed window to the front.

## **Bedroom Three / Study**

Double glazed window to the rear and cupboard over the stairs.

## **Bathroom**

Double glazed window to the front, bath, WC and a wash hand basin.

## **Front Garden**

Pathway to the front door with the remainder laid to lawn with access to the rear garden.

## **Rear Garden**

The rear garden is laid to paving and gravel with flower beds, green house and side access to the front and a gate to the rear.

## **Garage**

There is a garage en bloc.



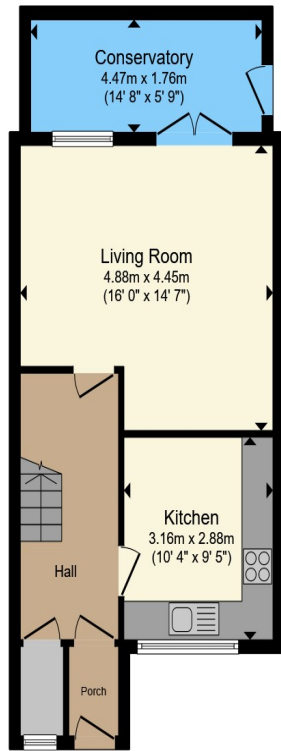

**Ground Floor**

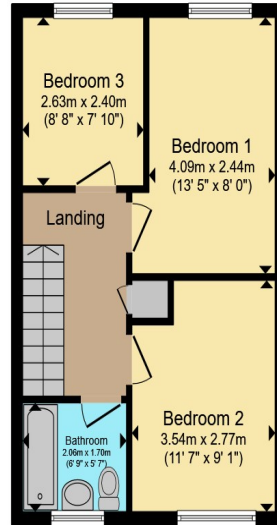

**First Floor**

Total floor area 86.9 m<sup>2</sup> (935 sq.ft.) approx

This floor plan is for illustrative purposes only. It is not drawn to scale. Any measurements, floor areas (including any total floor area), openings and orientation are approximate. No details are guaranteed, they cannot be relied upon for any purpose and they do not form part of any agreement. No liability is taken for any error, omission or misstatement. A party must rely upon its own inspection(s). Powered by www.propertybox.io



To view this property please contact Connells on

**T 01747 854001**  
**E shaftesbury@connells.co.uk**

34 High Street  
 Shaftesbury  
 SP7 8JG

Property Ref: SFT306305 - 0008

Tenure: Freehold EPC Rating: E

Council Tax Band: B

**view this property online**  
**connells.co.uk/Property/SFT306305**



1. MONEY LAUNDERING REGULATIONS Intending purchasers will be asked to produce identification documentation at a later stage and we would ask for your co-operation in order that there will be no delay in agreeing the sale. 2. These particulars do not constitute part or all of an offer or contract. 3. The measurements indicated are supplied for guidance only and as such must be considered incorrect. Potential buyers are advised to recheck measurements before committing to any expense. 4. We have not tested any apparatus, equipment, fixtures, fittings or services and it is in the buyers interest to check the working condition of any appliances.

Connells Residential is registered in England and Wales under company number 1489613, Registered Office is Cumbria House, 16-20 Hockliffe Street, Leighton Buzzard, Bedfordshire, LU7 1GN. VAT Registration Number is 500 2481 05.

see all our properties at [www.connells.co.uk](http://www.connells.co.uk) | [www.rightmove.co.uk](http://www.rightmove.co.uk) | [www.zoopla.co.uk](http://www.zoopla.co.uk)