

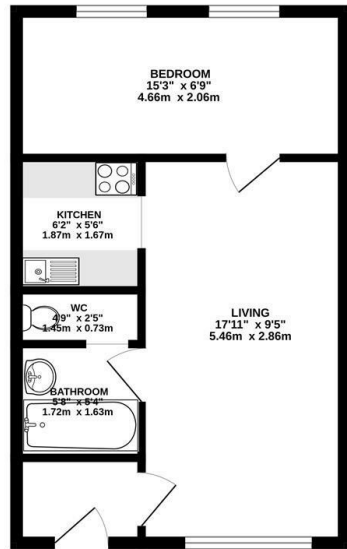

## 198, Chancellor Court Bensham Manor Road, Thornton Heath, Offers In The Region Of £200,000

- One bedroom first floor flat
- Seperate Kitchen
- Walking distance to Thornton Heath Station
- Ideal for first-time buyers or investors
- Spacious living room
- Bathroom
- Good transport links into Central London
- Well-proportioned double bedroom
- Practical and well-laid-out
- Close to local shops and amenities

GROUND FLOOR



Whilst every attempt has been made to ensure the accuracy of the floorplan contained here, measurements of doors, windows, rooms and any other items are approximate and no responsibility is taken for any error, omission or misstatement. This plan is for illustrative purposes only and should be used as such to any prospective purchaser. The services, systems and appliances shown have not been tested and no guarantee as to their operability or efficiency can be given.  
Made with iMagine 12/2025

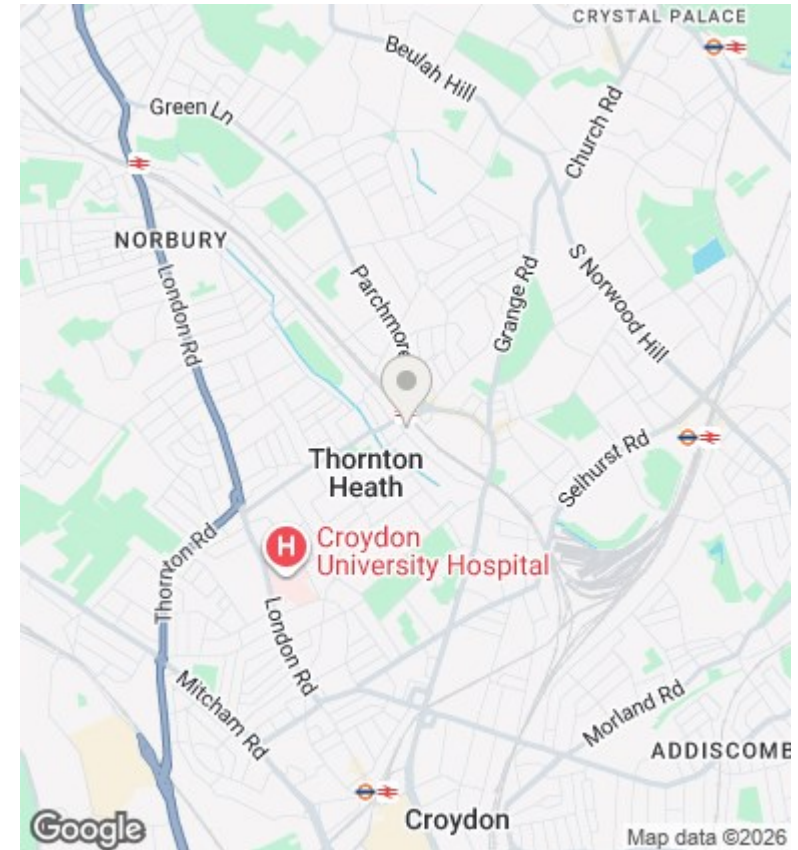

## Directions

Code to enter: 9518

## Viewings

Viewings by arrangement only. Call 0208 681 8133 to make an appointment.

## Council Tax Band

B

## EPC Rating:

C

Energy Efficiency Rating		Current	Potential
<i>Very energy efficient - lower running costs</i>			
(92 plus) <b>A</b>			
(81-91) <b>B</b>			
(69-80) <b>C</b>		69	70
(55-68) <b>D</b>			
(39-54) <b>E</b>			
(21-38) <b>F</b>			
(1-20) <b>G</b>			
<i>Not energy efficient - higher running costs</i>			
<b>England &amp; Wales</b>		EU Directive 2002/91/EC	