



31 Thomas Street, Glossop, Derbyshire, SK13 8QN

**** SEE OUR VIDEO TOUR **** Tucked away at the head of a cul-de-sac, one of only two, individually built detached bungalows, offering surprisingly spacious living space, arranged over two floors and for sale with No Onward Chain. The property, which stands in a large plot, briefly comprises of an entrance hall, a 23ft x 15ft living room, conservatory, separate dining room/study, fitted kitchen with a range cooker and a ground floor master bedroom with an en-suite bathroom. Upstairs in the attic space, there are two more bedrooms and a bathroom with shower. Gated driveway, stone built work shop and gardens store, ample parking space and South facing patio and gardens. Energy Rating C

£450,000

Viewing arrangements

Viewing strictly by appointment through the agent

44 High Street West, Glossop, Derbyshire, SK13 8BH 01457 858888

GROUND FLOOR

Entrance Hall

Pvc double glazed front door, understairs cupboard, cloaks cupboard, central heating radiator, spindled stairs leading to the first floor and doors leading off to:

Living Room

23'0 x 15'9

Pvc double glazed front bow window, two central heating radiators, gas living flame fire and fireplace, door to the kitchen and pvc double glazed patio doors leading through to:

Conservatory

9'8 x 9'4

Central heating radiator, pvc double glazed windows and door leading out to the gardens.

Kitchen

15'8 x 9'10

A range of fitted kitchen units finished in white and including base cupboards

and drawers, plumbing for an automatic washing machine, work tops over with an inset one and a half bowl stainless steel sink unit and mixer tap, larder and matching wall cupboards, Flavel range cooker and extractor fan, pvc double glazed rear window, central heating radiator and pvc double glazed external rear door.

Dining Room/Study

10'6 x 10'1

Pvc double glazed front window and central heating radiator.

Master Bedroom

14'10 (less robes) x 11'1

Pvc double glazed rear window, central heating radiator, fitted wardrobes, dressing table and door to:

En-Suite Bathroom

A panelled bath with shower over, pedestal wash hand basin and close coupled wc, central heating radiator, linen cupboard housing the Worcester gas fired combination boiler.

FIRST FLOOR

Landing

Velux double glazed skylight window and doors leading off to:

Bedroom Two

11'10 x 10'10 (plus robes)

Pvc double glazed side window, central heating radiator and fitted wardrobes with sliding doors.

Bedroom Three

8'10 x 7'6 plus 5'11 x 3'8

Pvc double glazed side window and central heating radiator.

Bathroom

A coloured suite including a panelled bath with electric shower over, pedestal wash hand basin and close coupled wc, central heating radiator and Velux double glazed skylight window.

OUTSIDE

Gardens

A shared gated driveway leads to the property where there is ample parking space, a stone built work shop and garden store, gardens shed and greenhouse, raised patio area and lawn.

Our ref: Cms/cms/0413/26

Note - Anti Money Laundering

To be able to sell or purchase a property in the United Kingdom all agents have a legal requirement to conduct Identity checks on all customers involved in the transaction to fulfil their obligations under Anti Money Laundering regulations. We outsource this check to a third party and a charge will apply. Ask the branch for further details.

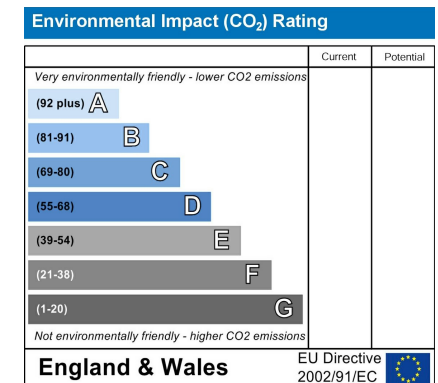
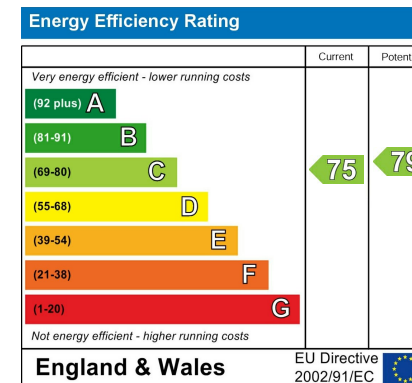



GROUND FLOOR
1153 sq.ft. (107.1 sq.m.) approx.



1ST FLOOR
401 sq.ft. (37.3 sq.m.) approx.

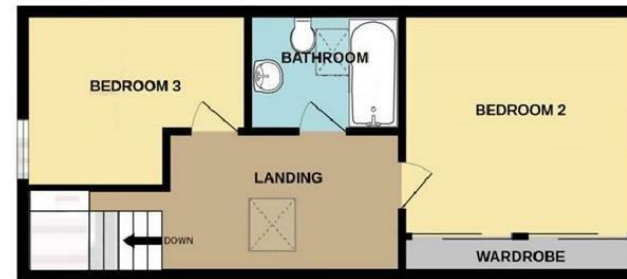

TOTAL FLOOR AREA: 1554 sq.ft. (144.3 sq.m.) approx.

Measurements are approximate. Not to scale. Illustrative purposes only
Made with Metropix ©2025



These particulars are believed to be accurate but they are not guaranteed and do not form a contract. Neither Jordan Fishwick nor the vendor or lessor accept any responsibility in respect of these particulars, which are not intended to be statements or representations of fact and any intending purchaser or lessee must satisfy himself by inspection or otherwise as to the correctness of each of the statements contained in these particulars. Any floorplans on this brochure are for illustrative purposes only and are not necessarily to scale.

Offices at: Chorlton, Didsbury, Disley, Hale, Glossop, Macclesfield, Manchester Deansgate, Manchester Whitworth Street, New Mills, Sale, Wilmslow and Withington

44 High Street West, Glossop, Derbyshire, SK13 8BH

01457 858888

glossop@jordanfishwick.co.uk
www.jordanfishwick.co.uk

