



Northcote Road, SW11

£1,500 Per calendar month

A studio flat located on the popular Northcote Road, offering a spacious studio room and a separate well presented kitchen and bathroom. Perfect for a single professional.

The most friendly high street around, this location gives you great access to Clapham Junction as well as all the local shops, pubs and restaurants on your doorstep.

Features

- Large Studio
- Separate Kitchen
- Perfect Location
- Close to Transport
- Top Floor
- Bright Space

Northcote Road, London, SW11

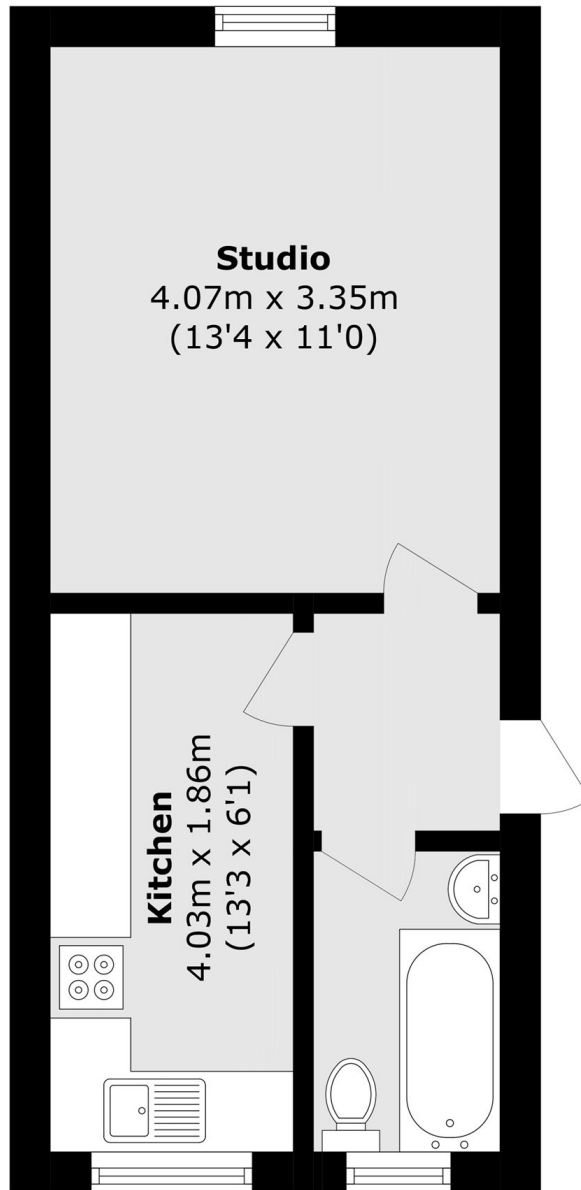

Total area (approx.): 27.5 sq. m (296.0 sq. ft)