



City Road, EC1V

£102,500

A superbly located one bedroom apartment next to City Road Basin. This property is bright throughout, with a large double bedroom, modern bathroom, and an open plan kitchen reception. Please note, this property is currently part-owned by the Housing Association and is offered at a 25% share. Shared Ownership Criteria: applicants must earn sub £100,000 annually, work in London and own no other properties.

Fable Apartments boasts a prime location, nestled equidistance between Upper Street and Old Street. Enjoy the best of both worlds with easy access to the boutique shops and high street chains at Angel, as well as the vibrant bars and restaurants of Shoreditch and Hoxton.

Features

- 25% Share
- Open Plan
- One Bedroom
- Central Location

City Road, London, EC1V

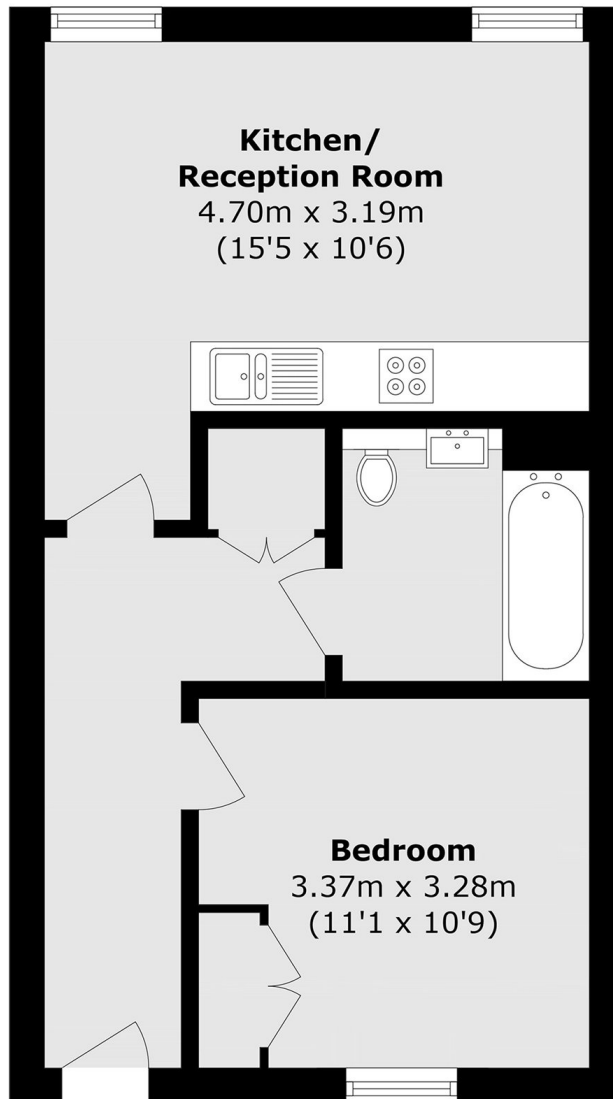

Total area (approx.): 41.6 sq. m (447.8 sq. ft)