



77A, Beeches Road, Rowley Regis, B65 0AS

Offers In The Region Of £220,000

- SEMI DETACHED HOUSE WITH THREE BEDROOMS
 - TWO RECEPTION ROOMS
- SHARED DRIVEWAY FROM FRONT LEADING TO FORMER GARAGE/WORKSHOP TO REAR
 - GOOD SIZED REAR GARDEN
 - NO UPWARD CHAIN

All Buildings Great & Small



RICS
Regulated by RICS

arla naea
propertymark



intertek
ISO 9001:2015



UKAS
MANAGEMENT
SYSTEMS
014

OnTheMarket

rightmove



A three bedroom semi detached house with two reception rooms and former garage/workshop to rear. No upward chain.

Accommodation comprising enclosed porch, entrance hall, lounge, dining room, kitchen, rear lean-to, downstairs WC, landing, three bedrooms, shower room, gas boiler serving radiators, double glazing to some windows as detailed. Rear garden, former garage/workshop to rear.

ENCLOSED PORCH (front)

Double glazed sliding door, tiled floor finish, single glazed front door,

ENTRANCE HALL (inner)

Panel radiator, coving to ceiling, staircase off to first floor landing, door opening onto lounge.

LOUNGE (front) 3.94m (3.34m) x 3.32m plus bay

Double glazed bay window, gas fire with fire surround, dado rail, coving to ceiling, panel radiator, door opening onto dining room.

DINING ROOM (inner/rear) 3.94m max (3.58m) x 3.33m

Panel radiator, multi panel single glazed bow window (timber framed), coving to ceiling, door opening onto downstairs WC.

DOWNSTAIRS WC (side)

Tiled floor finish, WC, wash hand basin with hot and cold taps, towel rail, coat hooks to wall, three walls part tiled, obscure single glazed window to side, shelving, gas boiler.

KITCHEN (rear) 1.99m x 2.46m

Double glazed window onto rear garden, single glazed window onto rear lean-to, base units with cupboards and drawer, single bowl single drainer stainless steel sink with mixer tap, plumbing for washing machine, space for fridge and freezer and cooker, tiling to some walls, storage cupboards at high level.

PANTRY (side)

Shelving, obscure single glazed window to side.

LEAN TO (rear) 2.50m x 2.67m to door

Single glazed double doors onto rear garden, single glazed windows, tiled floor,

Staircase with handrails from ground floor entrance hall leading off to first floor landing.

FIRST FLOOR LANDING (inner/side)

Obscure single glazed window to side, access to roof space, coving to ceiling,

BEDROOM ONE (front) 2.64m (3.01m) x 3.31m plus bay

Panel radiator, single glazed bay window (timber framed), coving to ceiling,

BEDROOM TWO (rear) 2.66m (3.02m) x 3.31m

Double glazed window, panel radiator, coving to ceiling,

BEDROOM THREE (front) 1.83m x 2.05m

Timber framed double glazed window

SHOWER ROOM (rear) 2.20m x 1.70m

Obscure double glazed window to rear, wash hand basin with hot and cold tap, panel radiator, electric shower, shower screen, shower panels, WC with push button flush,

REAR GARDEN

Patio area, pathway to top of garden, lawn, double gates giving access to shared driveway, garden store, former garage/workshop.

FORMER GARAGE/WORKSHOP

5.98m x 5.37m Maximum overall measurements.

AGENTS NOTE - The garage/workshop is accessed via a shared driveway from the front of the property. The driveway has a limited width and may not be suitable for some cars.

COUNCIL TAX BAND B (Sandwell)

TENURE

We are verbally advised the property is freehold. The Agent has not checked the legal documents to verify the freehold status of the property. The buyer is advised to obtain verification from their Solicitor or Surveyor.

SERVICES

The Agents have not tested any apparatus, equipment, fixtures, fittings or services and so cannot verify they are in working order or fit for their purpose. The buyer is advised to obtain verification from their Solicitor or Surveyor.

FIXTURES AND FITTINGS

All items unless specifically referred to in these sales particulars are expressly excluded from the proposed sale. Carpets as fitted are included in the sale, curtains and certain other items may be taken at a valuation to be agreed.

Useful links for property information:

Find information about a property in England or Wales:
<https://search-property-information.service.gov.uk>

Mobile and broadband checker: If mobile coverage and broadband speed is an important issue we would suggest checking with: <https://checker.ofcom.org.uk>

Flooding: If you wish to check flooding information in respect of the property, the following may be of assistance: <https://www.gov.uk/request-flooding-history>

Long term flood risk check of an area in England:
<https://www.gov.uk/check-long-term-flood-risk>

Service provider information: we would suggest the following:

Gas supply:

<https://www.ofgem.gov.uk/information-consumers/energy-advice-households/finding-your-energy-supplier-or-network-operator>

<https://www.findmysupplier.energy>

Electric supply:

<https://www.energynetworks.org/customers/find-my-network-operator>

<https://www.nationalgrid.co.uk>

Water supplier:

<https://www.ofwat.gov.uk/households/your-water-company>

<https://www.water.org.uk/customers/find-your-supplier>

Consumer code for house builders:

<https://consumercode.co.uk>

Money Laundering Regulations –

In order to comply with Money Laundering Regulations, all prospective purchasers are required to provide the following

-

1. Satisfactory photographic identification.
2. Proof of address/residency.
3. Verification of the source of purchase funds including bank statements for deposits in order to purchase and copy of mortgage agreement in principle from the appropriate lender. In the absence of being able to provide appropriate physical copies of the above, Scriven & Co reserves the right to obtain electronic verification of identity.

Extra services -

By law, the agent must tell the client if the agent or any connected person intends to earn any commission or any other fees from offering or referring other services to the client or buyer. If the agent or any connected person earns money from any of these services or referrals the agent or the connected person would keep this commission or fee. Part of the payment for these extra services will be paid to the agent as a result of the referral.

Scriven & Co offers the following services and has the following referral arrangements in place:

Scriven & Co routinely refers sellers (and buyers) to Infinity Financial Advice. It is the clients' or buyers' decision whether to choose to deal with Infinity Financial Advice. Should the client or a buyer decide to use Infinity Financial Advice the client or buyer should know that Scriven & Co

receive a payment from Infinity Financial Advice equating on average to a figure in the order of £200 per referral.

Scriven & Co routinely refers sellers (and buyers) to certain firms of solicitors/conveyancers. It is the clients' or buyers' decision whether to choose to deal with any of the referral companies. Should the client or a buyer decide to use any of these companies the client or buyer should know that Scriven & Co receive a payment from these companies equating to a figure in the order of £100-£200 per referral. We are informed that the solicitors/conveyancers are happy to pay this referral fee to ourselves as it significantly reduces the marketing costs that they have to allocate to sourcing new business. The referral fee is NOT added to the conveyancing charges that would ordinarily be quoted.

The agent routinely refers sellers (and buyers) to a Removals and Storage Company. It is the clients' or buyers' decision whether to choose to deal with the Removals and Storage Company. Should the client or a buyer decide to use the Removals and Storage Company the client or a buyer should know that the agent receives a referral fee to the value of £70 plus VAT from them for recommending a client or buyer to them.

VIEWING

By appointment with Scriven & Co. Residential Sales Department on 0121-422-4011 (option 1).

Important notices

The Consumer Protection from Unfair Trading Regulations 2008 and the Business Protection from Misleading Marketing Regulations 2008 : Nothing concerning the type of construction or the condition of the structure is to be implied from the photograph (or artists impression) of the property. Items shown in photographs are NOT included unless specifically mentioned within the sales particulars. Certain items may however be available by separate negotiation. The measurements supplied are for general guidance, and as such must be considered as incorrect. A buyer is advised to re-check the measurements themselves before committing themselves to any expense. The Agent has not tested any apparatus, equipment, fixtures, fittings or services, and so does not verify they are in working order, fit for their purpose, or within ownership of the sellers, therefore the buyer must assume the information given is incorrect. Neither has the Agent checked the legal documentation to verify legal status of the property or validity of any guarantee. A buyer must assume the information is incorrect, until it has been verified by their own solicitors. The sales particulars may change in the course of time, and any interested party is advised to make final inspection of the property prior to exchange of contracts. A buyer must check the availability of any property and make an appointment to view before embarking on any journey to see a property. References to the Tenure of a Property are based on information supplied by the Seller. The Agent has not had sight of the title documents. A Buyer is advised to obtain verification from their Solicitor. Any reference to alterations to, or use of any part of the property, is not a statement that any necessary planning, building regulation or other consent has been obtained. A buyer must assume the information is incorrect until it has been verified by their own solicitors.

VAT : All figures quoted are exclusive of VAT where applicable. **Rating Assessments** : Where provided the Agent has made a verbal enquiry with the Local Authority and this information should be verified by interested parties making their own enquiries.

Misrepresentation Act 1967 : These details are prepared as a general guide only, and should not be relied upon as a basis to enter into a legal contract, or to commit expenditure. An interested party should consult their own surveyor, solicitor or other professionals before committing themselves to any expenditure or other legal commitments. If any interested party wishes to rely upon any information from the Agent, then a request should be made and specific written confirmation can be provided. The Agent will not be responsible for any verbal statement made by any member of staff, as only a specific written confirmation should be relied upon. The Agent will not be responsible for any loss other than when specific written confirmation has been requested. (REV02:10/13).









Ground Floor

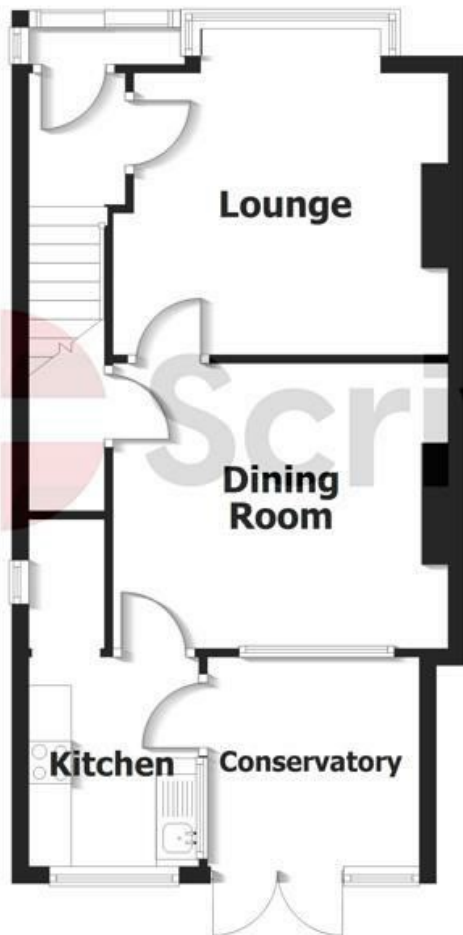

First Floor



- Estate House, 821 Hagley Road West, Quinton, Birmingham, B32 1AD
- Tel: 0121 422 4011
- E-mail: quinton@scriven.co.uk
- www.scriven.co.uk
- Regulated By RICS

| Energy Efficiency Rating | | |
|---|---------|-----------|
| | Current | Potential |
| Very energy efficient - lower running costs | | |
| (92 plus) A | | |
| (81-91) B | | |
| (69-80) C | | 77 |
| (55-68) D | 56 | |
| (39-54) E | | |
| (21-38) F | | |
| (1-20) G | | |
| Not energy efficient - higher running costs | | |
| England & Wales | | |
| EU Directive 2002/91/EC | | |