



21 Hoe Street

The Hoe, Plymouth, PL1 2JA

£148,000



Superbly-presented ground floor apartment situated on a cobbled street within easy reach of the Hoe & Barbican. The accommodation briefly comprises a hallway, living room, kitchen, generous double bedroom & shower room. Use of a rear courtyard area with space for seating. Double-glazing & central heating.



HOE STREET, PLYMOUTH, PL1 2JA

ACCOMMODATION

From the communal entrance hallway, a doorway opens into the hallway.

HALLWAY

Providing access to the accommodation. Generous storage cupboard. Wall-mounted Vaillant gas boiler. Doorway to the side opening to the rear courtyard.

LIVING ROOM 14'4 into bay x 12'7 (4.37m into bay x 3.84m)

Situated to the front. Window with fitted blinds. Chimney breast. Period-style radiator.

KITCHEN 9'6 x 9'5 (2.90m x 2.87m)

Fitted with a range of base and wall-mounted cabinets with matching fascias and tiled splash-backs. Stainless-steel one-&-a-half bowl single drainer sink. Space for free-standing appliances, including cooker, washing machine, fridge-freezer and dishwasher. Window to the side elevation.

BEDROOM 17'2 into bay x 11'6 (5.23m into bay x 3.51m)

Window with fitted blind to the rear elevation. Period-style radiator.

BATHROOM 6'9" x 6'3" (2.06m x 1.93m)

A recently refurbished bathroom with a contemporary suite comprising a bath with a shower over with a spray attachment, rainfall shower head and a glass screen, wall-mounted basin with mixer tap and wc. Tiled walls. Obscured window to the side elevation.

OUTSIDE

Use of a rear courtyard yard with free-standing timber planters, space for seating and an outside tap.

COUNCIL TAX

Plymouth City Council
Council tax band A

AGENT'S NOTE

The 3 flats all own an equal share of the freehold. There are 85 years remaining on the leasehold.

There are no charges for ground rent or service charge. Maintenance is shared equally amongst the 3 flats.

Area Map



Floor Plans

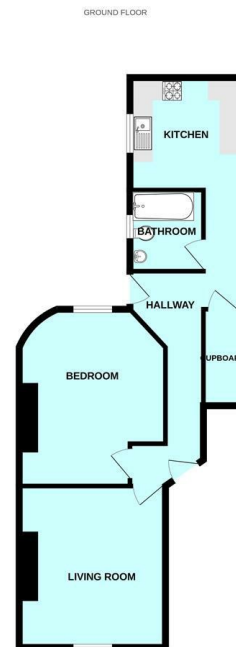

Made with Mapbox CO2E

Energy Efficiency Graph

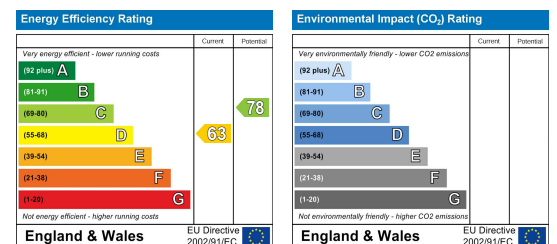

These particulars, whilst believed to be accurate are set out as a general outline only for guidance and do not constitute any part of an offer or contract. Intending purchasers should not rely on them as statements of representation of fact, but must satisfy themselves by inspection or otherwise as to their accuracy. No person in this firm's employment has the authority to make or give any representation or warranty in respect of the property.