



Shepherds Bush Road, W6

£888 Per week

This well presented four bedroom property is located on the top two floors offering a large open plan living space with fully fitted kitchen and direct access to a private roof terrace, four bedrooms and a large family size bathroom.

The property offers easy access to all local amenities of Goldhawk Road and both Shepherds Bush station and Goldhawk Road station are a quarter mile away.

Features

- Four Bedrooms
- Open Plan Living
- Split Level Property
- Private Roof Terrace
- Large Bathroom
- Central Location

Shepherds Bush Road,
London, W6

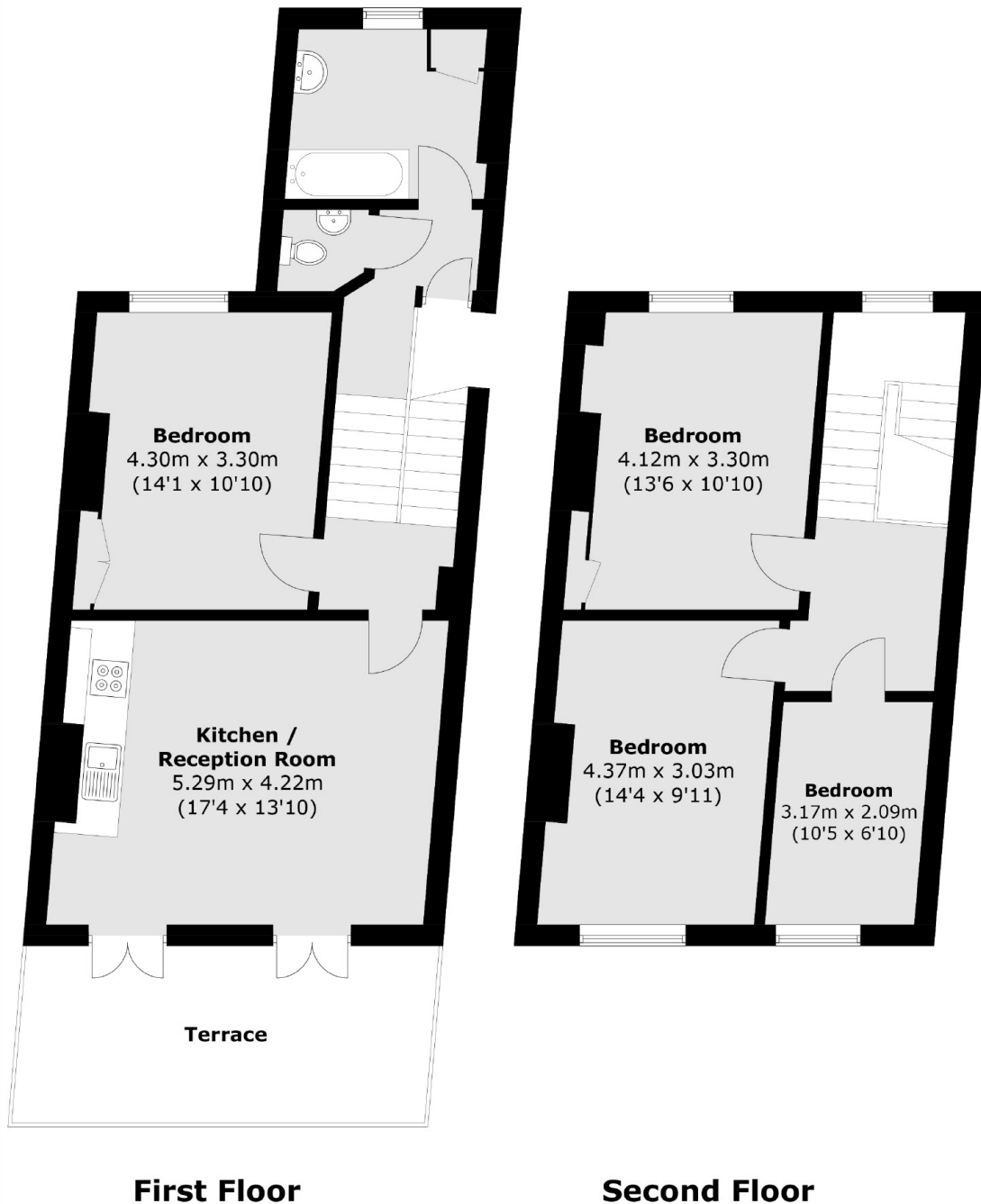

Total area (approx.): 102.4 sq. m (1,102.2 sq. ft)
Terrace : 14.5 sq. m (156.1 sq. ft)