

# Pinewood Green

Buckinghamshire • • SL0 0QQ  
PCM: £1,450 PCM



coopers  
est 1986

A truly lovely TWO BEDROOM first floor maisonette situated in a very quiet location close to Pinewood Studios and within a short drive to Uxbridge town centre and the A40 Motorway. Accommodation; Two bedrooms, Lounge, Modern bathroom, Fitted kitchen with appliances. Benefits; Double glazing, Gas central heating, Private garden. UNFURNISHED.

Two Bedrooms

First Floor

Council Tax Band D

Stones Throw from Pinewood Studios

Local Amenities

Fully Fitted Kitchen with Appliances

Garden

Close to Uxbridge Town Centre

Unfurnished

Easy Access to M40/M25

**Available Date**

12th June 2026

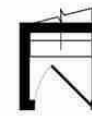

GROUND FLOOR  
APPROX. FLOOR  
AREA 13 SQ.FT.  
(1.2 SQ.M.)

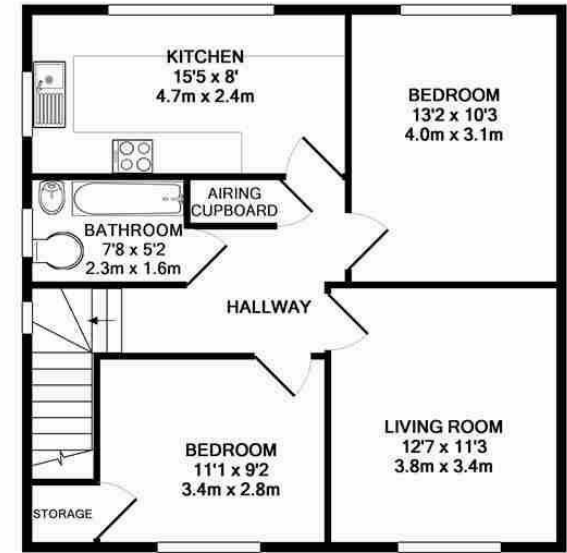

1ST FLOOR  
APPROX. FLOOR  
AREA 661 SQ.FT.  
(61.4 SQ.M.)

TOTAL APPROX. FLOOR AREA 674 SQ.FT. (62.6 SQ.M.)

Whilst every attempt has been made to ensure the accuracy of the floor plan contained here, measurements of doors, windows, rooms and any other items are approximate and no responsibility is taken for any error, omission, or mis-statement. This plan is for illustrative purposes only and should be used as such by any prospective purchaser. The services, systems and appliances shown have not been tested and no guarantee as to their operability or efficiency can be given.  
Made with Metropix ©2014



**01895 257 566**

**1 Vine Street, Uxbridge,  
Middlesex, UB8 1QE**

propertymanagement@coopersresidential.co.uk

**CoopersResidential.co.uk**

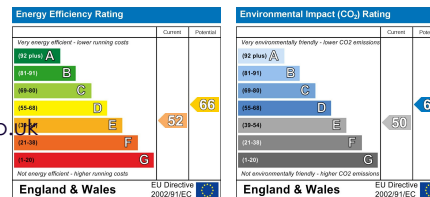

Important Notice: These particulars, whilst believed to be accurate are set out as a general outline only for guidance and do not constitute any part of an offer or contract. Intending purchasers should not rely on them as statements or representation of fact, but must satisfy themselves by inspection or otherwise has the authority to make or give any representation or warranty in respect of the property.

**coopers**  
est 1986