

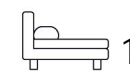

Living
made
better

The Oxygen
Royal Victoria Dock, E16 1BH



Asking Price £305,000

The Oxygen, Royal Victoria Dock, E16 1BH

Madison Brook

Property Summary

A well-presented and spacious one bedroom ground floor apartment within the popular Oxygen Apartments, offering approximately 627 sq.ft. of modern living space. The property features a bright open-plan reception/kitchen with integrated appliances, a generous double bedroom, and a contemporary bathroom, all finished to a good standard throughout. Offered chain free. Conveniently located close to the Royal Victoria Dock, DLR and Elizabeth Line, providing excellent access to Canary Wharf, the City and beyond.

Service Charge: TBC | Ground Rent: £100 pa | Lease Remaining: 106 years

Floorplan

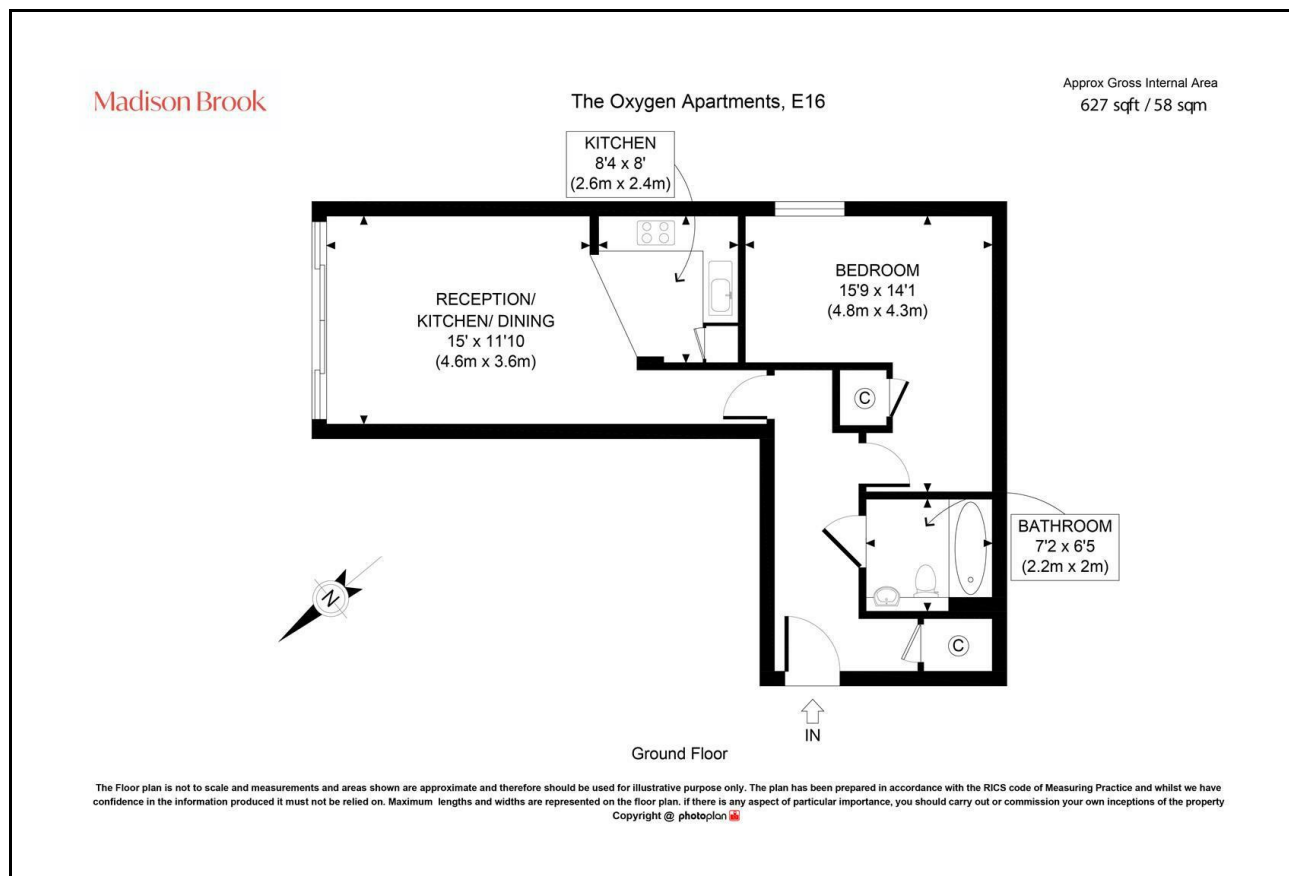

Area Map

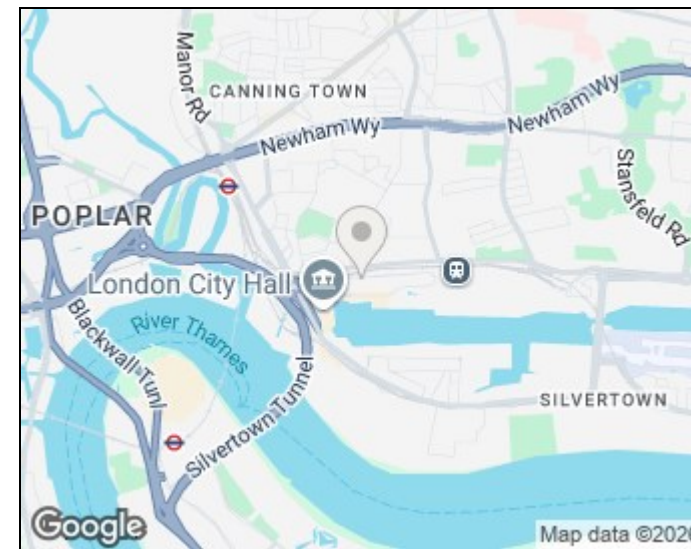

Energy Efficiency Graph

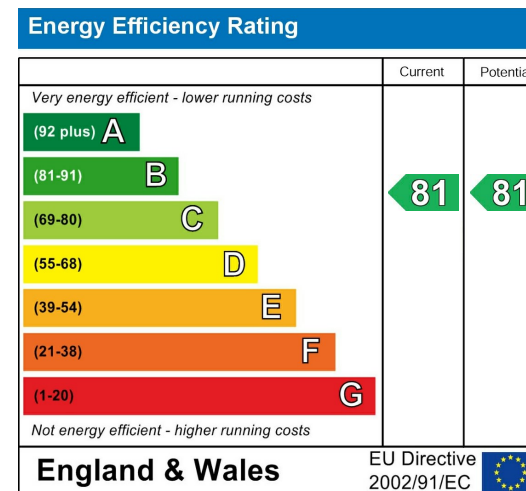

These particulars, whilst believed to be accurate are set out as a general outline only for guidance and do not constitute any part of an offer or contract. Intending purchasers should not rely on them as statements of representation of fact, but must satisfy themselves by inspection or otherwise as to their accuracy. No person in this firm's employment has the authority to make or give any representation or warranty in respect of the property.

Unit B 20 Western Gateway, Royal Victoria
Dock, London, E16 1BS
Tel: 020 3946 6000 Email:
docklands@madisonbrook.com
<https://madisonbrook.com/>