



## Acre Road, KT2

### £249,950

A superb one bedroom, ground floor flat located in a popular location close to Kingston town centre. Offered with no onward chain and a brand new lease on completion, this would make a fantastic investment purchase or first home.

Acre Road is a popular residential road, perfectly located for Kingston town centre, a short distance from Richmond Park, local outstanding schools, and Kingston Railway Station.

### Features

- Large Double Bedroom
- Ground Floor
- Communal Gardens
- New Lease On Completion
- No Onward Chain
- Good Condition

**Acre Road,  
Kingston Upon Thames, KT2**

**Ground Floor**

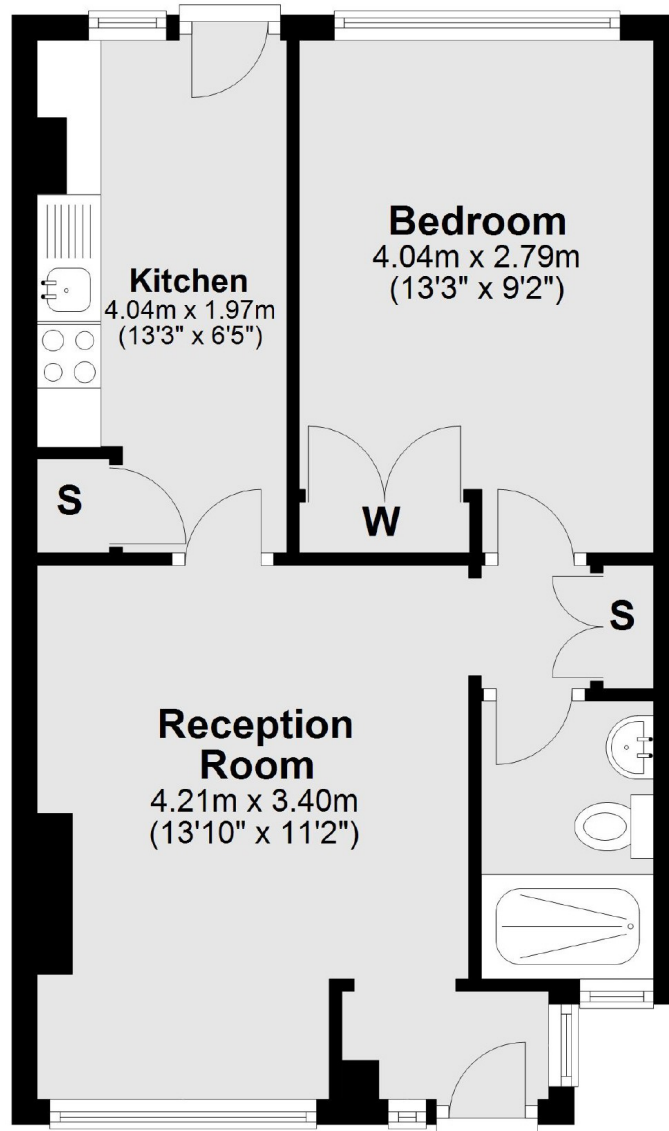

Total area: approx. 39.8 sq. metres (428.3 sq. feet)