



Willow Hall

Willow Road, Hampstead NW3

Asking Price £525,000

A bright and very well presented one double bedroom top floor flat comprising 572 square feet and situated in a quiet location close to Hampstead Village.

Willow Hall is located just 0.2 miles from Hampstead Underground (Northern Line) and the varied amenities, cafes & restaurants that Hampstead Village provides. The open acres of Hampstead Heath are located just 0.1 miles away. Sole Agent.

EPC instructed.

CHESTERTONS



Willow Hall

Willow Road, Hampstead NW3

- One double bedroom top floor flat
- Built in wardrobes
- 572 square feet
- Communal garden
- 0.2 miles to Hampstead Underground
- 0.1 miles to Hampstead Heath



Tenure: Leasehold 99 years 11 months remaining as of 28.4.2026.

Service Charge: £2,500 per annum

Ground Rent: £10 per annum.

Local Authority: Camden

Council Tax Band: D

Chestertons Hampstead Sales

55-56 Hampstead High Street

Hampstead

NW3 1QH

hampstead@chestertons.co.uk

020 7794 3311

chestertons.co.uk

Willow Hall,
Willow Road,
Hampstead Village, NW3



○ - Ceiling Height

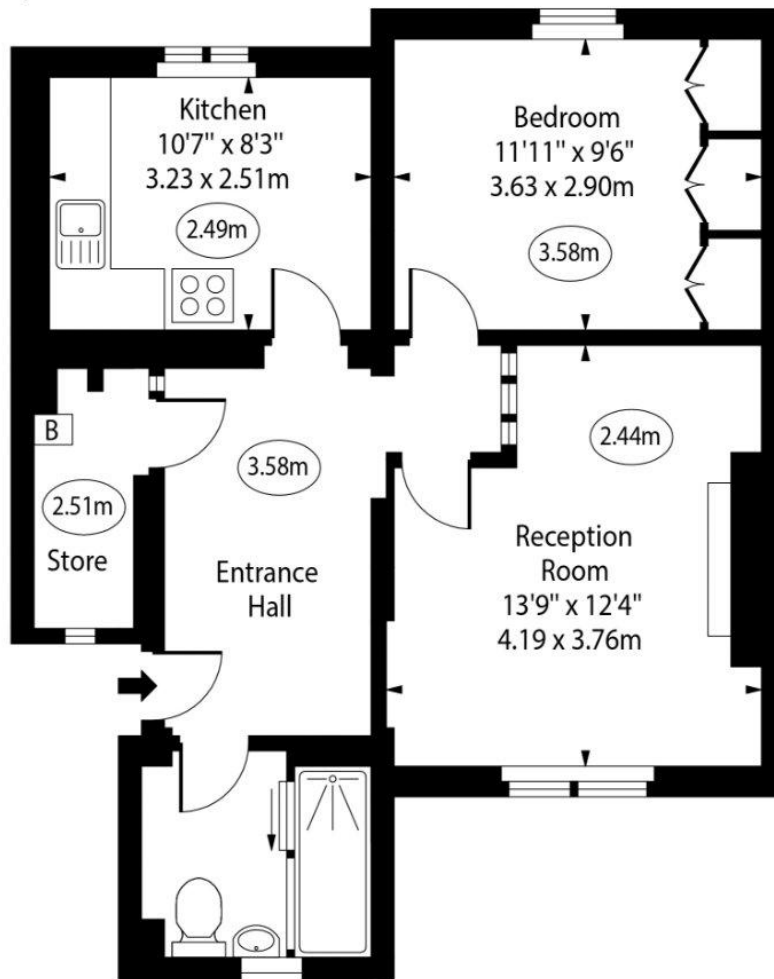

Second Floor

Approx Gross Internal Area 572 Sq Ft - 53.14 Sq M

Every attempt has been made to ensure the accuracy of the floor plan shown. However, all measurements, fixtures, fittings, and data shown are approximate interpretations and for illustrative purposes only. Measured according to the RICS. Not To Scale.

www.goldlens.co.uk
Prepared for Chestertons
Ref. No. 031501M

