



Norfolk Street, Wimblington March  
**£210,000 - £220,000 Freehold**

**Sharman  
Quinney**

# Key Features



- No Onward Chain
- 150ft Rear Garden
- Walking Distance to Local Amenities
- Lovely Family Home
- Sought After Village Location

## Ground Floor

### Lounge/Diner -

Window to front and rear, hard flooring and feature fireplace in Dining Area. The rooms are separated by a large archway so could be used as two separate spaces for combined. Access into the kitchen and understairs storage.

### Kitchen -

Window to side and French doors to rear overlooking the garden. Having been recently fitted, this modern kitchen offers a range of base and wall units in a shaker style with stylish rose gold hardware, integrated appliances including butler style sink, eye level double oven, gas range and space for fridge/freezer, washing machine and tumble dryer.



## First Floor

### Bedroom One -

Original hard flooring, window to front and built in wardrobe.

### Bedroom Three -

Fitted carpet, window to rear overlooking gardens.

### Bathroom -

Hard flooring and tiled walls. A modern three-piece suite comprising of panelled bath with overhead shower, pedestal sink and low-rise WC.

## Second Floor

### Bedroom Two -

Fitted carpet, eaves storage and window to rear.

### Outside -

The front of the property has artificial grass for low maintenance and is walled off from the pavement and accessed via a gate with a stone path leading to the front door.

The generous rear garden measuring at an impressive 150ft is completely private and is laid to lawn and is decorated with various trees and shrubs. There is a patio area for entertaining and raised planters.



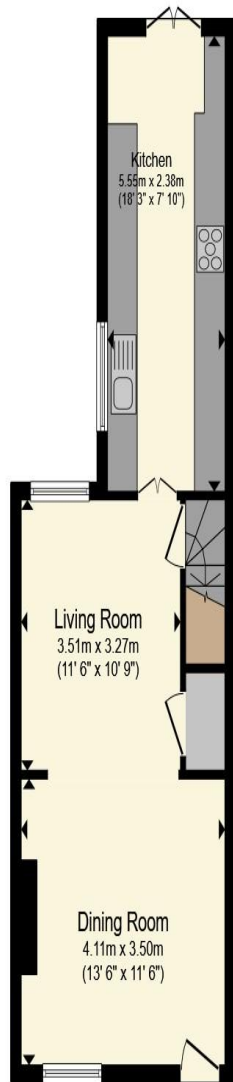

**Ground Floor**



**First Floor**

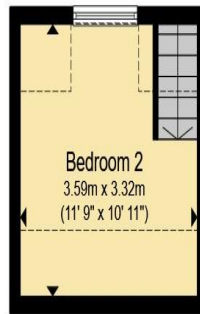

**Second Floor**

Total floor area 82.3 m<sup>2</sup> (886 sq.ft.) approx

This floor plan is for illustrative purposes only. It is not drawn to scale. Any measurements, floor areas (including any total floor area), openings and orientation are approximate. No details are guaranteed, they cannot be relied upon for any purpose and they do not form part of any agreement. No liability is taken for any error, omission or misstatement. A party must rely upon its own inspection(s). Powered by [www.propertybox.io](http://www.propertybox.io)

**Sharman  
Quinney**

To view this property call Sharman Quinney on:  
**01354 661166**

# Selling your property?

Contact us to arrange a **FREE** home valuation.

 01354 661166

 8 Broad Street, MARCH, Cambridgeshire, PE15 8TG

 march@sharmanquinney.co.uk

 [www.sharmanquinney.co.uk](http://www.sharmanquinney.co.uk)



 SCAN ME



Sharman Quinney Holdings Limited is registered in England and Wales under company number 4174227, Registered Office is Cumbria House, 16-20 Hockliffe Street, Leighton Buzzard, Bedfordshire, LU7 1GN. VAT Registration Number is 500 2481 05.

1: These particulars do not constitute part or all of an offer or contract. 2: The measurements indicated are supplied for guidance only and as such must be considered incorrect. 3: Potential buyers are advised to recheck the measurements before committing to any expense. 4: Sharman Quinney has not tested any apparatus, equipment, fixtures, fittings or services and it is the buyers interests to check the working condition of any appliances. 5: Sharman Quinney has not sought to verify the legal title of the property and buyers must obtain verification from their legal representative. 6: Intending purchasers will be asked to produce identification documentation at a later stage and we would ask your co-operation in order that there will be no delay in agreeing the sale. Ref: MRC207069 - 0002

