



MAIDENSTONE HILL, SE10

£3,250 per month



ABOUT THE PROPERTY

A beautiful grade 2 listed, late georgian house in a popular residential street of West Greenwich.



STEP INSIDE MAIDENSTONE HILL

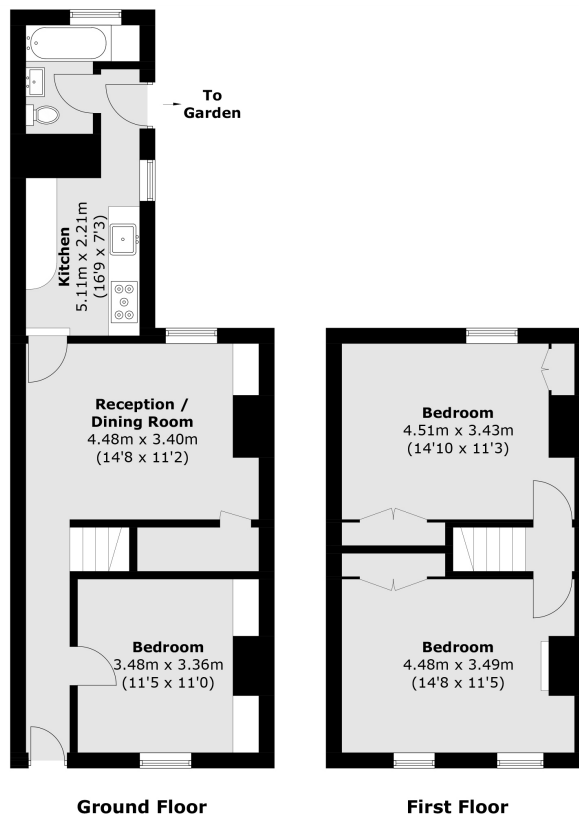

Total area (approx.): 84.8 sq. m (912.8 sq. ft)

Greenwich
020 8815 2230

Energy Rating: F We aim to make our particulars both accurate and reliable. However, they are not guaranteed; nor do they form part of an offer or contract. If you require clarification on any points then please contact us, especially if you're traveling some distance to view. Please note that appliances and heating systems have not been tested and therefore no warranties can be given as to their good working order

**MARSH &
PARSONS**