



Guide Price
£260,000

Freehold

2x  1x  1x 

**Vincent Road,
Sittingbourne, Kent,
ME10**

OVER 60?

Secure this property
for up to **59% less!**

Wards
Helping you move forwards



Main features

- Terraced house with garage and driveway
- Newly landscaped rear garden
- Close to local schools, shops and amenities
- Neutral decor; perfect to add your own stamp to this home
- Ideal for first time buyers and investors alike

Accommodation

GROUND FLOOR

Porch

Lounge: 15'4 x 12'2 (4.68m x 3.71m)

Kitchen: 12'3 x 8'7 (3.74m x 2.62m)

FIRST FLOOR

Landing

Bedroom 1: 13'0 x 6'1 (3.97m x 1.86m)

Bedroom 2: 12'3 x 8'9 (3.74m x 2.67m)

Bathroom

OUTSIDE

Driveway

Garage en-bloc

Rear Garden

Ground Floor

Approx. 30.3 sq. metres (325.6 sq. feet)

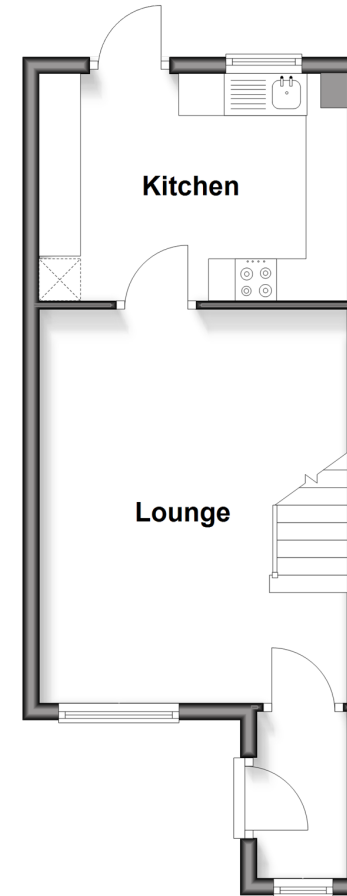

First Floor

Approx. 29.8 sq. metres (320.5 sq. feet)

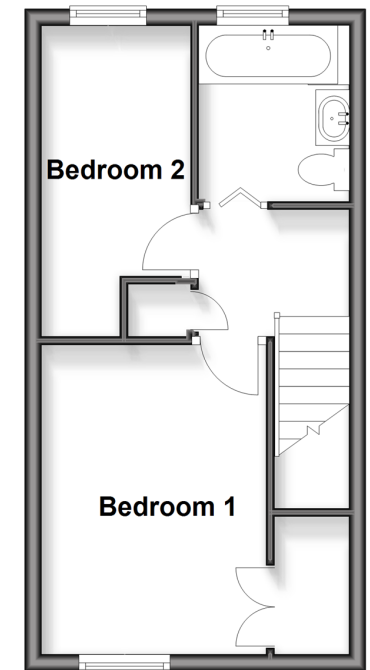

Call Sittingbourne - 01795 427272 ■ wardsof Kent.co.uk

- Legal advice should be taken to verify fixtures/fittings, planning, alterations and/or lease details
- Appliances & services are untested, dimensions are approximate and floor plans are not to scale
- Through a Homewise Home For Life Plan people aged 60+ can secure this property for up to 50% less, by purchasing a Lifetime Lease.



11724747/20251111/JS/MC1